



Ensor Close, Swadlincote, Derbyshire



2



1



1

£180,000



Key Features

- Modern End Town House
- Two Bedrooms
- Head Of Cul De Sac Position
- Upvc Double Glazing & Gas Fired Central Heating
- Popular Residential Development
- Immediate Vacant Possession
- EPC rating C
- Freehold





Situated in this quite cul de sac position this modern two bedroomed end town house is worthy of an internal inspection in order to appreciate the accommodation on offer. The centrally heated and double glazed home comprises in brief: - open canopied entrance and store, entrance hall with guest cloaks off, fitted kitchen, good sized lounge diner and on the first floor a landing leads to two good sized bedrooms and bathroom. Outside to the rear is a pleasant enclosed garden well screened by timber fencing and featuring patio and lawned areas and to the side of the property is a driveway providing parking for two vehicles.



Accommodation In Detail

Open Canopied Entrance

having useful store and half obscure double glazed entrance door leading to:

Entrance Hall

having coving to ceiling, smoke alarm and understairs storage cupboard.

Guest Cloak Room

having low level wc, corner wash basin, one central heating radiator, extractor vent and coving to ceiling.

Kitchen 1.97m x 2.46m (6'6" x 8'1")

having a good range of grey fronted base and eye level units with complementary rolled edged working surfaces, four ring gas hob with electric oven under and extractor over, stainless steel sink and draining unit, Upvc double glazed window to front elevation and ceramic tiling to floor.

Large Lounge Diner 4.56m x 3.92m (15'0" x 12'11")

having open plan staircase rising to first floor, two central heating radiators and Upvc double glazed French doors opening out to the rear garden.



On The First Floor

Landing

having access to loft space.

Bedroom One

2.47m x 3.3m extending to 3.93m

having twin Upvc double glazed windows to front elevation, one central heating radiator, coving to ceiling and two large built-in wardrobes.

Bedroom Two 2.5m x 3.94m (8'2" x 12'11")

having Upvc double glazed window to rear elevation, one central heating radiator and useful overstairs airing cupboard.

Bathroom

having white suite comprising panelled bath with thermostatically controlled shower over, pedestal wash basin, low level wc, one central heating radiator and obscure Upvc double glazed window to side elevation.

Outside

To the rear of the property is a good sized enclosed garden screened by timber fencing and featuring a patio area, lawned area and has external power. A driveway to the side provides parking for two vehicles.

GROUND FLOOR
296 sq.ft. (27.5 sq.m.) approx.

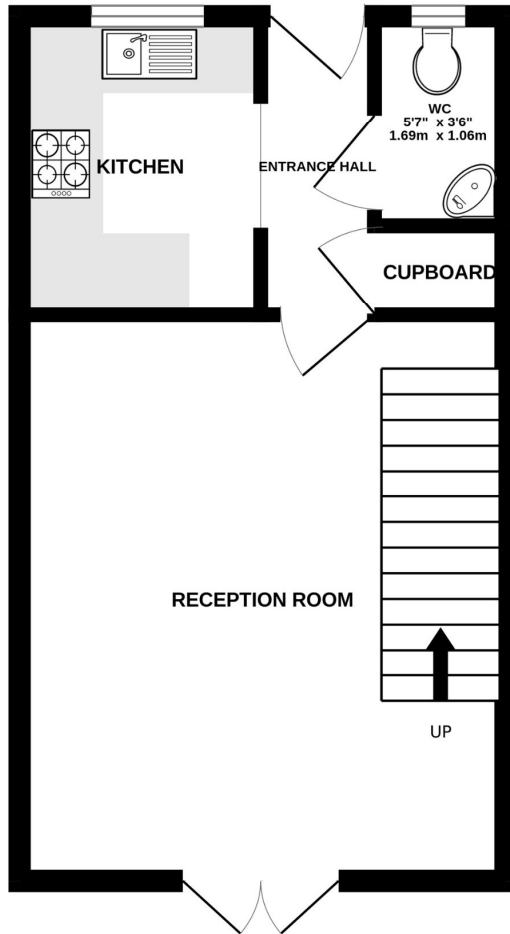

1ST FLOOR
296 sq.ft. (27.5 sq.m.) approx.

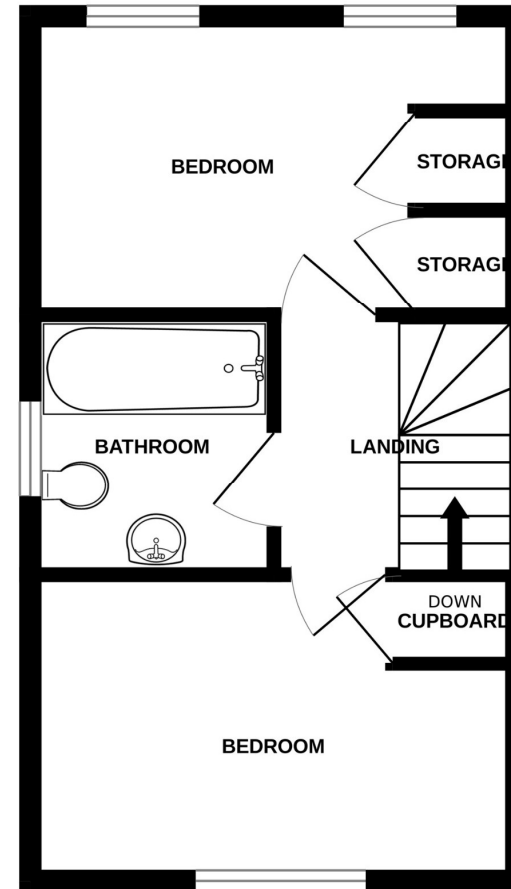

TOTAL FLOOR AREA : 591 sq.ft. (54.9 sq.m.) approx.

Whilst every attempt has been made to ensure the accuracy of the floorplan contained here, measurements of doors, windows, rooms and any other items are approximate and no responsibility is taken for any error, omission or mis-statement. This plan is for illustrative purposes only and should be used as such by any prospective purchaser. The services, systems and appliances shown have not been tested and no guarantee as to their operability or efficiency can be given.
Made with Metropix ©2026

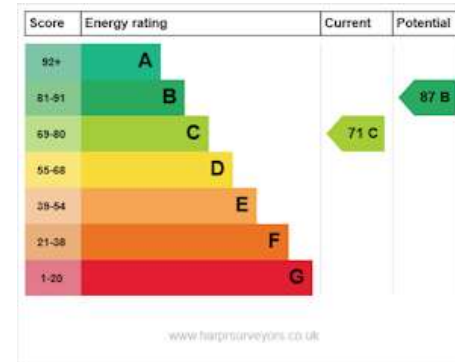
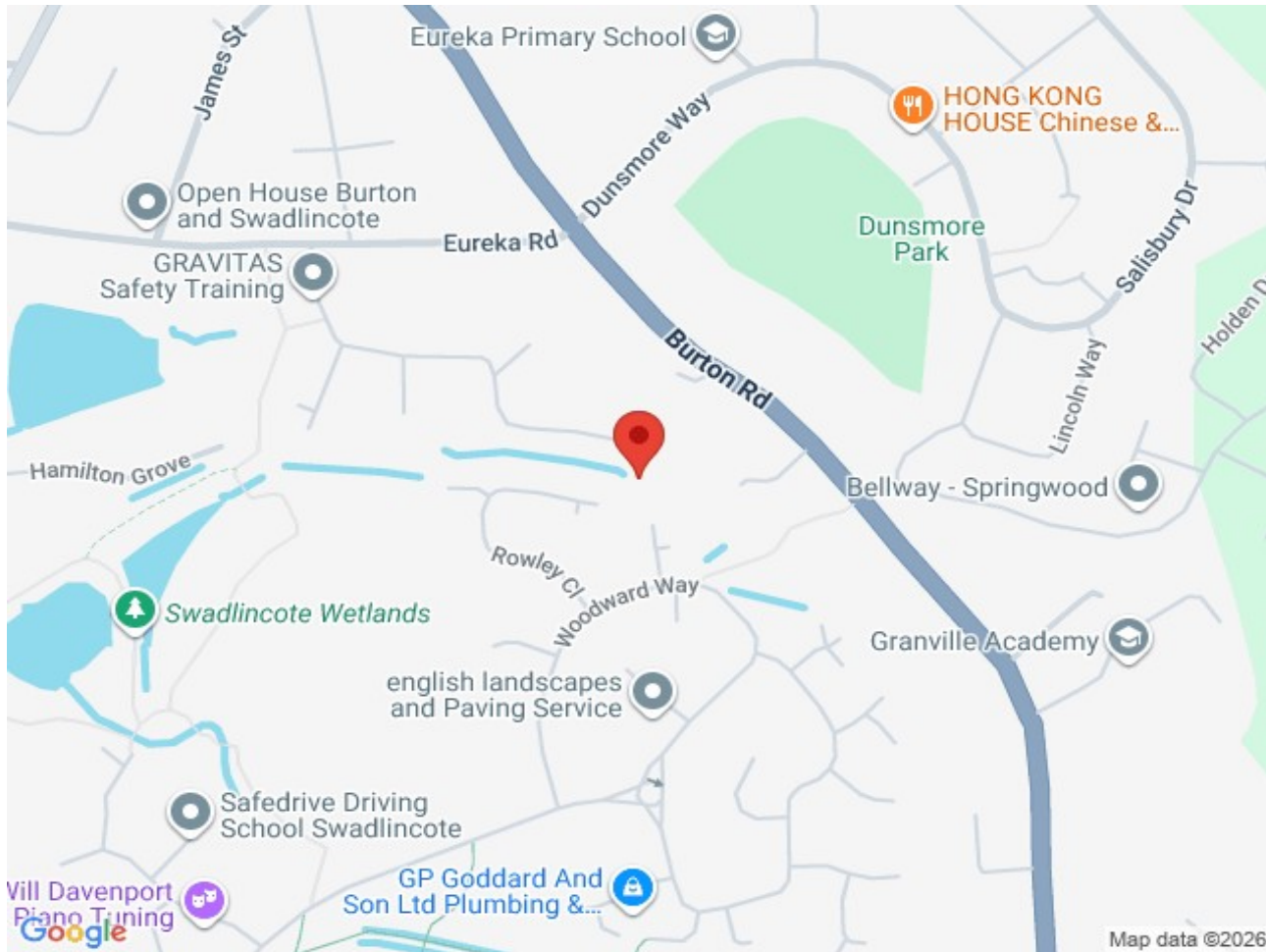

Services

All mains services are believed to be connected to the property.

Measurement

The approximate room sizes are quoted in metric. The imperial equivalent is included in brackets.

Tenure

Freehold - with vacant possession upon completion. Newton Fallowell recommend that purchasers satisfy themselves as to the tenure of the property and we would recommend that they consult a legal representative such as a Solicitor appointed in their purchase.

Note

The services, systems and appliances listed in this specification have not been tested by Newton Fallowell and no guarantee as to their operating ability or their efficiency can be given.

Anti-Money Laundering Regulations – Intending purchasers will be required to provide identification documents via our compliance provider, Coadjute, at a cost of £45 plus VAT per transaction. This will need to be actioned at the offer stage and we would ask for your co-operation in order that there will be no delay in agreeing the sale.

