



16 Maple Grove

Conisbrough, Doncaster, DN12 2LH

£130,000



A well-presented three bedroom semi detached home in a highly sought after location close to amenities, well-regarded schools and excellent transport links.

This spacious property offers well-balanced accommodation throughout, featuring two generous reception rooms and a fitted kitchen, making it ideal for families and first-time buyers alike.

Externally, the home benefits from a driveway providing off-road parking, a front garden, and a delightful rear garden backing onto open fields/parkland offering a pleasant outlook and a good degree of privacy.



GROUND FLOOR
PORCH
ENTRANCE HALL
LOUNGE
DINING KITCHEN
FIRST FLOOR
LANDING
BEDROOM ONE
BEDROOM TWO
BEDROOM THREE
BATHROOM
OUTSIDE

Area Map



Floor Plans

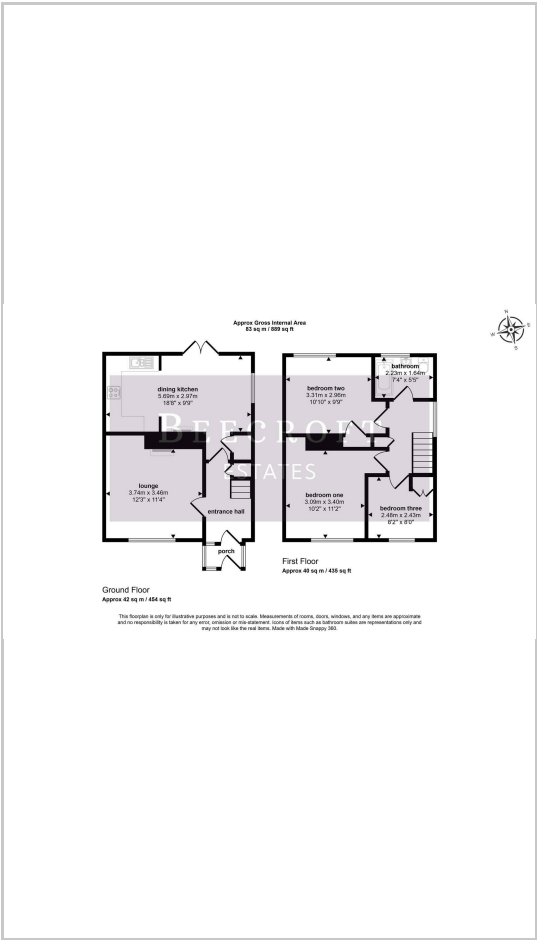

Energy Efficiency Graph



These particulars, whilst believed to be accurate are set out as a general outline only for guidance and do not constitute any part of an offer or contract. Intending purchasers should not rely on them as statements of representation of fact, but must satisfy themselves by inspection or otherwise as to their accuracy. No person in this firms employment has the authority to make or give any representation or warranty in respect of the property.