

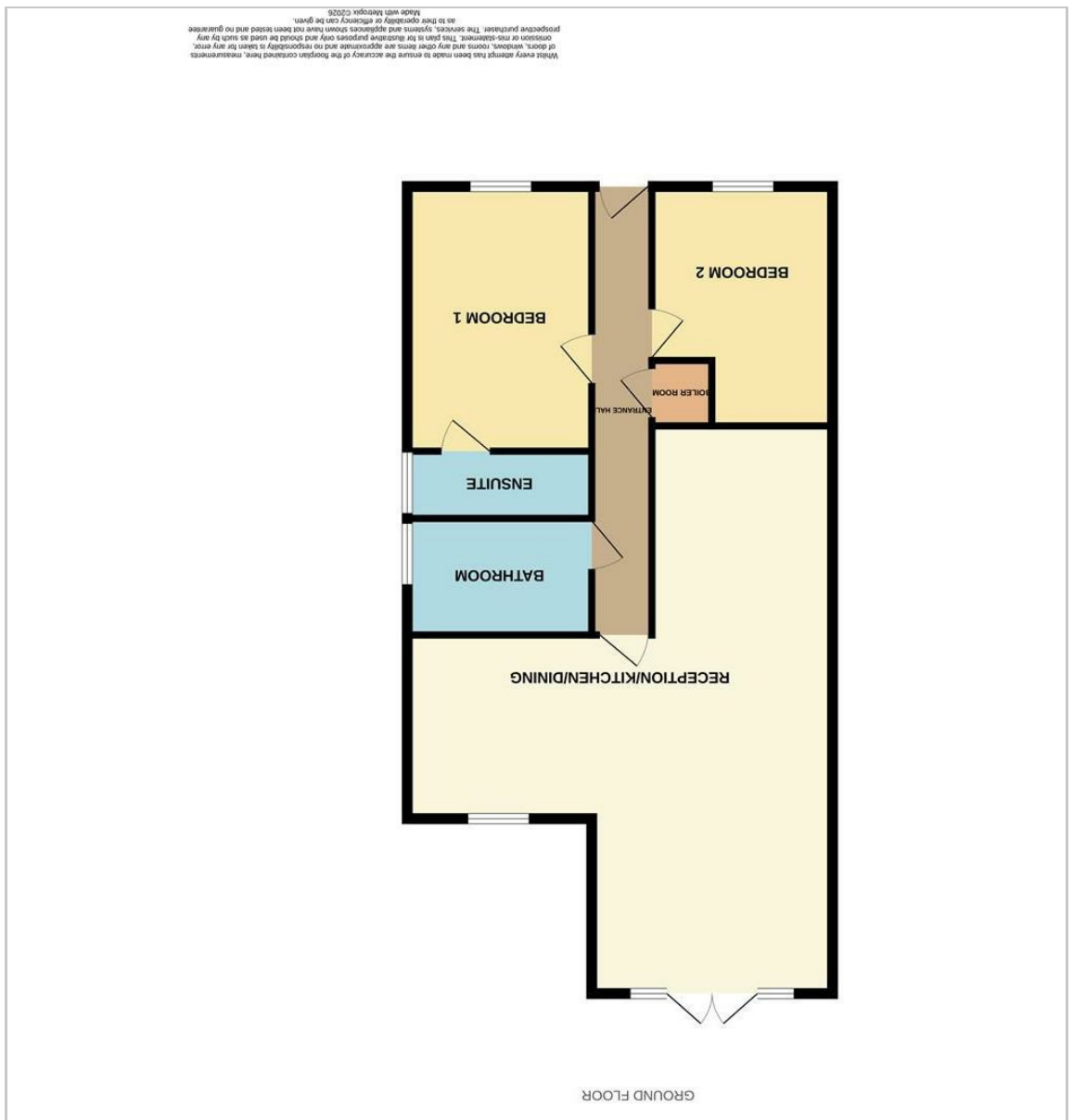

NEW BUILD 32B Princes Avenue
 Minster, SHEERNESS, ME12 2HJ
Asking price £375,000

2 2 1

Floor Plan



Area Map

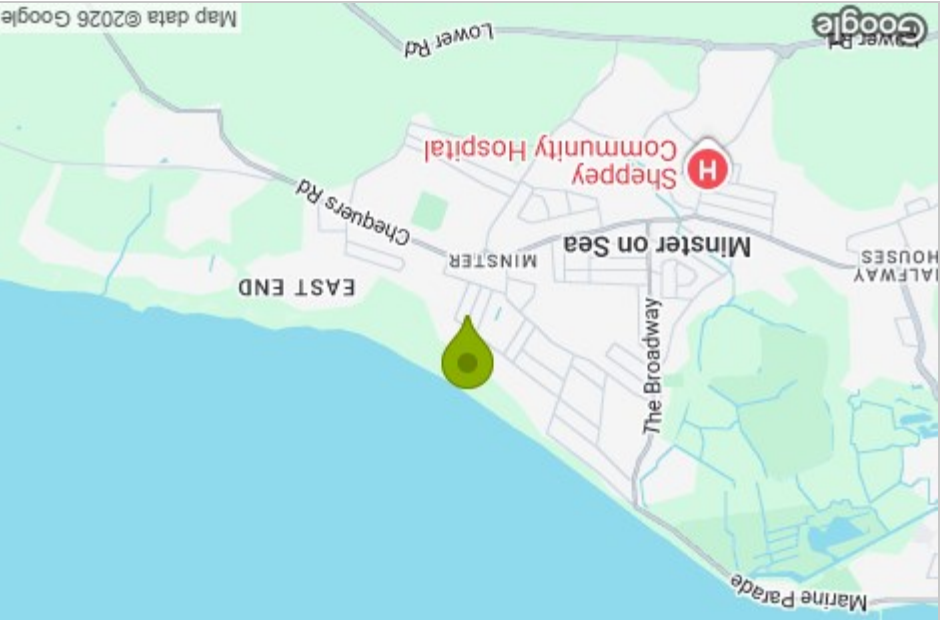

Energy Efficiency Graph

Energy Efficiency Rating	
Current	Potential
G	A
F	B
F	C
F	D
F	E
F	F
F	G

Environmental Impact (CO ₂) Rating	
Current	Potential
G	A
G	B
G	C
G	D
G	E
G	F
G	G

Viewing

Please contact our Isle of Sheppey Office on 01795 666 666 if you wish to arrange a viewing appointment for this property or require further information.

NEW BUILD 32B Princes Avenue



- Brand New Build 2 Bedroom Detached Bungalow
- Rear Garden Turf And Bedrooms Carpets Included
- Electric Car Charging Port
- Quiet Seaside Location And Stone Throw To Beach
- Solar Panelling
- Large Open Plan Living Space
- Master Bedroom With Ensuite
- Large Driveway For 3/4 Cars
- Short Walk To Village Amenities
- Integrated Appliances

Description

£375,000

Welcome to this stunning brand new build, a delightful two-bedroom detached bungalow located at 32B Princes Avenue in the charming village of Minster, Sheerness. This property offers a perfect blend of modern living and coastal tranquillity, making it an ideal home for those seeking a peaceful lifestyle by the sea.

As you step inside, you will be greeted by a spacious open-plan living area that is designed for both comfort and functionality. The large living space is perfect for entertaining guests or enjoying quiet evenings at home. The kitchen is equipped with integrated appliances, ensuring that you have everything you need at your fingertips.

The master bedroom boasts an ensuite bathroom, providing a private retreat for relaxation. The second bedroom is also generously sized, making it suitable for guests, family, or even a home office. Throughout the bungalow, you will find modern finishes that enhance the overall aesthetic and create a welcoming atmosphere.

Outside, the property features a large driveway that can accommodate three to four cars, making it convenient for families or those who enjoy hosting visitors. Additionally, the electric car charging port is a thoughtful touch for eco-conscious homeowners. The bungalow is equipped with solar panelling, promoting energy efficiency and sustainability.

Situated in a quiet seaside location, this home is just a short walk from local village amenities, including shops, cafes, and parks. This combination of modern living and convenient access to essential services makes this property a rare find.

In summary, this two-bedroom detached bungalow is a perfect opportunity for anyone looking to embrace a modern lifestyle in a serene coastal setting. Don't miss your chance to make this beautiful home your own.

AI-generated landscaping has been added for illustrative purposes to show how the garden could look with a finished lawn instead of the current soil area, helping buyers visualise its potential.

Minster, SHEERNESS, ME12 2HJ

