



NEWTON AVENUE, W3

£550,000

Two bedrooms
Recently renovated
Private garden
Long lease
Period property
Energy rating: c

@marshandparsons
marshandparsons.co.uk

MARSH &
PARSONS



ABOUT THE PROPERTY

This immaculate refurbished ground-floor maisonette features two double bedrooms, private front and rear gardens, a long lease, and is offered to the market with no onward chain.

This property is situated just off Acton Gardens on a nice residential street. The local amenities include Acton High Street and Turnham green terrace where there are a multitude of shops, Restaurants, cafes, pubs and bars. Transport links include South Acton station (Overground) Acton Mainline (Crossrail & Main line Rail) Acton Town (District and Piccadilly). There are also a number of good primary schools close by. (Ark Byron & Acton Gardens).



STEP INSIDE NEWTON AVENUE

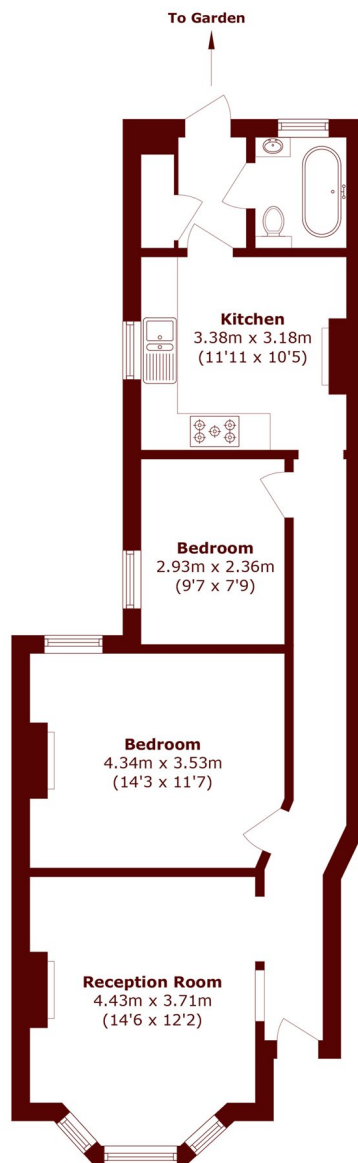

Total area (approx.): 65.9 sq. m (709.3 sq. ft)

Chiswick
020 8994 2556

Energy Rating: C We aim to make our particulars both accurate and reliable. However, they are not guaranteed; nor do they form part of an offer or contract. If you require clarification on any points then please contact us, especially if you're traveling some distance to view. Please note that appliances and heating systems have not been tested and therefore no warranties can be given as to their good working order

MARSH &
PARSONS