



CARVERS

SALES & LETTINGS

Henson Grove

Newton Aycliffe, DL5 4NJ

Offers in the region of £315,000

Bungalow - Detached



3

2

2

A deceptively spacious detached bungalow enjoying a prime location close to local amenities.

Upon entering, you are greeted by a welcoming hallway that leads to a generously proportioned living room, seamlessly connecting to a dining area, ideal for entertaining family and friends. The fitted kitchen is practical and functional, complemented by a utility room that includes a convenient WC and a sauna, providing a touch of luxury to your daily routine.

This delightful bungalow features three well-sized bedrooms, including a principal bedroom with its own en-suite bathroom/WC, ensuring privacy and comfort. The family bathroom/WC is thoughtfully designed, complete with a separate corner shower cubicle, catering to the needs of a busy household.

Outside, the property boasts a driveway that accommodates up to four vehicles, along with a detached garage for additional storage. The enclosed gardens are a true highlight, offering a peaceful retreat with a good degree of privacy, perfect for enjoying the outdoors.

With gas central heating to radiators and uPVC double glazing throughout, this home is both warm and energy-efficient. Its central location is a significant advantage, placing you within easy reach of local amenities, making daily life convenient and enjoyable.

This bungalow is an excellent opportunity for those seeking a spacious and well-appointed home in a popular area. Don't miss the chance to make this lovely property your own.



- Detached
- Fitted kitchen
- Principal bedroom with en-suite
- Family bathroom/WC with separate corner shower cubicle
- Enclosed gardens
- Extremely well proportioned living room opening to dining room
- Utility room with WC and sauna
- Two further good size bedrooms
- Driveway leading to detached garage
- Popular cul-de-sac close to local amenities

Agents Notes

Tenure:- Freehold

Mains gas, (central heating to radiators), electricity & drainage

uPVC double glazing throughout

Council Tax:- Band C

Local Authority:- Durham County Council

Buyer(s) Identification Checks

Should a purchaser(s) have an offer accepted on a property marketed by Carvers they will need to undertake an identification check. This is done to meet our obligation under Anti Money Laundering Regulations (AML) and is a legal requirement. We use a specialist third party service to verify your identity, this is not a credit check and will have no effect on credit history. The cost of these checks is £36 inc. VAT per buyer, which is paid in advance, when an offer is agreed and prior to a sales memorandum being issued. This charge is non-refundable.

Property Size

Please note the property size is taken from the Energy Performance Certificate and may not take into account all rooms from the floorplan (due to unheated space not being calculated e.g. conservatory and/or garage)



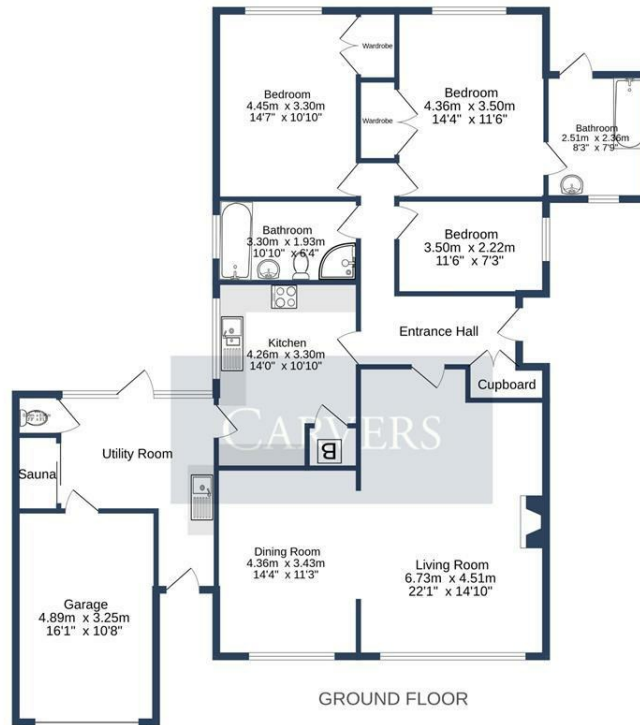

HENSON GROVE, NEWTON AYCLIFFE, DL5 4NJ.

Whilst every attempt has been made to ensure the accuracy of the floorplan contained here, measurements of doors, windows, rooms and any other items are approximate and no responsibility is taken for any error, omission or mis-statement. This plan is for illustrative purposes only and should be used as such by any prospective purchaser. The services, systems and appliances shown have not been tested and no guarantee as to their operability or efficiency can be given.
Made with Metagon ©2020

Energy Efficiency Rating		
Very energy efficient - lower running costs	Current	Potential
(92 plus) A		
(81-91) B		
(69-80) C		
(55-68) D	63	71
(39-54) E		
(21-38) F		
(1-20) G		
<small>Not energy efficient - higher running costs</small>		
England & Wales	EU Directive 2002/91/EC	

Property size taken from EPC
1184.00 sq ft

Searching 1,000s of mortgages
Access to 12,000+ products from 90+ lenders across the UK.
Call: 01325 370341 Visit: Any of our offices
Web: mortgageadvicebureau.com/carvers

Your home may be repossessed if you do not keep up repayments on your mortgage.
There may be a fee for mortgage advice. The actual amount you pay will depend upon your circumstances.
The fee is up to 1% but a typical fee is 0.3% of the amount borrowed.

These particulars do not constitute any part of an offer or contract. None of the statements contained in these particulars are to be relied on as statements or representations of fact and any intending purchaser must satisfy themselves by inspection or otherwise to the correctness of each of the statements contained in these particulars. The vendor does not make or give, and neither Carvers nor any person in their employment has any authority to make or give any representation or warranty whatever in relation to this property.