



Not for marketing purposes INTERNAL USE ONLY

Jupiter Road
Barton Seagrave KETTERING



Property Description

Situated in the highly sought-after village of Barton Seagrave, this beautifully presented three-bedroom detached home offers modern family living in a peaceful yet well-connected location. Built within a desirable newer development, the property combines contemporary style with practical design.

As you step into the property, you are welcomed by a bright entrance hall. To the left, the spacious lounge presented in immaculate show-home condition is bathed in natural light from a large front facing window. To the right the hallway provides access to a convenient cloakroom and storage / utility space. At the rear of the property, the home transitions into an impressive open-plan kitchen / breakfast and dining room with built in appliances and ample worktop and storage space, making it ideal for family use and entertaining guests, with a pleasant outlook and access to the garden.

Upstairs, the property hosts three well-proportioned bedrooms, including a comfortable main bedroom and ensuite located at the rear of the property and two further rooms suitable for children, guests or home working. A family bathroom completes the first-floor accommodation. The exterior of the property is just as impressive as the interior. The property benefits from a private rear garden, perfect for relaxing or outdoor dining along with a driveway offering convenient off-road parking.

Ground Floor

Entrance Hall

Entrance door to the front, stairs to the first floor, radiator, laminate flooring.

Lounge

Windows to the front, radiator, carpet flooring.

Cloakroom

Window, wash hand basin, low level WC, tiled splash back.

Kitchen / Diner

Windows and patio door to the rear, a range of wall and base units with rolled edge work surfaces, 1.5 sink drainer with mixer tap, integrated oven and hob with cooker hood, integrated appliances, breakfast bar, spot lights, radiator, laminate flooring.

First Floor

Bedroom One

Window, radiator, carpet flooring.

Bedroom Two

Window, radiator, carpet flooring.

Bedroom Three

Window, radiator, carpet flooring.

Externally

To The Front

Block paved, shrubbery.

Rear Garden

Enclosed by timber fencing, patio area, laid to lawn, garden shed.







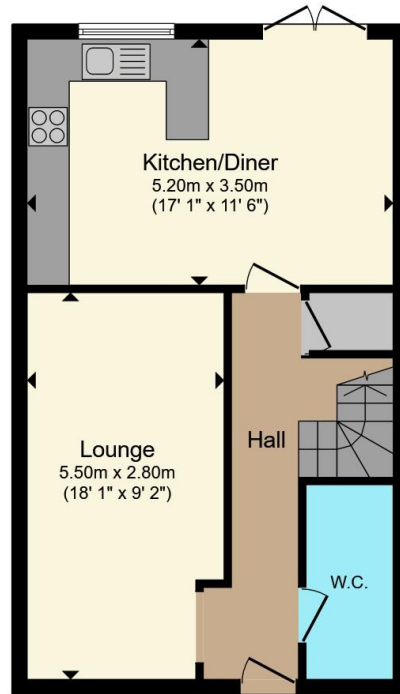

Ground Floor

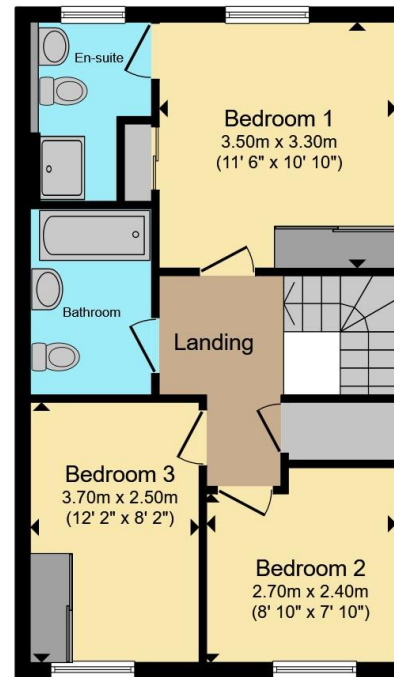

First Floor

Total floor area 94.6 m² (1,019 sq.ft.) approx

This floor plan is for illustrative purposes only. It is not drawn to scale. Any measurements, floor areas (including any total floor area), openings and orientation are approximate. No details are guaranteed, they cannot be relied upon for any purpose and they do not form part of any agreement. No liability is taken for any error, omission or misstatement. A party must rely upon its own inspection(s). Powered by www.propertybox.io



To view this property please contact Connells on

T 01536 411 811
E kettering@connells.co.uk

5 Montagu Street
KETTERING NN16 8XG

EPC Rating: B Council Tax
Band: D

Tenure: Freehold

[check out more properties at connells.co.uk](http://connells.co.uk)



1. MONEY LAUNDERING REGULATIONS Intending purchasers will be asked to produce identification documentation at a later stage and we would ask for your co-operation in order that there will be no delay in agreeing the sale. 2. These particulars do not constitute part or all of an offer or contract. 3. The measurements indicated are supplied for guidance only and as such must be considered incorrect. Potential buyers are advised to recheck measurements before committing to any expense. 4. We have not tested any apparatus, equipment, fixtures, fittings or services and it is in the buyers interest to check the working condition of any appliances.

Connells Residential is registered in England and Wales under company number 1489613, Registered Office is Cumbria House, 16-20 Hockliffe Street, Leighton Buzzard, Bedfordshire, LU7 1GN. VAT Registration Number is 500 2481 05.

See all our properties at www.connells.co.uk | www.rightmove.co.uk | www.zoopla.co.uk

Property Ref: KTT308798 - 0002