

# Towers Wills

Town & Country

📞 01935 577 032 | 01460 298 530 | ✉ info@towerswills.co.uk



## 45, Stoodham, South Petherton, Somerset TA13 5AS **£180,000**

Towers Wills are delighted to bring to the market this deceptively spacious two-bedroom mid-terraced home, superbly situated within the highly sought-after village of South Petherton. Offered with no onward chain, this property represents an excellent opportunity for first-time buyers, investors, or those looking to create a home tailored to their own tastes. Although requiring a degree of cosmetic updating and modernisation, the property boasts well-proportioned accommodation throughout, providing a fantastic canvas for prospective purchasers to put their own stamp on.

### Accommodation:

In brief, the accommodation comprises an entrance hall leading through to a generous lounge/diner, enjoying dual aspect windows which flood the room with natural light. To the rear of the property, the kitchen is well-appointed and offers access into a rear lobby/passageway, with doors leading out to the garden and into a useful outhouse/utility area.

To the first floor are two spacious double bedrooms, both served by a family bathroom.

### Outside:

Externally, the rear garden is predominantly laid to hard landscaping for ease of maintenance, making it ideal for those seeking a low-upkeep outdoor space. A particular feature of the property is the additional parcel of garden located beyond the rear boundary, offering further versatility and potential.

An early viewing is highly recommended to fully appreciate the generous proportions, potential, and desirable village setting this property has to offer.

## Key Features

- Popular Village Location
- Two Bedrooms
- Ideal First Time Buy/Buy to Let
- Gardens

## Contact Us

### Towers Wills Estate Agents - Yeovil

114, Hendford Hill

Yeovil

Somerset

BA202RF

T: 01935 577032

E: [info@towerswills.co.uk](mailto:info@towerswills.co.uk)

## Energy Efficiency

Score	Energy rating	Current	Potential
92+	A		
81-91	B		88 B
69-80	C	72 C	
55-68	D		
39-54	E		
21-38	F		
1-20	G		



# Floor Plan

GROUND FLOOR

1ST FLOOR

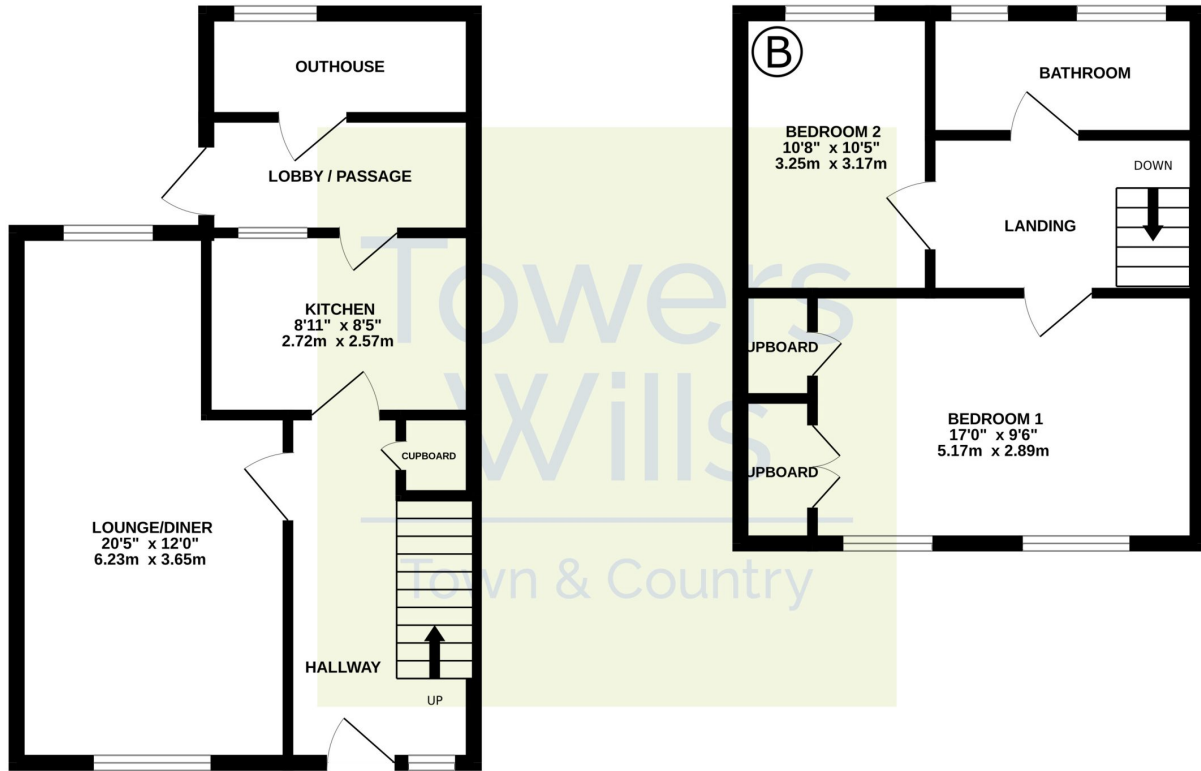

Whilst every attempt has been made to ensure the accuracy of the floorplan contained here, measurements of doors, windows, rooms and any other items are approximate and no responsibility is taken for any error, omission or mis-statement. This plan is for illustrative purposes only and should be used as such by any prospective purchaser. The services, systems and appliances shown have not been tested and no guarantee as to their operability or efficiency can be given.  
Made with Metropix ©2026

Please Note No tests have been undertaken of any of the services and any intending purchasers should satisfy themselves in this regard. Towers Wills Ltd for themselves and for the vendor of this property whose agents they are, give notice that, (i) these particulars do not constitute any part of an offer or contract, (ii) all statements contained within these particulars are made without responsibility on the part of Towers Wills or the vendor, (iii) whilst made in good faith, none of the statements contained within these particulars are to be relied upon as a statement of representation or fact, (iv) any intending purchaser must satisfy him/herself by inspection or otherwise as to the correctness of each of the statements contained within these particulars, (v) the vendor does not make or give either Towers Wills or any person in their employment any authority to make or give representation or warranty whatsoever in relation to this property.

Photographs / Floor Plans Photographs are reproduced for general information and it must not be inferred that any item is included for sale with this property. Please note floor plans are not to scale and are for identification purposes only. The photographs used in these particulars may have been taken with the use of a wide angle lens. If you have any queries as to the size of the accommodation or plot, please address these with the agent prior to making an appointment to view

**Towers Wills**

The White House, 114 Hendford Hill, Yeovil BA20 2RF

Yeovil 01935 577032 / South Petherton 01460 298530

[info@towerswills.co.uk](mailto:info@towerswills.co.uk) | [www.towerswills.co.uk](http://www.towerswills.co.uk)