



## **New Build Sutton Lane, Broughton Astley, LE9 6AG**

**£825,000**

A rare and exciting opportunity to purchase an executive BRAND NEW home extending to approximately 3,100 square feet, situated within the highly regarded hamlet of Sutton in the Elms. Forming part of an exclusive development of just ten homes, early reservation offers buyers the opportunity to personalise the property with a choice of high-quality fixtures and fittings.

Occupying a commanding plot, this impressive home offers exceptionally well-proportioned accommodation, briefly comprising: an entrance hallway, an outstanding 41ft open-plan living/dining kitchen, utility room, sitting room, and ground floor WC.

To the first floor are five generous double bedrooms, two benefitting from en suite facilities, together with a contemporary family bathroom.

Externally, the property will enjoy a generous landscaped rear garden, ample driveway parking, and a double garage.

### Offer Procedure

If you are obtaining a mortgage on this property, one of our qualified mortgage consultants will contact you to qualify the offer on behalf of our vendors.

In order to satisfy money laundering regulations Carlton Estates are required to carry out checks to verify each parties identity.

### Mortgages

Independent Mortgage advice is available through this office. If you wish to speak to our Independent Financial Adviser, please call our office to arrange an appointment.

### Thinking of Selling?

IF YOU ARE THINKING OF SELLING YOUR PROPERTY  
LET OUR LOCAL KNOWLEDGE AND EXPERIENCE WORK FOR YOU!

Carlton Estates are an independent and family run estate agency specialising in the local market, having a reputation for quality, service and customer care.

We value your business and understand that selling your home is a major decision.

Our guarantee to you is that through our professionalism and attention to detail in every respect, we will endeavor to ensure the entire process is as straight forward and hassle free as possible.

10 GOOD reasons to choose Carlton Estates:

- \* THE local agent
  - \* FREE market appraisal
  - \* REALISTIC valuations based on local market knowledge
  - \* EXTENSIVE advertising for maximum exposure
  - \* COMPETITIVE fees
  - \* REGULAR client feedback
  - \* MORTGAGE advice available
  - \* NO sale no fee
  - \* ACCOMPANIED viewing's where necessary
  - \* INTERNET advertising to include, Rightmove, ONTHEMARKET, FindaProperty and our own [www.carltonestates.co.uk](http://www.carltonestates.co.uk)
- CALL US NOW ON 0116 284 9636

### Notes For Purchasers

While every reasonable effort is made to ensure the accuracy of descriptions and content, we should make you aware of the following guidance or limitations.

(1) MONEY LAUNDERING REGULATIONS Intending purchasers will be asked to produce identification documentation at a later stage and we would ask for your cooperation in order that there will be no delay in agreeing the sale.

(2) These particulars do not constitute part or all of an offer or contract.

(3) The measurements indicated are supplied for guidance only and as such must be considered incorrect.

(4) Potential buyers are advised to recheck the measurements before committing to any expense.

(5) Carlton Estates (Narborough) Ltd has not tested any apparatus, equipment, fixtures, fittings, or services and it is in the buyer's interests to check the working condition of any appliances.

### Opening Hours

MONDAY - FRIDAY : 9:00am - 17:30pm SATURDAY : 10:00am - 14:00pm



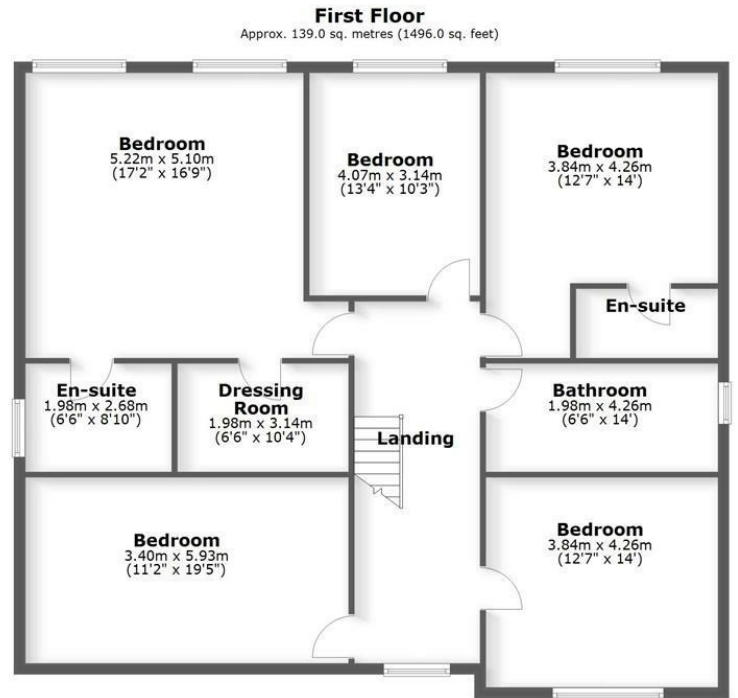

Total area: approx. 290.5 sq. metres (3126.5 sq. feet)



Energy Efficiency Rating	Current	Potential
Very energy efficient - lower running costs		
(92 plus) <b>A</b>		
(81-91) <b>B</b>		
(69-80) <b>C</b>		
(55-68) <b>D</b>		
(39-54) <b>E</b>		
(21-38) <b>F</b>		
(1-20) <b>G</b>		
Not energy efficient - higher running costs		
<b>England &amp; Wales</b>	EU Directive 2002/91/EC	

Environmental Impact (CO <sub>2</sub> ) Rating	Current	Potential
Very environmentally friendly - lower CO <sub>2</sub> emissions		
(92 plus) <b>A</b>		
(81-91) <b>B</b>		
(69-80) <b>C</b>		
(55-68) <b>D</b>		
(39-54) <b>E</b>		
(21-38) <b>F</b>		
(1-20) <b>G</b>		
Not environmentally friendly - higher CO <sub>2</sub> emissions		
<b>England &amp; Wales</b>	EU Directive 2002/91/EC	