

FLOOR PLAN:

Approximate Gross Internal Area = 18.4 sq m / 198 sq ft

room

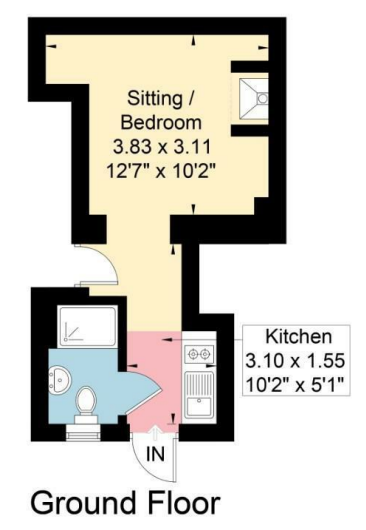

Key
 Kitchen
 Living Area
 Bedroom
 Bathroom
 Storage

These plans are prepared in accordance with the guidelines as set out by the RICS Code of Measuring Practice. Whilst every attempt has been made to ensure accuracy, all measurements should be treated as approximate and as such are for illustrative purposes only. Not to Scale. Photography (Drones) Video Tours (360 Views) Energy Performance Certificates (Design Print) www.zestlovesproperty.com

EPC CHART:

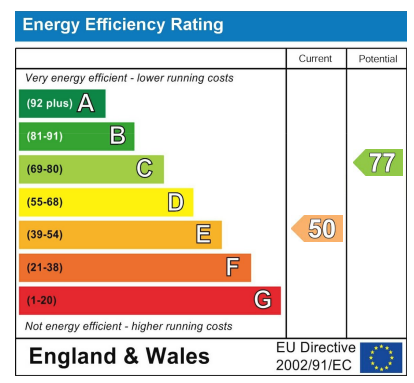

ZEST PROPERTY SERVICES

1a Mile End
 London road
 Bath
 BA1 6pt

T: 01225 48 10 10
 E: happytohelp@zestlovesproperty.com



VIEWING AND OFFER PROCEDURE: If you wish to view this property, please contact our office on the number provided. All offers on this property should be made through this office. In order to fulfill our responsibilities to the seller, when offering on this property, you will be asked a series of questions about how you intend to fund the purchase and whether or not your offer is dependent on the sale of another property. This information provided by you, along with the amount of your offer, will then be forwarded onto the seller for consideration.

MONEY LAUNDERING REGULATIONS – Intending purchasers will be asked to produce identification documentation at a later stage and we would ask for your cooperation with this in order that there will be no delay in agreeing the sale.

DISCLAIMER: All appliances, apparatus, equipment, fixtures and fittings listed in these details are only 'as seen' and have not been tested by Zest, nor have we sought certification of warranty or service, unless otherwise stated. It is in the buyers interests to check the working condition of any appliances. Any floor plans and or measurements provided are given as a general guide to room layout and design only. They are supplied for guidance only – they are not exact and must not be relied upon for any purpose, and therefore must be considered incorrect. As a potential buyer you are advised to recheck the measurements before committing to any expense. These details are offered on the understanding that all negotiations are to be made through this company. Neither these particulars, nor verbal representations, form part of any offer or contract, and their accuracy cannot be guaranteed. Zest has not sought to verify the legal title of the property and the buyer(s) must obtain verification from their solicitor.



11a, Claverton Buildings, Bath, BA2 4LD

1 Bedroom Flat - Studio

Offers in excess of £170,000

- A charming studio apartment in the heart of Widcombe
- Currently operating as a holiday let
- No onward chain
- Bedroom, kitchen and shower room
- Private entrance
- Leasehold, EPC rating E, Council Tax band A

DETAILS

A quaint ground floor studio apartment within easy walking distance to Bath city centre. Holiday lets permitted.



DESCRIPTION

A charming ground floor studio apartment, currently operating as a holiday let. The property comprises bedroom with stunning stone fireplace, kitchenette, separate shower room and it's own private access. The property is within excellent walking distance to Bath Train Station and the rest of the city centre, as well as the amenities on Widcombe High Street. Achieving an annual income of approximately £23,000.

LOCATION

Widcombe is located on the South side of the city, just across the river and is one of Bath's most desirable

residential areas. Widcombe high street is thriving, with many independent shops, boutiques, cafes, delis, convenience stores and pubs. Widcombe also benefits from a doctors surgery, dentist and veterinary surgery and the ever popular prior park garden centre. With a number of churches in the area, and a fantastic infant and junior school, it is not surprising that Widcombe is a much sought after area for families. Just a 5 minute walk takes you in to Bath city centre and Bath Spa Railway Station, with fast trains every 30 minutes to London Paddington, and every 15 minutes to Bristol.

TENURE

Leasehold
999 year lease from 2013
Management company: Bath Leasehold Management
Management fee: £900 per annum