

Windermere

£1,600 pcm

Birkdale Cottage
Helm Road
Windermere
Cumbria
LA23 2NN

A newly renovated three bedroom, detached home, in beautiful surroundings. Comprising; two reception rooms, kitchen, three bedrooms and a bathroom. Externally there is parking for two cars and a large mature garden and greenhouse.

- Three Bedroom Cottage
- Fitted Kitchen & Two Reception Rooms
- Large Mature Gardens With a Greenhouse
- Parking For Two Cars
- Close Proximity To Bowness
- Beautiful Countryside Setting
- Unfurnished
- No Smokers
- Council Tax Band F
- Available Soon & Long Term

Property Ref: WR488



Location: From the roundabout in Bowness, continue up the hill towards Windermere and take the first turning on the right, onto Helm Road. Continue onto Helm Road to the top of the hill and where the road turns sharply left onto Biskey Howe Road, continue a short distance further, where there is a cross roads. At the cross roads, take a right hand turn and follow the road over the cattle grid. Birkdale Cottage can be located on the left hand side after Birkdale House.

What3Words: [///admire.merely.spoon](https://www.what3words.com/#!/en-gb////admire.merely.spoon)

Furnishings: This property is offered unfurnished.

Services: Mains Electric, Private Water, Shared Septic Tank (Costs to be shared). Internet Speed:
<https://checker.ofcom.org.uk/en-gb/broadband-coverage#pc=LA61RB&uprn=100110695355>

Viewings: Strictly by appointment with Hackney & Leigh.

Ongoing Tenancy Management: Once the referencing is complete, the landlords will be organising the tenancy documents and necessary paperwork. Upon tenancy commencement the property will be directly managed by the landlord.

Applying for a Tenancy: Tenancy Application Forms are available from any Hackney & Leigh office, on our website and will be e-mailed automatically following a viewing to the e-mail address provided. An application form should be completed for any intended occupants aged 18 yrs and above . Upon acceptance of an application the payment of the Holding Deposit (one weeks rent) is required, payable either by debit or credit card or bank transfer. This is paid to reserve the property and will be held by us for a period of 15 days unless we agree otherwise.

All adults of 18yrs and over who will be living at the property will be asked to provide evidence of nationality and identity to validate their "Right to Rent" under the Immigration Act 2014.

Referencing: All applicants will be required to provide satisfactory references eg: employer, current landlord and two character references. For the self-employed, a reference from your accountant or solicitor will be required. A credit reference will be obtained for each applicant. Acceptance of references and the offer of a tenancy is at our discretion.

The Tenancy: The property will be let on an Assured Periodic Tenancy Agreement (APT). The tenancy continues on a rolling periodic basis until either party serves notice to terminate the agreement. To end the tenancy a tenant is required to provide a minimum of two month's notice, to end on the last day of a rent period. The landlord is required to serve a Section 8 notice to bring the tenancy to an end, using the relevant grounds for repossession.

The tenant is responsible for Council Tax for the tenancy period and for all charges for water and sewerage, gas, electricity, telephone or other utility/service providers' charges supplied to the tenant during the tenancy.

Deposit & Rent: The successful Tenant will be required to pay a deposit (equal to a maximum of 5 weeks rent depending on the property). This will be held in accordance with the Tenancy Deposit Scheme Regulations and will be re-fundable at the end of the tenancy, subject to the property being left in a satisfactory condition. Rent is payable on or by each rent day and is payable by standing order. One month's rent in advance PLUS the deposit is required after the APT has been signed, but prior to the tenancy start date and keys being released. Please Note: It is NOT possible to use the deposit as rent for the final month.

Pets: An applicant is required to advise if they have pets, and their application must be fairly considered. Pets may not be acceptable for a number of reasons including allergies/medical reasons, conditions within the property lease, lack of outside space, communal grounds or close proximity to a main road. If a pet is accepted the landlord is permitted to request that the tenant has the relevant pet insurance in place in order to protect the property.

Insurance: It is the Tenants' responsibility to insure their own possessions. Tenants are strongly advised to take out accidental damage cover in respect of the Landlord's property and contents.

Energy Performance Certificate: The full Energy Performance Certificate is available on our website www.hackney-leigh.co.uk and also at any of our offices.

How to rent: Prospective tenants are advised to read the government's leaflet which is available here:
<https://www.gov.uk/government/publications/how-to-rent>



Kitchen



Garden

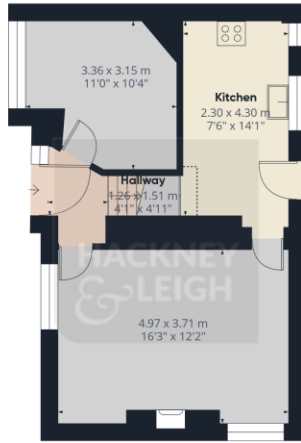

Floor 0

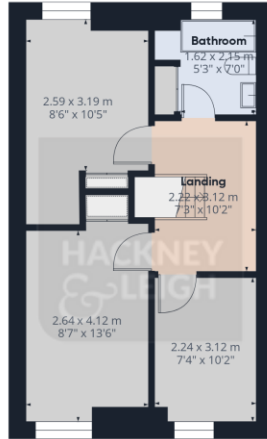

Floor 1



Approximate total area⁽¹⁾

81.4 m²
875 ft²

Reduced headroom

0.3 m²
3 ft²

(1) Excluding balconies and terraces

Reduced headroom
..... Below 1.5 m/5 ft

Calculations reference the RICS IPMS 3C standard. Measurements are approximate and not to scale. This floor plan is intended for illustration only.

GIRAFFE 360



Helm Road Windermere - Ref: WR488

Property particulars and appointments to view are provided on the understanding that all negotiations are conducted through Hackney and Leigh Ltd. This information is provided for general guidance only. It does not form part of any contract or agreement and no guarantee of accuracy is given. Prospective tenants should make their own enquiries as to the suitability or otherwise of the property. No responsibility can be accepted for any loss or expense incurred in viewing or in the event of a property being let or withdrawn. Please contact us to confirm the property's availability, especially if travelling some distance.