



## Culford Gardens, SW3

**£1,500** Per week

Fabulous three bedroom, three bathroom apartment to rent in the heart of Sloane Square. The property has been finished to a high standard thus making this the perfect property for a professional family or couple looking for the finer things in life!

Culford Gardens is a very close walk from Sloane Square with easy access to all amenities and shops, bars and restaurants of Kings Road and the Duke of York Square. The Saturday markets on the Duke of York Square are an absolute must!

### Features

- Three Double Bedrooms
- Three Bathrooms
- Separate Study
- Open-Plan Kitchen
- Split-Level Apartment
- Wood Floors Throughout



## Culford Gardens, SW3

The property is arranged over two floors with a spacious reception room, large open plan kitchen, three double bedrooms, a study and three bathrooms.

The property has been finished to a high standard throughout, has wood floors in the entertaining areas and bedrooms and the bathrooms have modern fixtures and fittings.

The property is located in one of the most prestigious and famous red brick mansion blocks in Sloane Square making this property a must see!





# Culford Gardens, London, SW3

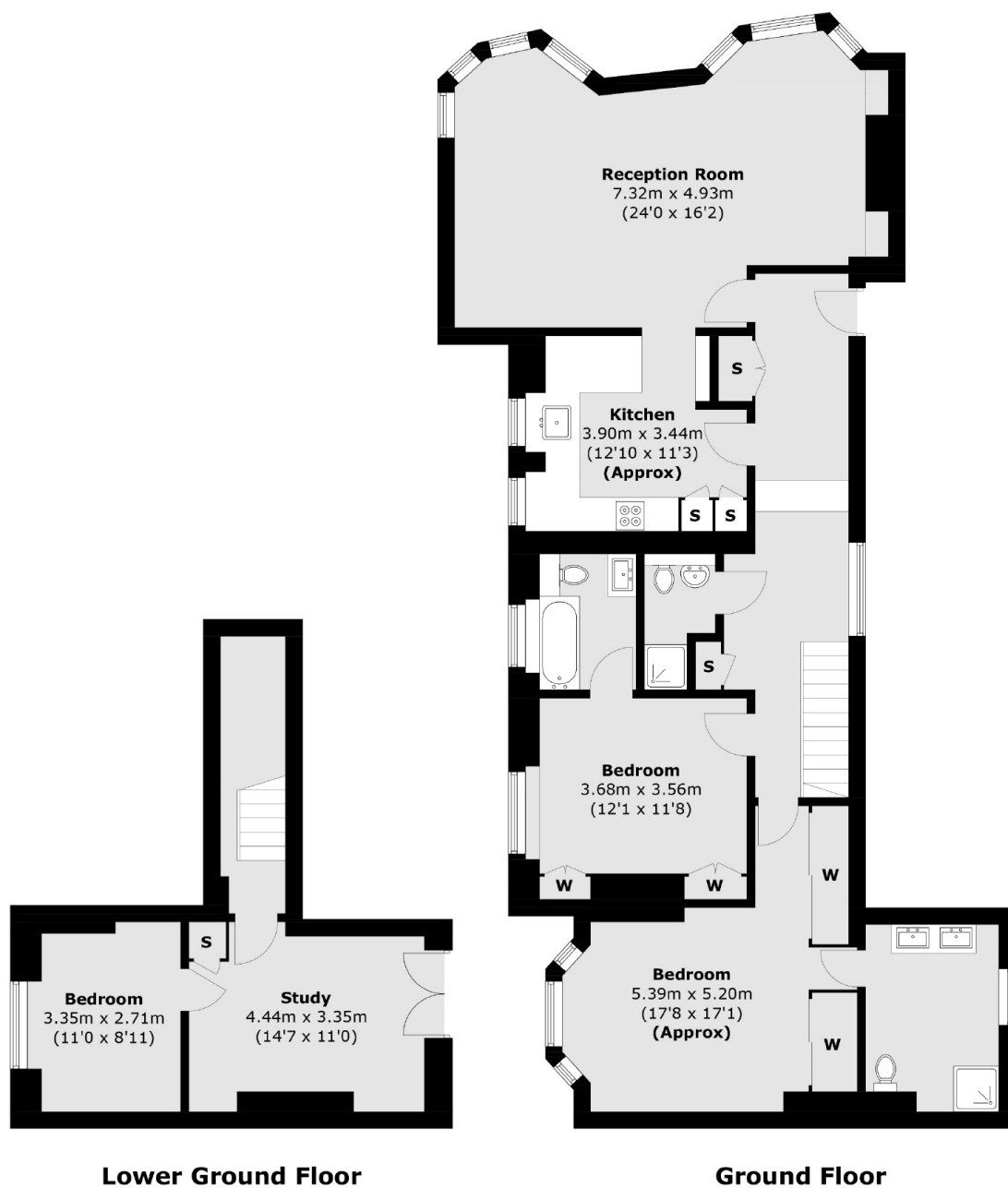

Total area (approx.): 148.7 sq. m (1,600.0 sq. ft)

## Dexters

Chelsea and Belgravia  
45 Sloane Avenue  
London  
SW3 3DH  
Lettings  
020 7590 9500

Energy Rating: E. We aim to make our particulars both accurate and reliable. However they are not guaranteed; nor do they form part of an offer or contract. If you require clarification on any points then please contact us, especially if you're traveling some distance to view. Please note that appliances and heating systems have not been tested and therefore no warranties can be given as to their good working order.

**RICS** Regulated  
Estate Agent  
and Letting Agent

dexters.co.uk