

# HUNTERS<sup>®</sup>

HERE TO GET *you* THERE



## Grazebrook Road

Stoke Newington, N16 0HU

£1,695 Per Month



\*\*\* SUITABLE FOR SINGLE OCCUPANT ONLY \*\*\* Well-presented and neutrally decorated throughout, this one bedroom apartment which is situated on the first floor of this Victorian conversion. The apartment benefits from well-proportioned accommodation including double bedrooms, separate fitted kitchen, spacious lounge and bathroom. Grazebrook Road is within close proximity to the Stoke Newington Church Street and the splendid open spaces of Clissold Park. Located close to a number of transport links including Stoke Newington National Rail and a number of bus routes that go directly in to city.



Area Map



Floor Plans

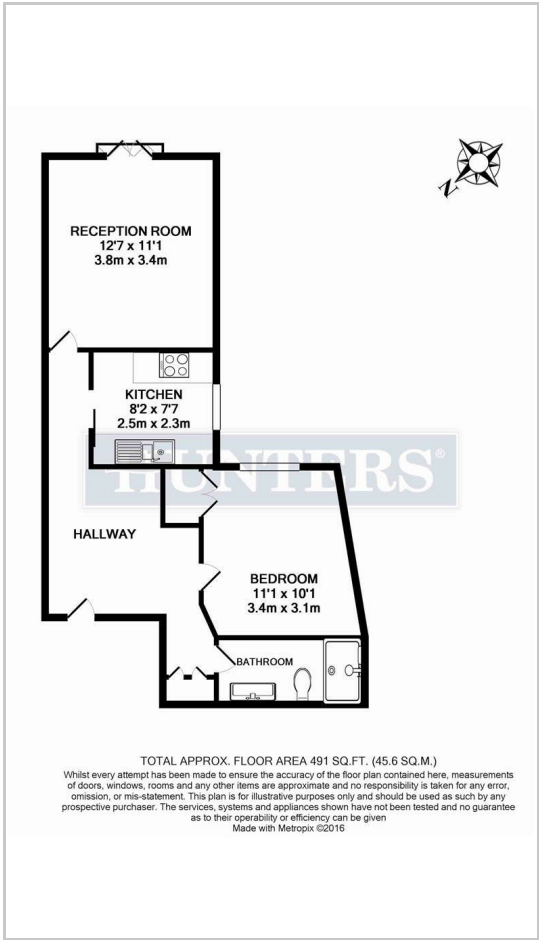

Energy Efficiency Graph

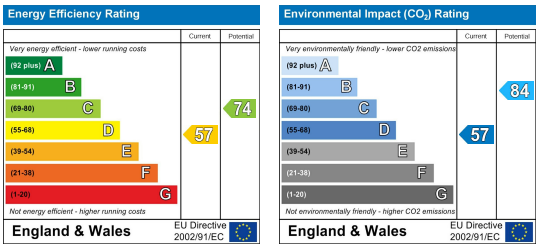

These particulars are intended to give a fair and reliable description of the property but no responsibility for any inaccuracy or error can be accepted and do not constitute an offer or contract. We have not tested any services or appliances (including central heating if fitted) referred to in these particulars and the purchasers are advised to satisfy themselves as to the working order and condition. If a property is unoccupied at any time there may be reconnection charges for any switched off/disconnected or drained services or appliances - All measurements are approximate. **THINKING OF SELLING?** If you are thinking of selling your home or just curious to discover the value of your property, Hunters would be pleased to provide free, no obligation sales and marketing advice. Even if your home is outside the area covered by our local offices we can arrange a Market Appraisal through our national network of Hunters estate agents.