



Guide Price
£450,000

Leasehold

2x  1x  1x 

Hitcham Road,
Walthamstow, E17



Main features

- Charming Warner-built apartment
- Spacious double bedrooms
- Large, bright lounge area
- Fitted kitchen and family bathroom
- Own section of rear garden
- Fantastic location close to amenities and transport links

Accommodation

GROUND FLOOR

Lounge: 10'8 x 10'6 (3.25m x 3.20m)

Kitchen: 7'9 x 7'7 (2.36m x 2.31m)

Bedroom 1: 11'1 x 11'1 (3.38m x 3.38m)

Bedroom 2: 10'8 x 10'6 (3.25m x 3.20m)

Bathroom

OUTSIDE

Rear Garden

Ground Floor
Approx. 61.0 sq. metres (656.6 sq. feet)

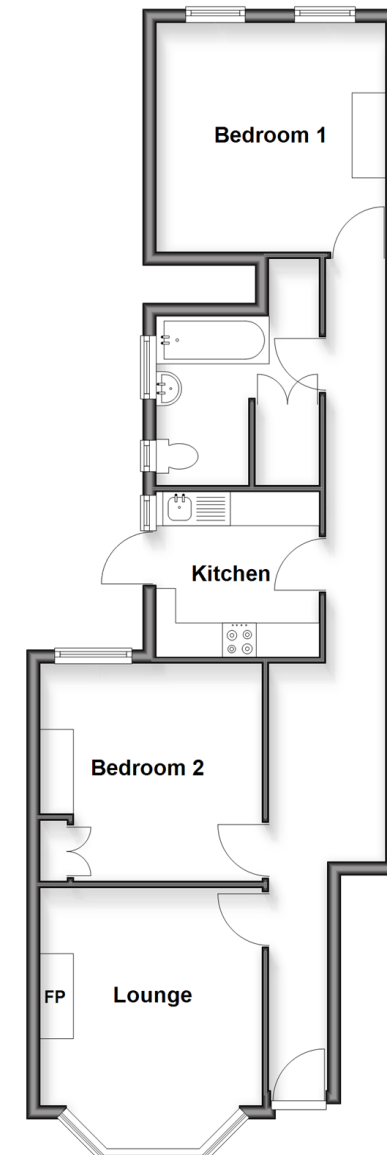

Call Walthamstow - 020 8509 0092 ■ douglasallen.co.uk

- A private rental licensing scheme applies to some properties in this area, please check with the Local Authority before proceeding
- Legal advice should be taken to verify fixtures/fittings, planning, alterations and/or lease details
- Appliances & services are untested, dimensions are approximate and floor plans are not to scale



53118147/20260314/CP1/SC