



LEAH NESBITT

exp

@ leah.nesbitt@exp.uk.com

leahnesbitt.exp.uk.com

07494 000 451

Broomfield Avenue, NE6 4PH

Guide Price £270,000

🛏️ 2 🚿 1 🚗 1



- Large south facing garden
- Quiet residential street
- Close to amenities
- Two large double bedrooms
- Open plan living space
- Close to transport links
- Beautifully presented throughout
- Driveway parking
- Please Quote REF: LN1525



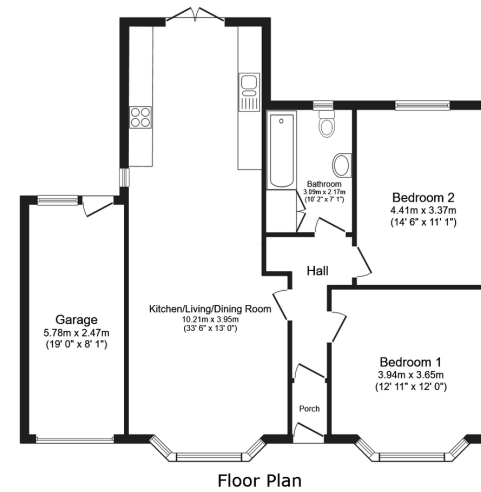

Total floor area: 97.7 sq.m. (1,052 sq.ft.)

This floor plan is for illustrative purposes only. It is not drawn to scale. Any measurements, floor areas (including any total floor area), openings and orientations are approximate. No details are guaranteed, they cannot be relied upon for any purpose and do not form any part of any agreement. No liability is taken for any error, omission or misstatement. A party must rely upon its own inspection(s). Powered by www.Propertybox.io

Please Quote REF: LN1525

Beautifully presented two-bedroom bungalow tucked away in a quiet cul-de-sac in the sought-after area of Walkerville. Just a short walk from Walkergate Metro, offering easy access into Newcastle city centre or out to the coast for beach days and seaside walks. The area is perfect for those seeking tranquillity, while still benefiting from a strong community feel, with local shops, pubs, cafés and schools all within walking distance. The home features a bright and stylish open-plan kitchen, dining and living space, two generous double bedrooms, a large south-facing garden perfect for relaxing or entertaining, and a spacious driveway with ample parking for a multi-car household. A warm, modern home in a fantastic location.

