



£395,000

CARISBROOKE AVENUE GEDLING

- DETACHED BUNGALOW
- TWO BEDROOMS
- LOUNGE/DINER
- CONSERVATORY
- DETACHED GARAGE
- EPC D



Well-Presented Two-Bedroom Detached Bungalow with No Chain

THIS WELL-PRESENTED TWO-BEDROOM DETACHED BUNGALOW OFFERS A FANTASTIC OPPORTUNITY FOR A WIDE RANGE OF BUYERS, WHETHER YOU'RE LOOKING TO DOWNSIZE WITHOUT COMPROMISE OR SEARCHING FOR A VERSATILE FAMILY HOME. SITUATED IN A POPULAR AND CONVENIENT LOCATION, THE PROPERTY IS WITHIN EASY REACH OF A VARIETY OF LOCAL AMENITIES, INCLUDING SHOPS, EXCELLENT SCHOOLS, SUPERB TRANSPORT LINKS, AND GEDLING COUNTRY PARK.

ENTERED VIA A WELCOMING HALLWAY, THE HOME OPENS INTO A SPACIOUS AND NATURALLY BRIGHT LOUNGE/DINING ROOM, OFFERING AN IDEAL SETTING FOR BOTH RELAXING AND ENTERTAINING. PATIO DOORS LEAD SEAMLESSLY INTO THE CONSERVATORY, CREATING AN ADDITIONAL VERSATILE LIVING SPACE WITH LOVELY VIEWS OVER THE REAR GARDEN. THE FITTED KITCHEN/DINER PROVIDES AMPLE STORAGE AND WORKSPACE, ALONG WITH PLENTY OF ROOM FOR EVERYDAY DINING.

THE PROPERTY OFFERS TWO GENEROUS DOUBLE BEDROOMS, BOTH BENEFITTING FROM FITTED WARDROBES AND PROVIDING EXCELLENT STORAGE SOLUTIONS. A MODERN SHOWER ROOM, FINISHED TO A HIGH STANDARD, COMPLETES THE INTERNAL ACCOMMODATION.

EXTERNALLY, THE PROPERTY CONTINUES TO IMPRESS WITH OFF-ROAD PARKING FOR MULTIPLE CARS TO THE FRONT AND A DETACHED DOUBLE GARAGE WITH ELECTRIC DOOR, OFFERING EXCELLENT PRACTICALITY AND STORAGE. TO THE REAR, THE GENEROUS AND PRIVATE GARDEN IS IDEAL FOR OUTDOOR LIVING, FEATURING A PAVED PATIO AREA AND A WELL-MAINTAINED LAWN, CREATING A PLEASANT AND VERSATILE SPACE FOR RELAXATION AND ENTERTAINING.

COMBINING GENEROUS INDOOR AND OUTDOOR SPACE WITH A HIGHLY DESIRABLE LOCATION, THIS BUNGALOW OFFERS BOTH COMFORT AND FLEXIBILITY, MAKING IT A MUST-SEE HOME.

- FREEHOLD
- COUNCIL TAX; BAND D
- LOCAL AUTHORITY; GEDLING BOROUGH COUNCIL
- MEASUREMENTS; 83 SQ METERS

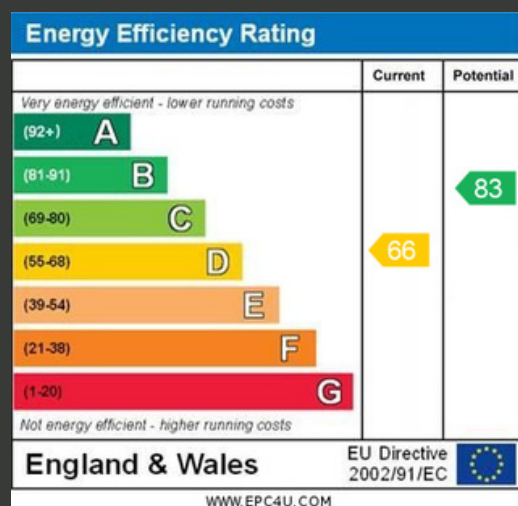



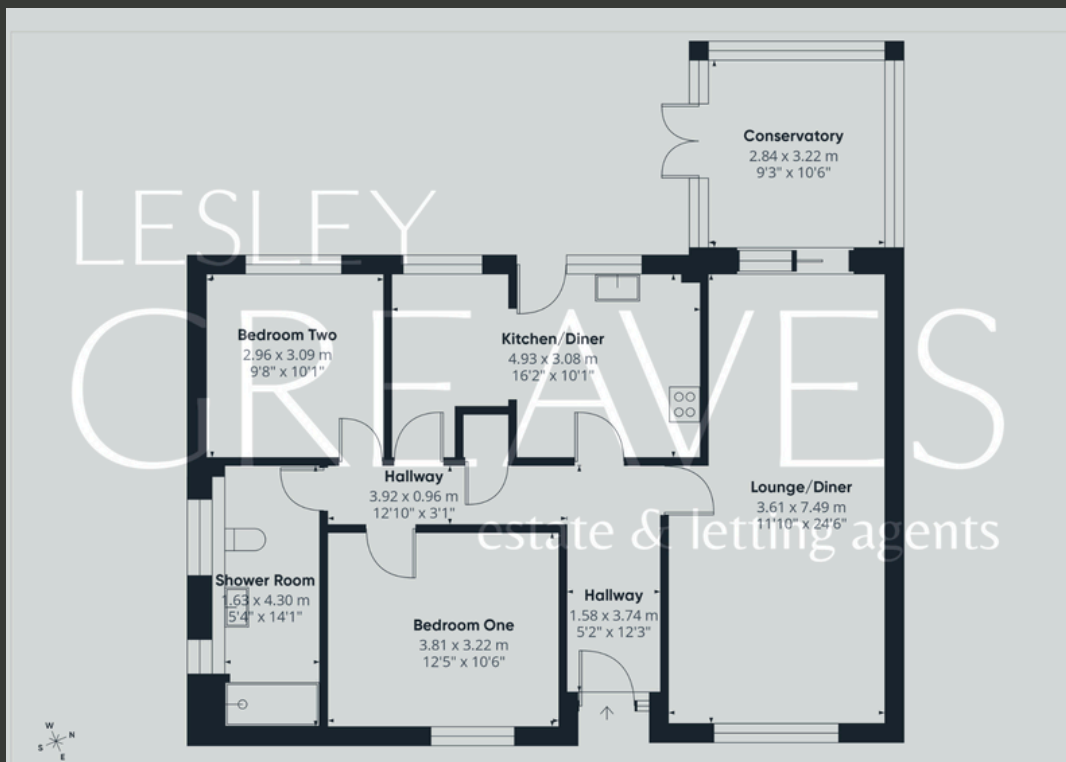

Agent's Note: These particulars have been prepared in good faith and are provided for guidance purposes only. While every effort has been made to ensure their accuracy, they should not be relied upon as exact. All measurements are approximate, and floor plans are for illustrative purposes only. Prospective buyers or tenants are advised to verify all details independently, conduct their own due diligence, and note that services, systems, and appliances have not been tested.

Lesley Greaves Estate & Lettings Agents

22 Main Road ,Gedling, Nottingham, NG4 3HP

0115 9877337

sales@lesleygreaves.co.uk