



Rotherfield Street, N1

£392 Per week

A one bedroom apartment on the top floor of purpose built block with a shared communal garden. This property has a spacious living room, separate kitchen, double bedroom and hard flooring throughout.

Rotherfield Street is within close proximity to Angel underground station (Northern Line), Highbury and Islington station (Victoria and Overground) and Essex Road rail station as well as excellent bus links. Upper Street's superb selection of shops, bars restaurants are also close by.

Features

- One Bedroom
- Top Floor Apartment
- Shared Garden
- Bright Reception Room
- Separate Kitchen
- Close to Transport

Rotherfield Street, London, N1

ROTHERFIELD STREET, N1

Approx. gross internal area

431 Sq Ft / 40.0 Sq M.

Representation of current layout

Not to scale.

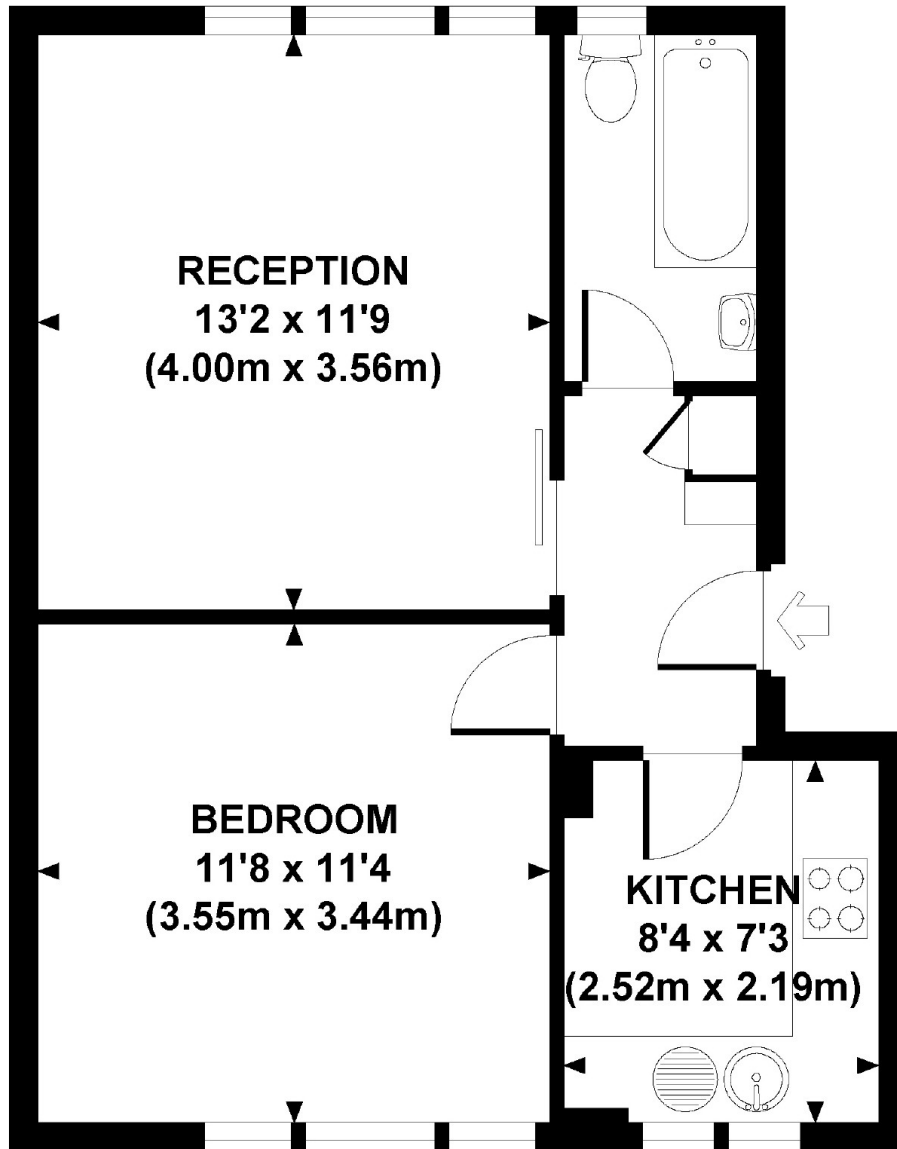

SECOND FLOOR