



Apartment (EPC Rating: C)

13 RAVEN WALK, HEREFORD, HR2 7TL

£675 Per Calendar Month



1 Bedroom Apartment located in Hereford

| VIEWINGS FROM JUNE 15th 2026 | One Bedroom Apartment | Kitchen | Sitting Room | Shower Room | Allocated Parking For One Vehicle | EPC C Rating | Available For Immediate Subject To Referencing and Landlords Consent |

The Property

From the front of the property the entrance door opens into a hallway with staircase rising to landing. The landing has doors off, storage cupboard with space and plumbing for washing machine, smoke alarm and panel radiator.

Off the landing is the shower room with window to front, WC, vanity style unit with inset basin and cupboard below, shower cubicle, panel radiator and vinyl flooring.

The bedroom is a double room with window to rear, TV aerial and panel radiator.

The sitting room has a window to rear, telephone point, TV aerial, panel radiator, central heating thermostat, storage cupboard and wood effect laminate flooring.

The kitchen offers a selection of base and wall mounted cabinets, sink, 4 ring electric hob, integrated oven, roll edge worksurfaces, space and plumbing for washing machine, wall mounted Worcester boiler, splashback wall tiling, extractor fan and vinyl flooring.

Outside there is allocated parking one vehicle and communal garden to the rear.

Affordability And Household Income

To qualify for the income requirements when applying for this property our referencing company require proof of a minimum household income of £20,250. Should a guarantor be required to support an application, an income of £24,300 would be required.

Services And Expenditure

Services - Mains electricity, drainage and water. Mains gas central heating.

Hereford County Council - Tax - Band A

Broadband Connectivity - 8000Mbps Download. 8000Mbps Upload - Ultrafast - Source Ofcom

Tenancy Information And Permitted Payments

For information and payments in relation to the property please follow the Tenancy Information link. This can be found above or below the asked rent when visiting Rightmove, On The Market and Zoopla. If viewing on our own website this information can be found by selecting Tenant Guide from the To Let drop down menu.

Viewings

VIEWINGS FROM JUNE 15th 2026. In order to request a viewing we ask that all applicants complete our Pre-Qualifying application through our referencing and tenancy platform Goodlord.



FLINT AND COOK HEREFORD LETTINGS | 22 BROAD STREET, HEREFORD,
HEREFORDSHIRE, HR4 9AP

First Floor

Approx. 47.6 sq. metres

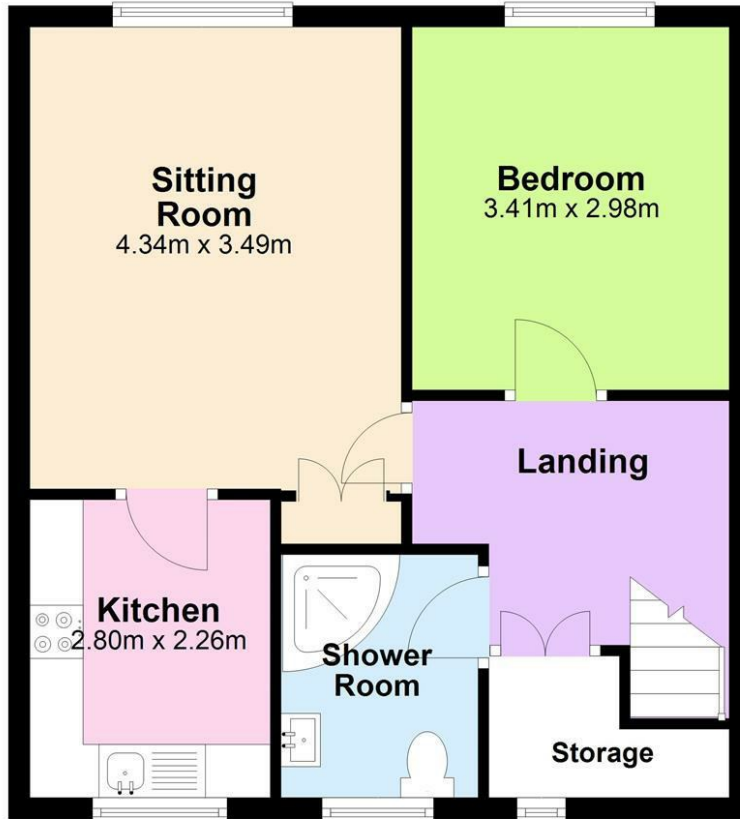

Total area: approx. 47.6 sq. metres

Council Tax Band

A

Energy Performance Graph

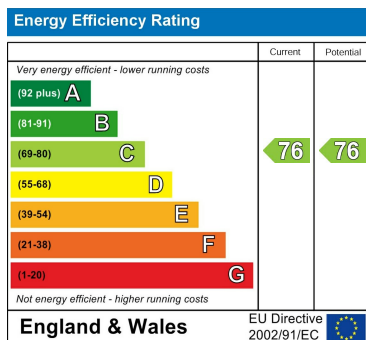

Call us on

01432 355455

lettings@flintandcook.co.uk

<https://www.flintandcook.co.uk/>

Agents Note: Whilst every care has been taken to prepare these particulars, they are for guidance purposes only. All measurements are approximate and are for general guidance purposes only and whilst every care has been taken to ensure their accuracy, they should not be relied upon and potential buyers are advised to recheck the measurements.

