



14 Braybank, Bray, Maidenhead SL6 2BQ

welcome to

14 Braybank, Bray, Maidenhead

Situated in the highly desirable village of Bray, just moments from Maidenhead, Braybank offers a rare opportunity to acquire a two-bedroom flat within a private residential development in an exceptional riverside setting. This property enjoys truly stunning views, positioned right alongside the River Thames, creating a peaceful and picturesque backdrop that is hard to match. The flat itself offers a well-balanced layout with two bedrooms, a bright living space, and excellent natural light throughout. The property also offers a single garage opposite with a fantastic room above making for an ideal home office/storage space. While in need of refurbishment, the property presents an exciting opportunity for buyers to modernise and add value, tailoring the space to their own taste and requirements. Whether as a primary residence, weekend retreat, or investment, the potential here is significant. Bray is renowned for its charm, riverside walks, and excellent dining, all while being conveniently located near Maidenhead with its superb transport links, including access to London via the Elizabeth Line. Braybank combines location, views, and opportunity-making it an ideal purchase for those seeking a project in one of Berkshire's most sought-after riverside villages. **Property is offered for sale through Modern Auction which is operated by iamsold Limited.**





Braybank, Bray, Maidenhead, SL6

Approximate Area = 987 sq ft / 91.6 sq m

For identification only - Not to scale

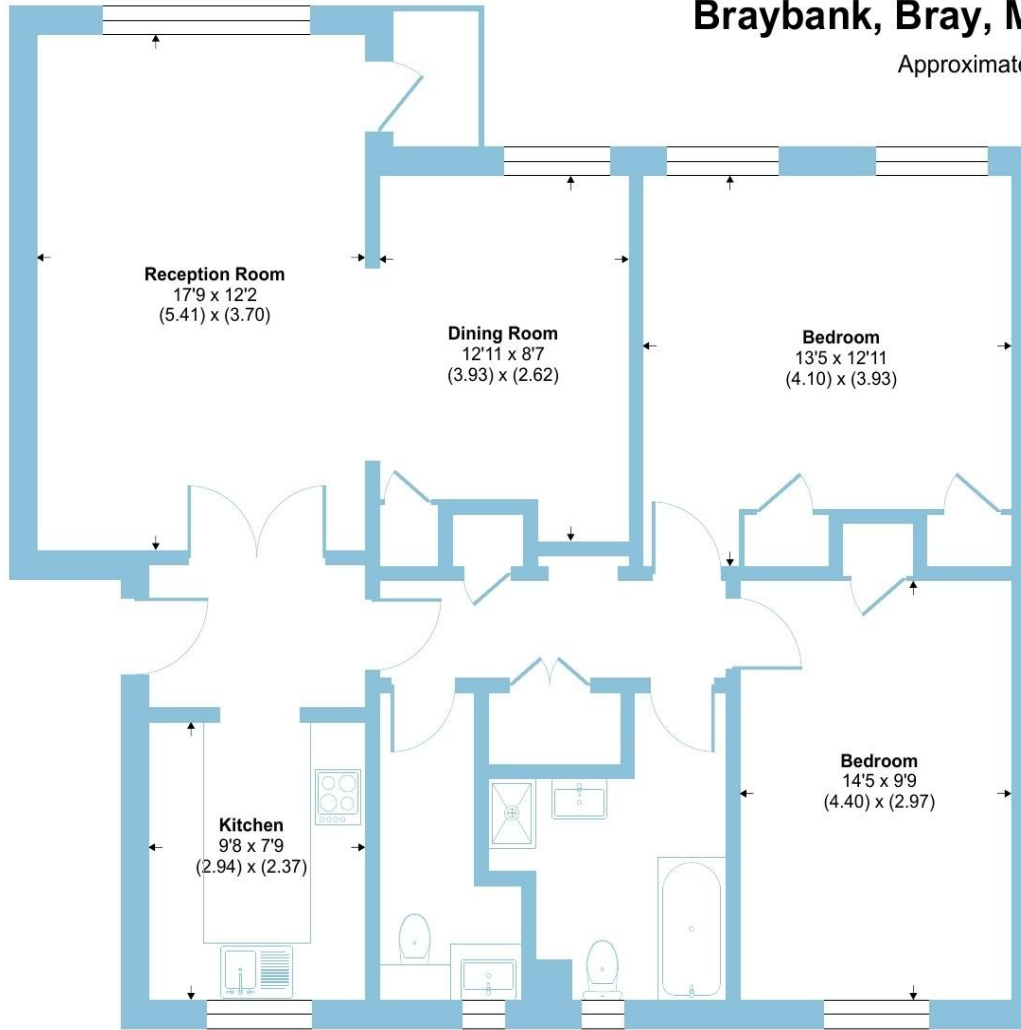

First Floor



Floor plan produced in accordance with RICS Property Measurement 2nd Edition, incorporating International Property Measurement Standards (IPMS2 Residential). © nichecom 2026. Produced for Barnard Marcus. REF: 1453538



Auctioneer's Comments

This property is offered through Modern Method of Auction. Should you view, offer or bid your data will be shared with the Auctioneer, iamsold Limited. This method requires both parties to complete the transaction within 56 days, allowing buyers to proceed with mortgage finance (subject to lending criteria, affordability and survey). The buyer is required to sign a reservation agreement and make payment of a non-refundable Reservation Fee of 4.5% of the purchase price including VAT, subject to a minimum of £6600.00 including VAT. This fee is paid in addition to purchase price and will be considered as part of the chargeable consideration for the property in the calculation for stamp duty liability. Buyers will be required to complete an identification process with iamsold and provide proof of how the purchase would be funded. The property has a Buyer Information Pack containing documents about the property. The documents may not tell you everything you need to know, so you must complete your own due diligence before bidding. A sample of the Reservation Agreement and terms and conditions are contained within this pack. The buyer will also make payment of no more than £349 inc. VAT towards the preparation cost of the pack. Please confirm exact costs with the auctioneer. The estate agent and auctioneer may recommend the services of other providers to you, in which they will be paid for the referral. These services are optional, and you will be advised of any payment, in writing before any services are accepted. Listing is subject to a start price and undisclosed reserve price that can change.

welcome to

14 Braybank, Bray Maidenhead

- Sale by Modern Auction (T&Cs apply)
- Subject to an undisclosed Reserve Price
- Buyers fees apply
- PRIVATE RESIDENTIAL DEVELOPMENT
- EXCEPTIONAL RIVERSIDE SETTING
- RARE OPPORTUNITY
- GARAGE WITH ROOM ABOVE IDEAL FOR A HOME OFFICE OR STORAGE

Tenure: Leasehold EPC Rating: D

Council Tax Band: E Service Charge: 3800.00

Ground Rent: None

This is a Leasehold property with details as follows; Term of Lease 249 years from 25 Dec 1964. Should you require further information please contact the branch. Please Note additional fees could be incurred for items such as Leasehold packs.

guide price

£370,000



Please note the marker reflects the postcode not the actual property

check out more properties at rogerplatt.co.uk



Property Ref:
MHD123343 - 0002

1. MONEY LAUNDERING REGULATIONS Intending purchasers will be asked to produce identification documentation at a later stage and we would ask for your co-operation in order that there is no delay in agreeing the sale. 2. These particulars do not constitute part or all of an offer or contract. 3. The measurements indicated are supplied for guidance only and as such must be considered incorrect. Potential buyers are advised to recheck measurements before committing to any expense. 4. We have not tested any apparatus, equipment, fixtures or services and it is in the buyers interest to check the working condition of any appliances. 5. Where an EPC, or a Home Report (Scotland only) is held for this property, it is available for inspection at the branch by appointment. If you require a printed version of a Home Report, you will need to pay a reasonable production charge reflecting printing and other costs. 6. We are not able to offer an opinion either written or verbal on the content of these reports and this must be obtained from your legal representative. 7. Whilst we take care in preparing these reports, a buyer should ensure that his/her legal representative confirms as soon as possible all matters relating to title including the extent and boundaries of the property and other important matters before exchange of contracts.

Roger Platt is a trading name of Sequence (UK) Limited which is registered in England and Wales under company number 4268443, Registered Office is Cumbria House, 16-20 Hockliffe Street, Leighton Buzzard, Bedfordshire, LU7 1GN. VAT Registration Number is 500 2481 05.

roger platt



01628 773333



Maidenhead@rogerplatt.co.uk



25-29 Queen Street, MAIDENHEAD, Berkshire,
SL6 1NB



rogerplatt.co.uk