

RENT ME



ROEBUCK DRIVE, LAKENHEATH

£1,250 Per Month



3



1



1



D

# 3 Bedroom House - Mid Terrace located in Lakenheath

**\*\*AVAILABLE TO VIEW\*\*** 3 bedroom house in a residential area close to RAF Lakenheath. Hard flooring on ground floor, living room, kitchen with space for appliances, two double bedrooms and one single, bathroom with shower over bath, enclosed rear garden and off road parking - NO PETS - AVAIL MID APR

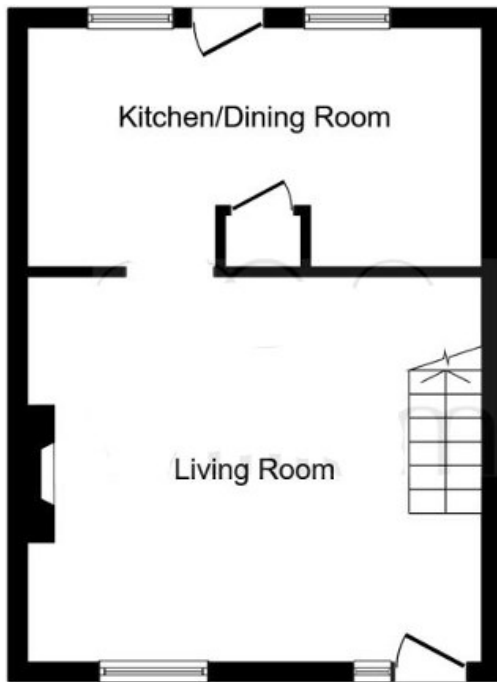

**Ground Floor**

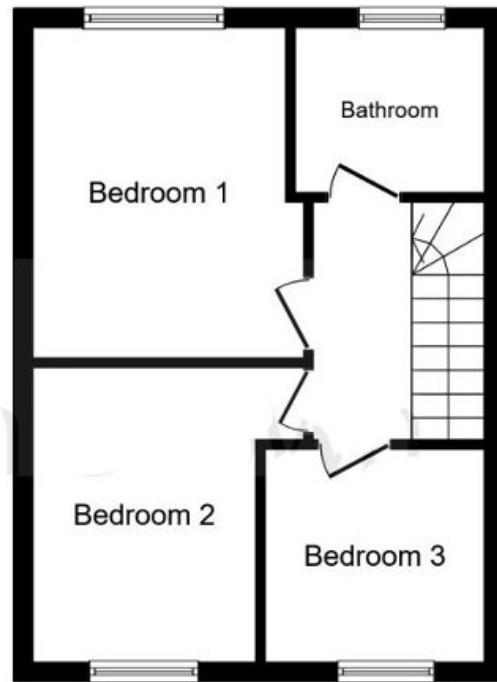

**First Floor**

This floor plan is for illustrative purposes only. It is not drawn to scale. Any measurements, floor areas (including any total floor area), openings and orientation are approximate. No details are guaranteed, they cannot be relied upon for any purpose and they do not form part of any agreement. No liability is taken for any error, omission or misstatement. A party must rely upon its own inspection(s).

Council Tax Band

**B**

Energy Performance Graph

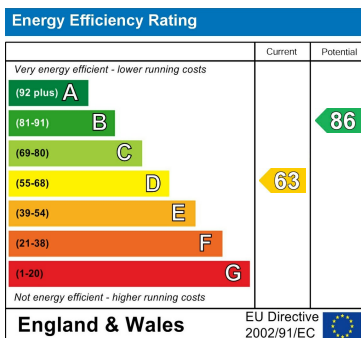

Call us on

**01638 551551**

**[enquiries@lodge-lettings.co.uk](mailto:enquiries@lodge-lettings.co.uk)**

**[www.lodge-lettings.co.uk](http://www.lodge-lettings.co.uk)**

Agents Note: Whilst every care has been taken to prepare these particulars, they are for guidance purposes only. All measurements are approximate and are for general guidance purposes only and whilst every care has been taken to ensure their accuracy, they should not be relied upon and potential buyers are advised to recheck the measurements.