

KIT JOHNSON

residential



Weston, Bath

£240,000

A Well Appointed Bungalow in this Popular Retirement Development. EPC Grade D



12A Sheppards Gardens
High Street
Weston
Bath
BA1 4DF

PRICE: £240,000

With a South facing aspect to the front, a ground floor bungalow apartment in this popular development off Weston High Street. The bungalow is accessed via either a staircase or a lift. The level garden accommodation includes a private entrance and porch, Living room, Bedroom, Wet Room and Kitchen with integrated Bosch appliances including washing machine / dryer, fridge freezer, dishwasher and oven. Of note is that both the bathroom and kitchen have windows, which is not common in this popular residence. There are excellent communal facilities which include a Laundry room, Gardens and a communal

Living room. Located in the heart of Weston Village, it's walking distance to all the local amenities such as Tesco and a choice of coffee shops, as well as bus routes into Bath. Being sold with vacant possession.

Bungalow Style Retirement Apartment

Private Entrance

One Bedroom

Wet Room

Fitted Kitchen

Communal Gardens

Residents Living Room

Leasehold

Council Tax Band B £1762

408 Sq Ft (37.9 Sq Ft)



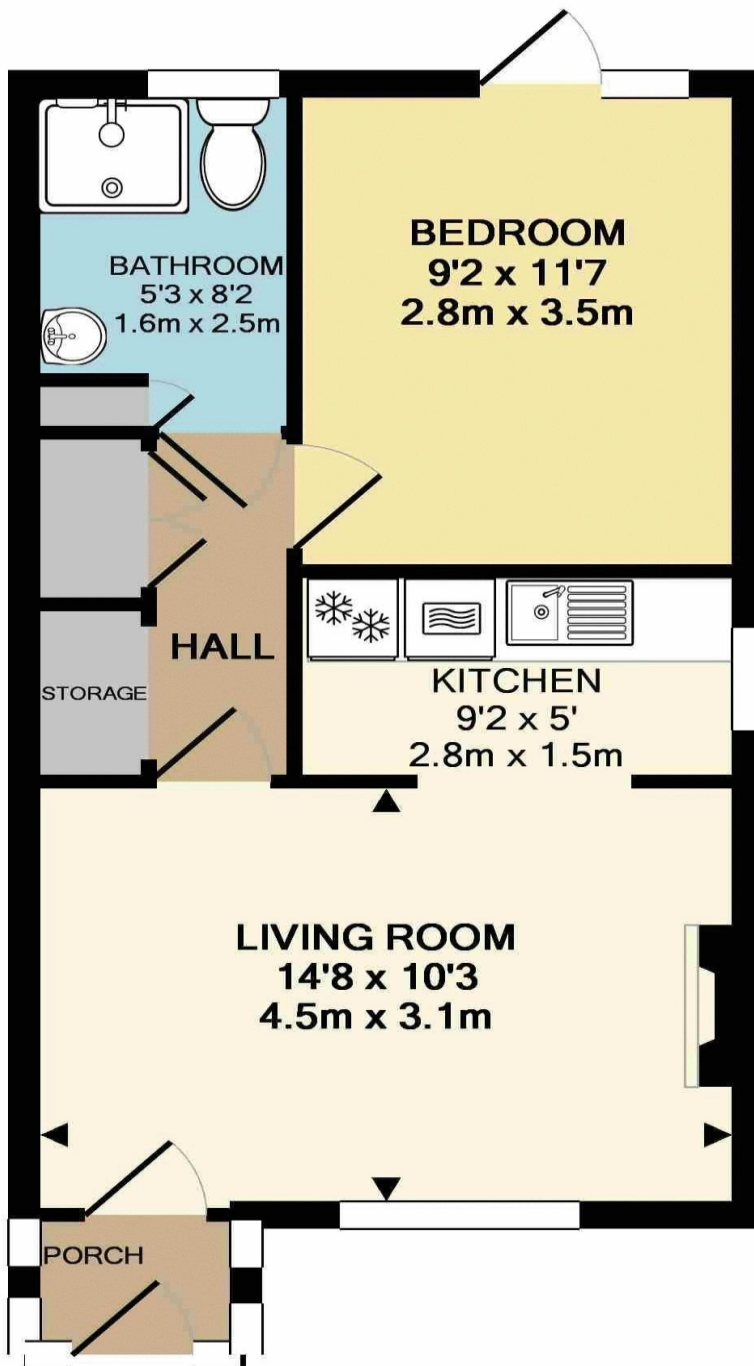

TOTAL APPROX. FLOOR AREA 408 SQ.FT. (37.9 SQ.M.)

All measurements of walls, doors, windows, fittings and appliances, their size and locations are approximate and cannot be regarded as being an accurate representation neither by the vendor nor their agent. www.inovusproperty.co.uk
 Made with Metropix ©2018

Kit Johnson Residential
26-33 High St
Weston
Bath
BA1 4BX
01225 444447
sales@kitjohnson.co.uk
www.kitjohnson.co.uk