



## St. Stephens Drive, Chatteris, Cambs, PE16 6EU

Detached Bungalow - 2 Bedrooms - Kitchen/Breakfast Room - Lounge/Diner - Conservatory - Bathroom - Enclosed Rear Garden - Garage & Driveway Parking - No Upward Chain - Call To View (01354) 696700

**£250,000**



**Porch**  
Double glazed entrance door and window to front, door to:

**Hallway**  
Storage cupboard, single radiator and doors to:

**Kitchen/Breakfast Room** 4.33m (14'2") max x 3.07m (10'1")  
Fitted with a matching range of base and eye level units with worktop space over, 1+1/2 bowl stainless steel sink, plumbing for washing machine, space for fridge/freezer and tumble dryer, built-in oven, built-in four ring gas hob with extractor hood over, double glazed window to rear, single radiator, tiled flooring and door to conservatory.

**Lounge/Diner** 5.49m (18') x 3.49m (11'5")  
Double glazed window to side, fireplace with gas connection, two single radiators and double glazed double doors to conservatory.

**Conservatory**  
4.81m x 1.90m  
UPVc construction, double doors to garden and door to side.

**Bedroom 1**  
3.49m (11'5") max x 3.49m (10'3")  
Double glazed window to front and single radiator.

**Bedroom 2**  
3.11m (10'2") x 2.66m (8'9") max  
Double glazed window to front, single radiator and built-in wardrobes.

**Bathroom**  
2.10m (6'11") x 1.66m (5'5")  
Fitted with three piece suite with comprising, panelled bath with shower over and curtain rail, pedestal wash hand basin and low-level WC, part tiled walls, double glazed window to side and radiator.

**Garage** 5.40m x 2.57m

With up and over door, electric and light and rear access from the garden.

**Outside**  
The property has driveway parking and garage. There is a lawn and planted borders to the front with side gate access to the enclosed rear garden which is laid to lawn, patio planted borders, rose archway, greenhouses and timber shed/summerhouse.

EPC Rating: TBC

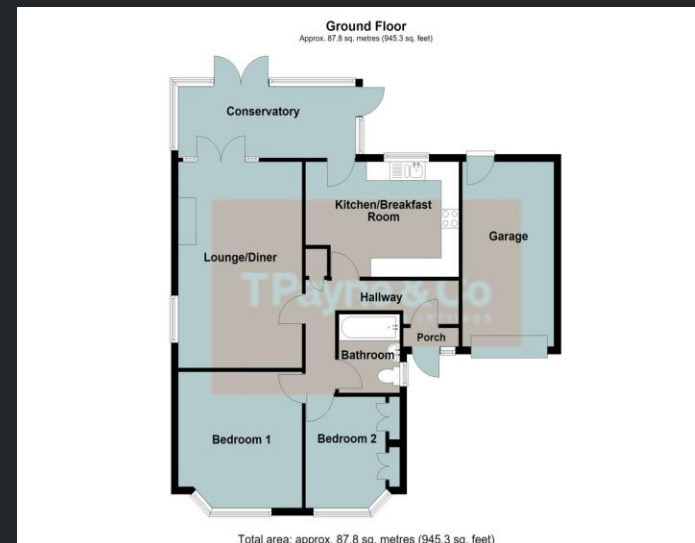

Call to arrange a viewing **01354 696700** **T Payne & Co**  
SALES & LETTINGS

Agents Notes: Whilst every care has been taken to prepare these sales particulars, they are for guidance purposes only. All measurements are approximate and for general guidance purposes only and whilst every care has been taken to ensure their accuracy, they should not be relied upon and potential buyers are advised to recheck the measurements.

