





52 Links Lane

Rowland's Castle, PO9 6AF

- PREMIER LINKS LANE LOCATION IN ROWLANDS CASTLE
- WALKING DISTANCE TO ROWLANDS CASTLE VILLAGE, GOLF CLUB AND MAINLINE STATION
- DETACHED DOUBLE GARAGE WITH GATED DRIVEWAY PARKING
- SEVEN BEDROOMS WITH FLEXIBLE FAMILY ACCOMMODATION
- STUNNING 35FT OPEN-PLAN KITCHEN / DINING / FAMILY ROOM
- OVER 4,700 SQ FT OF LUXURY ACCOMMODATION AND OUTBUILDINGS
- BEAUTIFULLY LANDSCAPED GROUNDS WITH SWIM SPA, HOT TUB, GAZEBO AND SUMMER HOUS
- PRINCIPAL SUITE WITH DRESSING ROOM AND LUXURY EN-SUITE
- EXTENSIVELY MODERNISED, EXTENDED AND RECONFIGURED IN 2019
- PLOT EXTENDING TO OVER HALF AN ACRE

Set behind electric gates within one of Rowlands Castle's most prestigious and sought-after addresses, this exceptional detached residence occupies a magnificent plot extending to over half an acre and offers in excess of 4,700 sq ft of beautifully appointed accommodation and outbuildings. Extensively modernised, reconfigured and enlarged in 2019, the property seamlessly combines impressive proportions, contemporary styling and outstanding versatility, creating a truly remarkable family home.



Approached via a sweeping gated driveway providing extensive parking, the property immediately impresses with its commanding frontage, detached double garage and immaculate presentation. Internally, the accommodation has been thoughtfully designed to suit modern family living, with a superb balance of formal and informal reception space.

At the heart of the home is a stunning open-plan kitchen, dining and family room extending to over 35 feet in length, beautifully appointed with a substantial central island, extensive cabinetry and ample space for entertaining on both an intimate and grand scale. Large glazed doors frame views across the gardens and provide seamless access onto the outdoor entertaining areas. Complementing this impressive space are a generous sitting room, substantial games room, study and practical utility room, all arranged around a welcoming entrance hall.

The first floor provides exceptional flexibility with seven bedrooms arranged to accommodate a variety of family requirements. The principal suite is particularly impressive, featuring a spacious bedroom, dressing room and luxurious en-suite bathroom. Three further bath/shower rooms serve the remaining bedrooms. The property's intelligent design allows Bedrooms Two and Three to be combined into an expansive suite if desired, whilst Bedrooms Five and Six can similarly be interconnected, creating adaptable accommodation ideal for larger families, guests, teenagers or multi-generational living.

Externally, the grounds are a particular feature of the property. Beautifully manicured lawns extend across the rear garden, creating a wonderful sense of privacy and seclusion. Designed for both relaxation and entertaining, the outdoor space incorporates a superb swim spa, hot tub, elegant gazebo and summer house, providing a resort-style setting that can be enjoyed throughout the year. Mature planting and established boundaries further enhance the feeling of exclusivity, while the detached double garage offers excellent storage and secure parking.

Large detached family homes of this scale, specification and presentation rarely become available within Links Lane. Combining a premier Rowlands Castle location, over 4,000 sq ft of luxurious living accommodation, exceptional grounds and a turnkey finish throughout, this is a truly outstanding home that must be viewed to be fully appreciated.





Coffee ☕

A light grey wooden sideboard with a wooden countertop. On the counter, there is a black coffee machine, a glass lantern with a candle, and a small chalkboard sign that says "COFFEE TIME".

A kitchen area featuring light grey cabinets, a wooden countertop, and a central island with a wooden top and grey upholstered bar stools. A black range hood is mounted above the stove. Two pendant lights hang over the island.

A dining table with a floral tablecloth and several grey chairs. A sign above the large glass doors reads "NOBODY GETS OUT SOBER". The view outside shows a green lawn and a gazebo.

A tall, narrow wooden cabinet or pantry unit with multiple shelves and drawers, located on the right side of the room.

Floor Plans

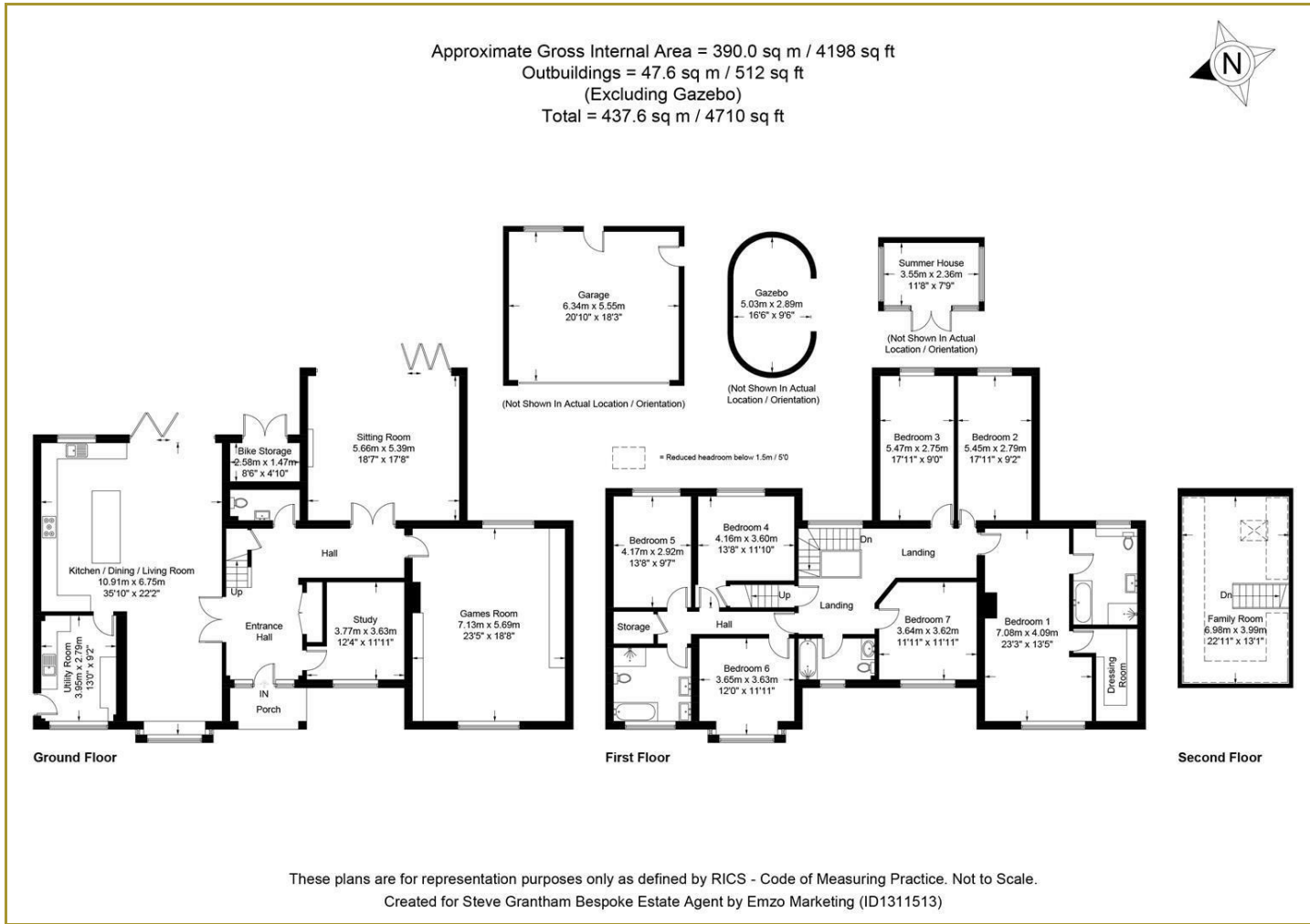

Location Map

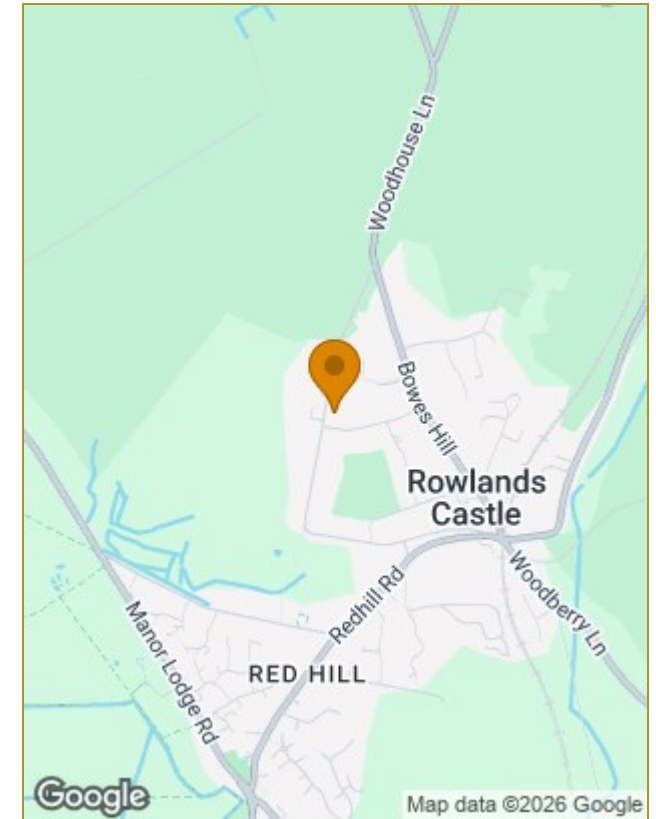

Energy Performance Graph

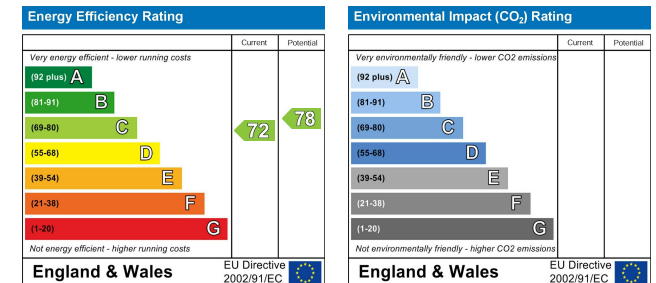

Should a purchaser(s) have an offer accepted on a property marketed by Steve Grantham Bespoke Estate Agent, they will need to undertake an identification check. This is done to meet our obligation under Anti Money Laundering Regulations (AML) and is a legal requirement. We use a specialist third party service to verify your identity. The cost of these checks is £30 Plus VAT per named purchaser, which is paid in advance, when an offer is agreed and prior to a sales memorandum being issued. This charge is non-refundable under any circumstances.

The particulars are set out as a general outline only for the guidance of intended purchasers or lessees, and do not constitute, any part of a contract. Nothing in these particulars shall be deemed to be a statement that the property is in good structural condition or otherwise nor that any of the services, appliances, equipment or facilities are in good working order. Purchasers should satisfy themselves of this prior to purchasing.