



25 Royal Drive, Fulwood, Preston, PR2 3AF

£925 Per Month

- 2 cosy bedrooms
- Spacious reception room
- Located in Fulwood, Preston
- Easy access to transport links
- 764 sq ft of living space
- Modern terraced house
- Built in 2004
- Close to local amenities
- Ideal for small families
- Viewing recommended

# 25 Royal Drive, Preston PR2 3AF

Nestled in the desirable area of Fulwood, Preston, this charming terraced house on Royal Drive offers a delightful blend of modern living and comfort. Built in 2004, the property spans an inviting 764 square feet, making it an ideal choice for first-time buyers, small families, or those seeking a low-maintenance home.

Upon entering, you are welcomed into a well-proportioned reception room, perfect for relaxing or entertaining guests. The space is filled with natural light, creating a warm and inviting atmosphere. The house features two comfortable bedrooms, providing ample space for rest and relaxation. The layout is thoughtfully designed to maximise the use of space, ensuring that every corner of the home is functional and welcoming.

The property also includes a well-appointed bathroom, designed with modern fixtures to cater to your daily needs. The terraced nature of the house offers a sense of community while still providing the privacy you desire.

Situated in Fulwood, you will benefit from a range of local amenities, including shops, schools, and parks, all within easy reach. The area is well-connected to public transport, making it convenient for commuting to Preston city centre and beyond.



Council Tax Band: B





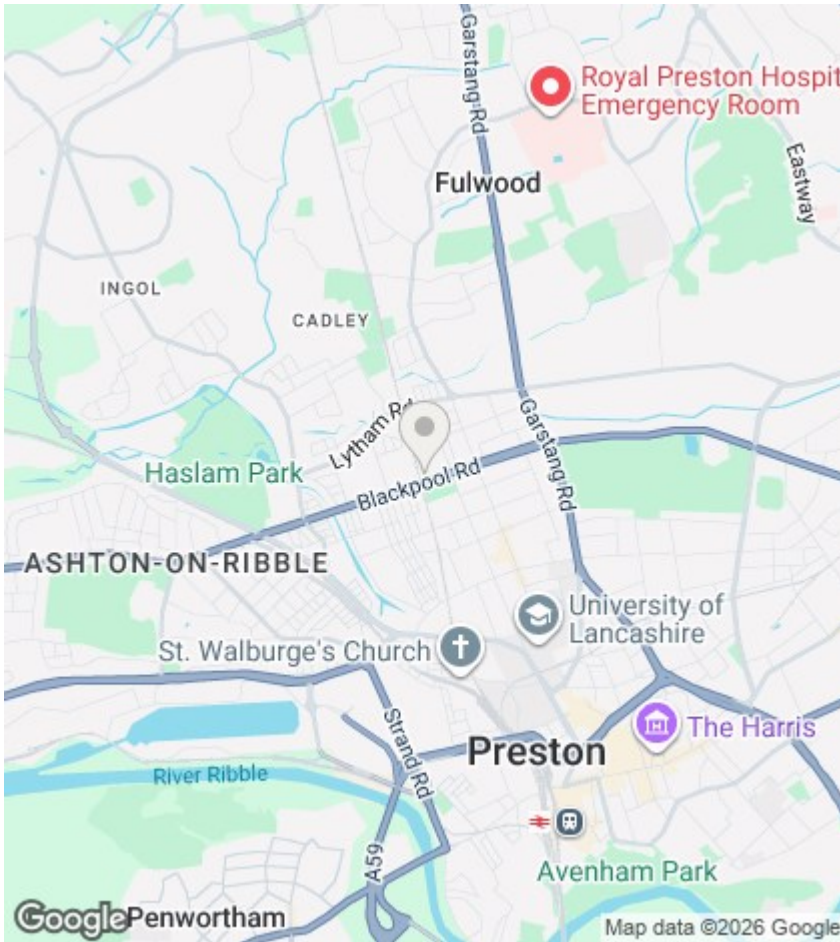

## Directions

## Viewings

Viewings by arrangement only. Call 01772 888 887 to make an appointment.

## EPC Rating:

C

Energy Efficiency Rating		Current	Potential
Very energy efficient - lower running costs			
(92 plus) A			
(81-91) B			
(69-80) C		73	
(55-68) D			
(39-54) E			
(21-38) F			
(1-20) G			
Not energy efficient - higher running costs			
England & Wales		EU Directive 2002/91/EC	

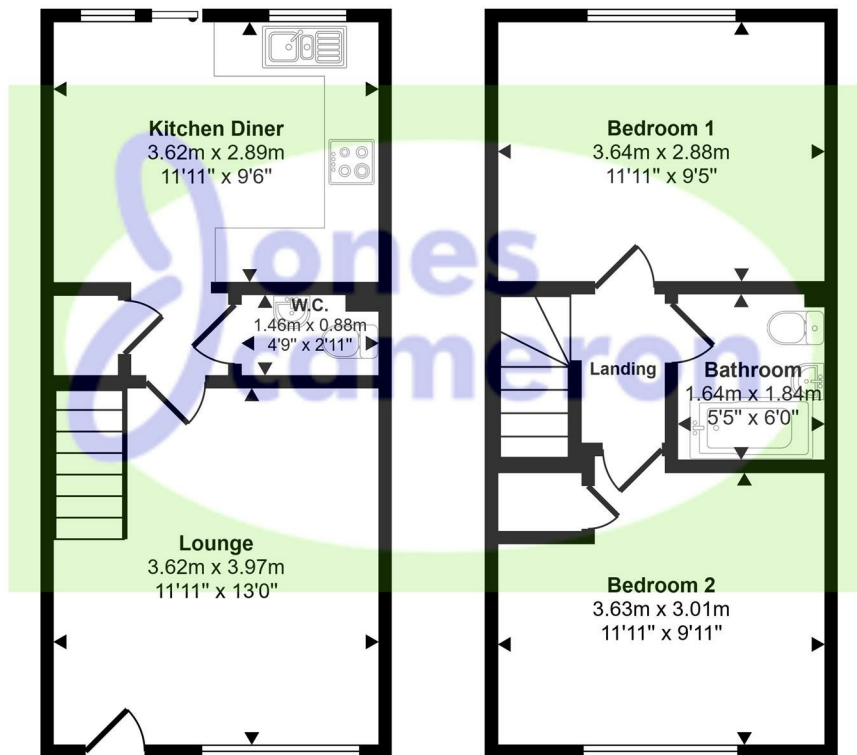

Ground Floor  
Approx 29 sq m / 313 sq ft

First Floor  
Approx 29 sq m / 315 sq ft