



Stoneycroft Close, SE12

£235,000

A well-presented first floor flat offering bright and spacious accommodation throughout. The property comprises a generous reception room, a separate kitchen, a recently renovated bathroom, and a well-proportioned double bedroom.

Further benefits include off street parking and no onward chain, making it an ideal first-time purchase or investment opportunity.

The property is conveniently located from transport links such as Lee and Hither Green stations all within walking distance, it is also close to local amenities, local shops and leisure facilities.

Features

- Ideal For Lee Station
- Long Lease
- Double Glazing
- Gas Central Heating
- Large Lounge
- Modern Kitchen

Stoneycroft Close, London, SE12

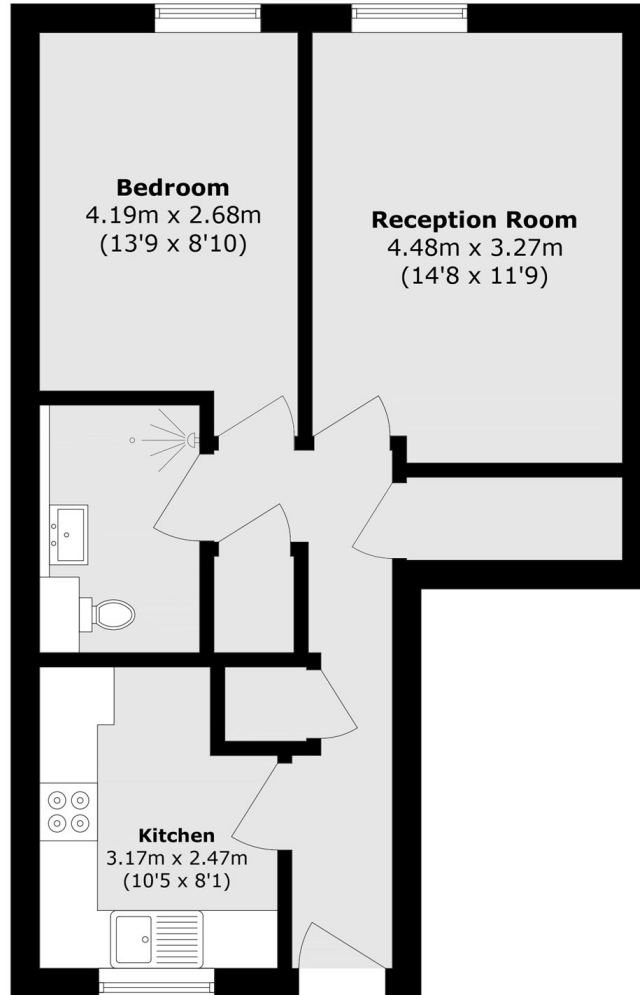

Total area (approx.): 48.6 sq. m (523.1 sq. ft)