



Rugby Road, Hampshire, PO5 1SH
Asking Price £370,000

This beautiful END OF TERRACE property, in the heart of Portsmouth, is not to be missed!

Perfectly situated, this property is close to the town centre, shops, bars, cafes and bus routes and close to the seafront too.

The property boasts (at present) five double bedrooms, kitchen / dining area, hard standing / courtyard garden AND A GARAGE! The bedroom spaces can easily accommodate reception and/or living spaces and can be easily adapted to your every need.

The property is CHAIN FREE, VACANT and ready for new owners!

Rugby Road, Hampshire, PO5 1SH

Kitchen 9'1" x 9'8" (2.78 x 2.96)

Dining room 11'11" x 12'7" (3.65 x 3.86)

WC 2'4" x 4'8" (0.72 x 1.43)

Bedroom 4 9'6" x 10'5" (2.90 x 3.20)

Bedroom 5 10'6" x 12'7" (3.21 x 3.85)

Bathroom 5'6" x 6'10" (1.69 x 2.09)

Bedroom 1 10'6" x 12'7" (3.21 x 3.86)

Bedroom 2 9'1" x 9'11" (2.79 x 3.04)

Bedroom 3 10'2" x 6'8" (3.10 x 2.05)

Ground Floor

Approx. 63.7 sq. metres (685.5 sq. feet)



First Floor

Approx. 52.3 sq. metres (562.8 sq. feet)

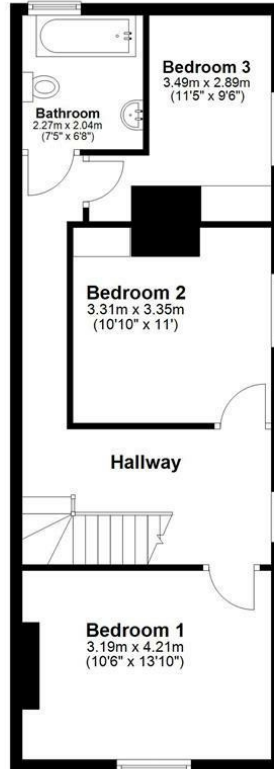

Total area: approx. 116.0 sq. metres (1248.4 sq. feet)

