

**Upvc Front Door to:**

**ENTRANCE HALL**

Electric night storage heater.

**LOUNGE**

**4.47m x 3.40m (14'8" x 11'2")**

Understairs cupboard. Upvc double glazed window.



**KITCHEN**

**2.13m x 2.01m (7'0" x 6'7")**

Inset stainless steel sink and drainer. Base cupboards with worktops. Matching wall cupboards. Electric cooker point. Upvc double glazed window. **Upvc double glazed rear door.**



**FIRST FLOOR:**



**BATHROOM**

Bath, handbasin and wc in white. Upvc double glazed window.

**BEDROOM ONE**

**4.37m x 2.13m** (11'4" x 7'0")

Fitted wardrobes and dressing table. Upvc double glazed window.



**BEDROOM TWO**

**2.74m x 2.21m** (9'0" x 7'3")

Upvc double glazed window.

**FLOOR PLAN:**

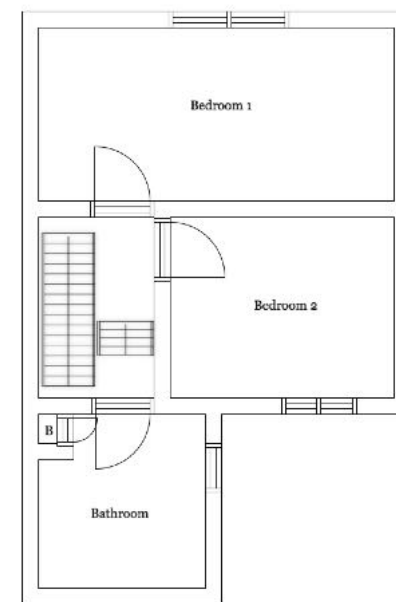
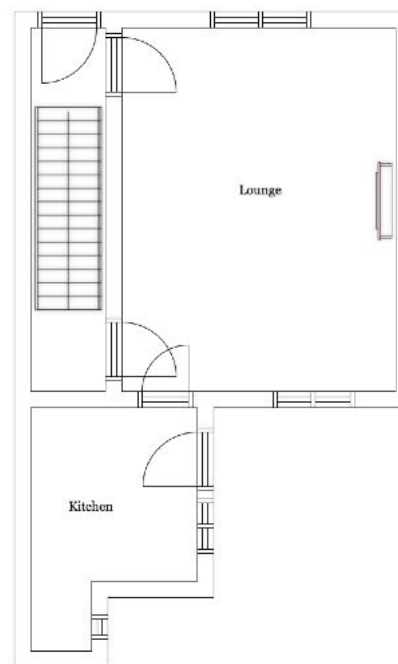

**OUTSIDE:**

Rear yard.



**Council Tax Band**      **A.**

**DIRECTIONS:**

From the DMA office follow the one-way system round turning right onto Station Avenue. Turn left at the chapel clock onto Union Street and then left at the end onto Mitford Street. Turn immediately right onto Providence Place and then left at the end onto Queen Street. Ebenezer Terrace is on the right opposite the museum.

**Viewing strictly by appointment only through DMA Estate Agents**

## OFFICE HOURS:

Monday to Friday	9 am	to	5 pm
Saturday	9 am	to	3 pm
Sunday and Bank Holidays	12 noon	to	2 pm



Zoopla.co.uk

## 10 good reasons to choose DMA

- \* Open 7 days a week.
- \* Prompt efficient service.
- \* Coloured photographic details.
- \* Free advertising: no sale - no charge.
- \* Filey's locally owned independent estate agency.
- \* Free market valuation.
- \* Free accompanied viewing.
- \* Computerised mailing list.
- \* Prominent town centre location.
- \* Modern walk-round self selection display.

RESIDENTIAL  
SALES

**DMA** ESTATE  
AGENTS

COMMERCIAL  
SALES

Proprietors: David Mansfield ATTON FNAEA. Elaine ATTON  
Gavin Ashley Mansfield ATTON MNAEA / DEA.  
[www.dmaestateagents.co.uk](http://www.dmaestateagents.co.uk)

ESTABLISHED 1992



These particulars are intended only to give a fair description of the property, as a guide to prospective buyers. Accordingly a) their accuracy is not guaranteed and neither DMA Estate Agents nor the vendor(s) accept any liability in respect of their contents; b) they do not constitute an offer or contract of sale, and c) any prospective purchaser should satisfy themselves by inspection or otherwise as to the correctness of any statement or information in these particulars.

# DMA

ESTATE  
AGENTS



7 EBENEZER TERRACE, FILEY YO14 9EZ



Freehold £100,000

### FEATURES

- \* In need of modernisation.
- \* Ideal for first time buyers or holiday home.
- \* Two bedroom terraced house.
- \* Located close to the town centre and convenient for most amenities.
- \* Upvc double glazed windows.
- \* Electric night storage heating.
- \* Sold with no onward chain.
- \* Rear yard.
- \* EPC Rating: G.
- \* Viewing recommended.

### ACCOMMODATION IN BRIEF

GROUND FLOOR: Upvc Front Door to Entrance Hall. Lounge. Kitchen.  
FIRST FLOOR: Two Bedrooms. Bathroom.  
OUTSIDE: Rear yard.

26 Belle Vue Street, FILEY, North Yorks. YO14 9HY. Telephone / Fax: 01723 515527  
[www.dmaestateagents.co.uk](http://www.dmaestateagents.co.uk) / [www.rightmove.co.uk](http://www.rightmove.co.uk)