



Hunters Drive, Dinnington, S25 2TG

£180,000

🛏️ 2 🍳 1 🚗 1



This effectively extended and immaculately presented two-bedroom semi-detached home offers an excellent opportunity for first-time buyers or those looking for a stylish property ready for immediate occupation. Situated on a popular residential development in the sought-after village of Throapham, the home enjoys a pleasant setting while remaining conveniently positioned for local amenities, schools and transport links. The accommodation is well arranged and thoughtfully improved by the current owners. In brief, the property comprises an entrance porch leading into a beautifully presented living room, creating a warm and inviting space for relaxation. To the rear, the property has been extended to provide a spacious kitchen and dining area, offering a modern and practical space ideal for everyday family living and entertaining. To the first floor, a landing with loft access leads to a well-proportioned master bedroom, a further bedroom and a modern family bathroom finished to a contemporary standard. Externally, the property benefits from a driveway to the front providing off-street parking. To the rear is an enclosed garden designed for ease of maintenance, offering a pleasant outdoor space complete with a summer house, ideal for relaxing, hobbies or additional storage. Further benefits include gas central heating and double glazing throughout.

The charming village of Throapham is a small and picturesque rural community located just outside the town of Dinnington. Surrounded by open countryside and farmland, Throapham offers a peaceful setting with a traditional village feel, making it particularly attractive to buyers seeking a quieter lifestyle while still remaining within easy reach of everyday amenities.

Throapham is known for its scenic surroundings, historic character and strong sense of community. The area provides pleasant country walks and green open spaces, creating an appealing environment for those who enjoy outdoor living. Despite its tranquil setting, the village benefits from its close proximity to Dinnington, ensuring residents have convenient access to a wide range of facilities.

Just a short drive away, Dinnington offers an excellent selection of local shops, supermarkets, cafés, pubs and restaurants, along with primary and secondary schools, healthcare services and leisure facilities. The town also provides good transport connections to



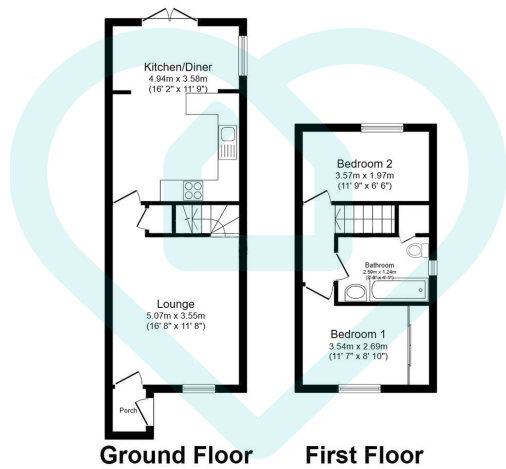

Total floor area 62.8 sq.m. (676 sq.ft.) approx

This floor plan is for illustrative purposes only. All measurements and layouts are approximations and do not necessarily capture the precise specifications of the property. No responsibility is taken for any error, omission, or misstatement. We always recommend viewing in person to confirm the exact floor plan of a property. Made with Metropix.



- Located in the peaceful rural village of Throapham
- Enjoys a traditional village feel with a strong community atmosphere
- Just a short distance from the nearby town of Dinnington
- Good choice of nearby primary and secondary schools
- Excellent road links for commuters travelling across South Yorkshire and Nottinghamshire
- Surrounded by attractive open countryside and farmland
- Ideal location for those seeking a quieter, semi-rural lifestyle
- Dinnington offers a range of shops, supermarkets, cafés and local amenities
- Convenient access to Rotherham, Sheffield and Worksop
- A desirable balance of countryside living with everyday convenience

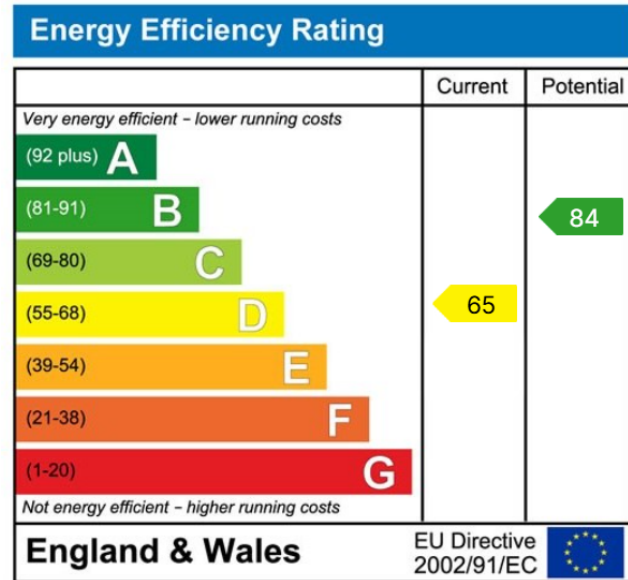

Sales | Lettings | New Homes

VAT Reg Number: 191 3588 84
 Company Reg Number: 08610489
 Company Reg Address: 67 Middlewood Road, Hillsborough, Sheffield, S6 4GX.

The MorfittSmith Building
 67 Middlewood Road
 Hillsborough
 Sheffield
 S6 4GX

Get in touch - arrange an appointment



0114 232 1764



sales@morfittsmith.co.uk
 lettings@morfittsmith.co.uk
 newhomes@morfittsmith.co.uk



www.morfittsmith.co.uk



@MorfittSmith



@MorfittSmith



MorfittSmith
 Estate & Letting Agent