

Fahren
ESTATE AGENTS



Flat 3, Edmondsham House, Terrace Road, Bournemouth, BH2 5NJ
Guide Price £100,000 Leasehold

AUTHENTIC ~ PASSIONATE ~ PROFESSIONAL
Tel: 01202 551022 | Email: castlelane@fahren.co.uk | Web:
www.fahren.co.uk

Terrace Road, Bournemouth

Guide Price £100,000

Town centre location | One bedroom flat | Living room | Modern kitchen | Shower room | Double bedroom | Ground floor | Ideal investment | Vacant! | Contact us to book a viewing



0



Apartment



1



323 sqft (30 sqm)



1



Leasehold





Terrace Road, Bournemouth

Guide Price £100,000

Fahren Estate Agents are pleased to offer for sale this town centre one bedroom apartment, within walking distance to Bournemouth's wide range of shops and the BH2 entertainment complex.

Located on the ground floor of a character building close to Bournemouth town centre, this modern one bedroom flat offers a modern living room with dual aspect windows, light and bright bedroom, modern kitchen and shower room. The property has recently been redecorated.

The property is currently vacant with no forward chain so it would make an ideal lettings investment or first home.

Lease length - 106 years (125 from 2005)

Leasehold

Ground rent- £75 half yearly (£150 per annum)

Service charge -£978.87 half yearly (£1,957.74 per annum)

Council Tax Band A

EPC E

Mains electricity

No gas connection

Fahren

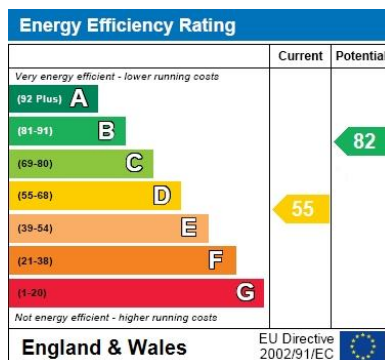

Connect with us



If you would like to book a viewing or find out how much your property is worth please contact us

Tel: 01202 551022

Email: inf@fahren.co.uk

Web: www.fahren.co.uk





GROUND FLOOR
323 sq.ft. (30.0 sq.m.) approx.

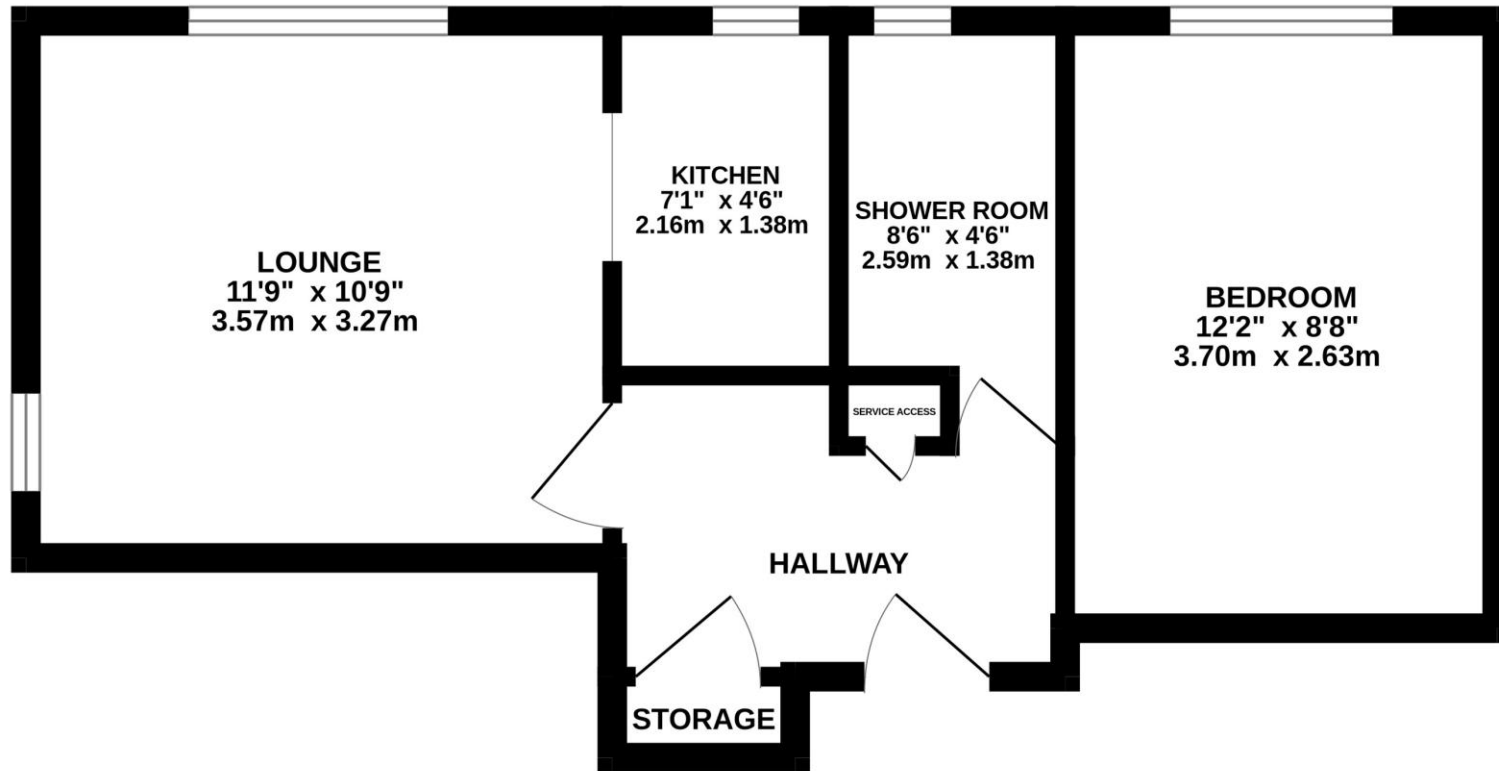

TOTAL FLOOR AREA : 323 sq.ft. (30.0 sq.m.) approx.

Whilst every attempt has been made to ensure the accuracy of the floorplan contained here, measurements of doors, windows, rooms and any other items are approximate and no responsibility is taken for any error, omission or mis-statement. This plan is for illustrative purposes only and should be used as such by any prospective purchaser. The services, systems and appliances shown have not been tested and no guarantee as to their operability or efficiency can be given.

Made with Metropix ©2024