



Coppetts Road, N10

£300,000

Situated on the ground floor of this apartment complex is a modern finished, two bedroom flat with an open plan kitchen/ reception room. This apartment also benefits from double glazing throughout and an allocated off street parking space.

Gilson Place is situated within easy reach of shops and amenities in Muswell Hill with excellent green spaces including Alexandra Park close by. The development is within catchment areas for outstanding schools

Features

- Two Double Bedrooms
- Double Glazing
- Ground Floor
- Allocated Parking
- Long Leasehold
- Gated Development

Coppetts Road, London, N10

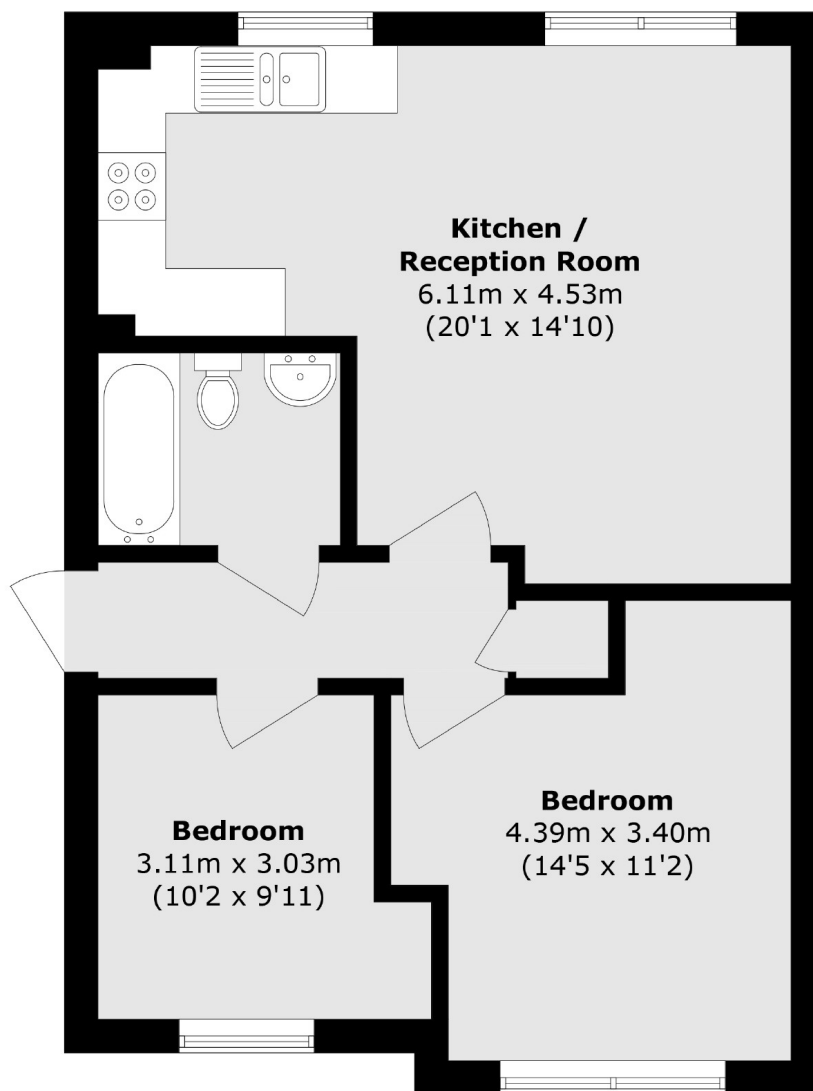

Total area (approx.): 53.3 sq. m (573.7 sq. ft)