



**Taylor's**

# KINGSWINFORD, 'Marylyn' Broad Street

£240,000

🛏️ 3 🚿 1 🚗 2



**Broad Street offers a sought after location, which is within easy reach from village shops, Primary and Secondary Schools. The DECEPTIVELY LARGE layout is WELL PRESENTED and ATTRACTIVELY APPOINTED throughout. With GAS CENTRAL HEATING, UPVC DOUBLE GLAZING, the accommodation comprises: entrance hall, front lounge with 'walk in' bay window, separate dining room, 'open plan' and through to the SPACIOUS FITTED KITCHEN with integrated hob and oven. To the first floor is THREE BEDROOMS and a modern fitted bathroom with shower. To the rear of the property is a LARGE 'SUNNY' GARDEN, which comprises of the paved patio with gated access to the shared side entrance. The patio leads onto the large lawn with side borders and shed, beyond which is a further garden area.**

**Ideal for families, first time buyers and landlords, the property is very well located within the heart of Kingswinford, a short walk to shops, pubs, Primary and Secondary Schools. There is also easy access to Stourbridge town and the Merry Hill Shopping Centre.**

**Tenure: FREEHOLD. Construction: standard brick walls and tiled/ flat roof. Services: All main services are connected. Broadband/Mobile coverage: Visit: [checker.ofcom.org.uk/en-gb/broadband-coverage](http://checker.ofcom.org.uk/en-gb/broadband-coverage). Current Flood Risk Assessment: Low. Council Tax Band B. EPC D. KINGSWINFORD OFFICE.**

**Entrance Hall -**

**Lounge - 3.91m x 3.07m (12'10" x 10'1")**

**Dining Area - 4.01m x 3.25m (13'2" x 10'8")**

**Kitchen - 4.65m x 2.59m (15'3" x 8'6")**

**Bedroom 1 - 4.09m x 3.1m (13'5" x 10'2")**

**Bedroom 2 - 3.28m x 3.17m (10'9" x 10'5") max.**

**Bedroom 3 - 2.29m x 1.96m (7'6" x 6'5")**

**Bathroom - 1.88m x 1.12m (6'2" x 3'8") + 2.1m x 1.49 (6'11" x 4'11")**





- PERIOD MID TERRACED HOME
- NO UPWARD CHAIN
- THREE BEDROOMS
- LOUNGE WITH 'BAY' WINDOW
- 'OPEN PLAN' DINING KITCHEN
- MODERN FIRST FLOOR BATHROOM
- SMALL BLOCK PAVED DRIVEWAY
- LARGE 'SUNNY' REAR GARDEN
- CENTRAL VILLAGE LOCATION
- GAS CENTRAL HEATING & UPVC DOUBLE GLAZING

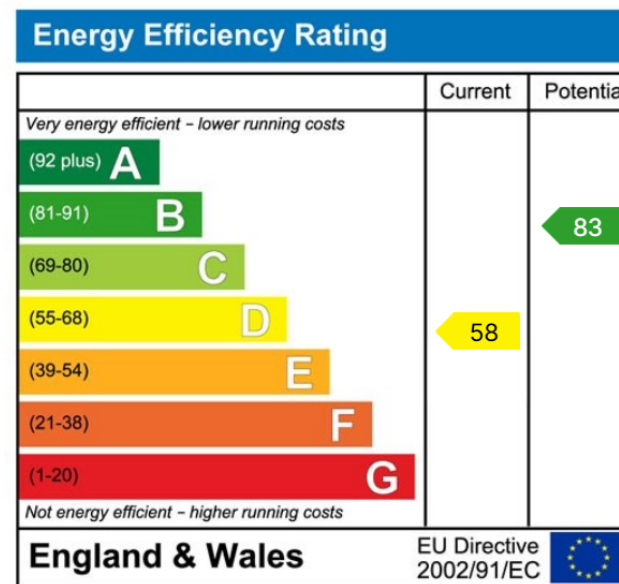
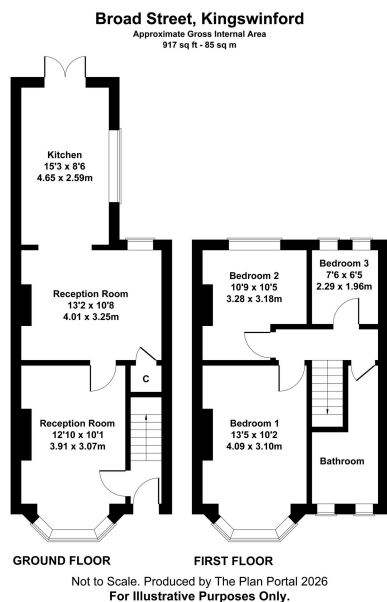

**MISREPRESENTATION ACT 1967:** These particulars do not constitute any part of an offer or a contract. Whilst every care is taken to ensure accuracy, no responsibility for errors or misdescription is accepted. Any intending purchaser must satisfy themselves by inspection or otherwise as to the correctness of each of the statements in these particulars. The vendor does not make nor give, and neither Taylors nor any person in their employment has any authority to make or give any representation or warranty whatsoever about this property. As the seller's estate agents, we are not surveyors or conveyancing experts, and we cannot comment on the property's condition or issues relating to the title or other legal issues that may affect this property unless we have been made aware of such matters. Interested parties should employ professionals to make such enquiries before making transactional decisions. **EPC:** can be supplied free of charge. **CONSUMER PROTECTION REGULATIONS (2008):** These particulars have been prepared with care and approved by the vendors (where possible) but are intended as a guide only, with measurements being approximate and usually the maximum size, which may include alcoves, recesses or otherwise as described, and you must NOT rely on them for any other purpose. The appearance of an item in any photograph does not mean that it forms part of the property or sale price. **FIXTURES AND FITTINGS:** Only those items specifically mentioned in these sales particulars are included in the sale price. Taylors have NOT tested any apparatus, equipment, fixture or fitting and cannot verify they are in working order or fit for their purpose. **PLANNING PERMISSION / BUILDING REGULATIONS:** Any reference to the property being extended, altered or converted in any way does not infer that planning permission or building regulations have been granted or applied for, nor do Taylors accept any responsibility for such not having been obtained. **FLOOR PLAN:** This plan is for illustrative purposes only. The services, systems and appliances shown have not been tested and no guarantee as to their operability or efficiency can be given.