



Breydon Way, Ipswich, IP3 9GA

welcome to

Breydon Way, Ipswich

This well-presented, 1st floor apartment benefits from two large double bedrooms, an open plan lounge/diner with Juliet balcony, a good-size kitchen, a master bedroom with Juliet balcony and one parking space.

Entrance Hall

Carpet flooring, an airing cupboard, one electric radiator and loft hatch.

Lounge/Diner

Large, open plan room with a Juliet balcony to the front, two double glazed windows to the front, TV point, electric radiators and carpet flooring.

Kitchen

Tiled effect flooring, eye and base level units in white with marble effect worktop surfaces, white tiled splashback, a sink plus drainer and chrome mixer tap, space for a washing machine and fridge/freezer, an integrated oven with induction hob and two double glazed windows to the rear.

Master Bedroom

A Juliet balcony to the rear, a built in wardrobe, carpet flooring and one electric radiator.

Bedroom Two

Double glazed window to the rear, carpet flooring and one electric radiator.

Bathroom

Low level WC, wash hand basin, a bath with shower attachment, shaver point, part tiled walls, wood effect flooring, double glazed window to the front, extractor fan and an electric heated towel rail.

Parking

One parking space.

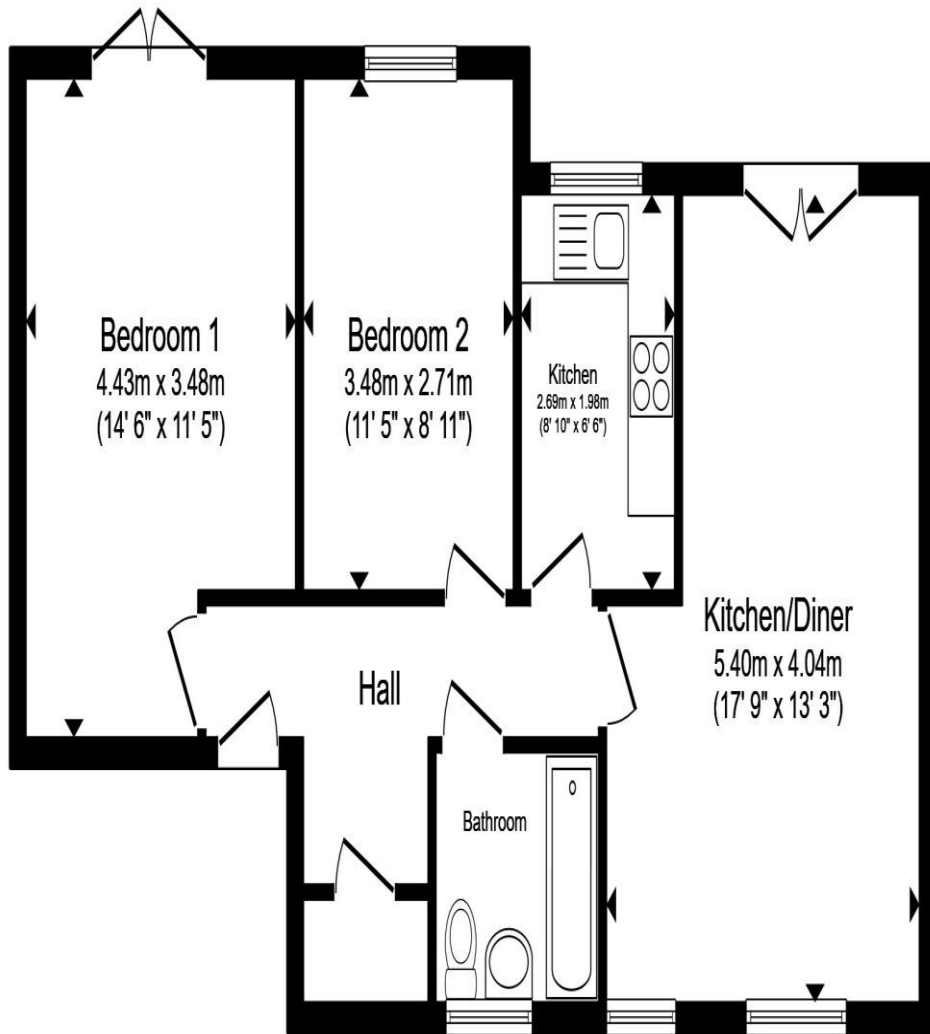

Total floor area 61.8 m² (665 sq.ft.) approx

This floor plan is for illustrative purposes only. It is not drawn to scale. Any measurements, floor areas (including any total floor area), openings and orientation are approximate. No details are guaranteed, they cannot be relied upon for any purpose and they do not form part of any agreement. No liability is taken for any error, omission or misstatement. A party must rely upon its own inspection(s). Powered by www.propertybox.io



welcome to
Breydon Way,
Ipswich

- Two large double bedrooms
- Open plan lounge/diner with Juliet balcony
- Good-size kitchen
- Master bedroom with Juliet balcony
- One parking space

Tenure: Leasehold EPC Rating: C

Council Tax Band: B Service Charge: 1424.00

Ground Rent: 150.00

This is a Leasehold property. We are awaiting further details about the Term of the lease. For further information please contact the branch. Please note additional fees could be incurred for items such as Leasehold packs.

£150,000



view this property online williamhbrown.co.uk/Property/IPS121147



Property Ref:
IPS121147 - 0003

1. MONEY LAUNDERING REGULATIONS Intending purchasers will be asked to produce identification documentation at a later stage and we would ask for your co-operation in order that there is no delay in agreeing the sale. 2. These particulars do not constitute part or all of an offer or contract. 3. The measurements indicated are supplied for guidance only and as such must be considered incorrect. Potential buyers are advised to recheck measurements before committing to any expense. 4. We have not tested any apparatus, equipment, fixtures or services and it is in the buyers interest to check the working condition of any appliances. 5. Where an EPC, or a Home Report (Scotland only) is held for this property, it is available for inspection at the branch by appointment. If you require a printed version of a Home Report, you will need to pay a reasonable production charge reflecting printing and other costs. 6. We are not able to offer an opinion either written or verbal on the content of these reports and this must be obtained from your legal representative. 7. Whilst we take care in preparing these reports, a buyer should ensure that his/her legal representative confirms as soon as possible all matters relating to title including the extent and boundaries of the property and other important matters before exchange of contracts.

William H Brown is a trading name of Sequence (UK) Limited which is registered in England and Wales under company number 4268443, Registered Office is Cumbria House, 16-20 Hockliffe Street, Leighton Buzzard, Bedfordshire, LU7 1GN. VAT Registration Number is 500 2481 05.



william h brown



01473 226101



ipswich@williamhbrown.co.uk



16-18 Wolsey House, Princes Street, IPSWICH,
Suffolk, IP1 1QT



williamhbrown.co.uk