



**POOLE
TOWNSEND**

25 Highfield Road, Grange over Sands, Cumbria, LA11 7JB

£595,000

🛏️ 2 🚿 1 🚗 1



- Situated on the highly sought-after Highfield Road in a prestigious coastal enclave
- Enjoy attractive views across the bay
- Offers a rare opportunity for homeowners, developers, and investors alike
- Permission allows for the construction of a separate two to three-bedroom dwelling
- Ideal for multi-generational living with space for an additional home
- Charming two-bedroom detached property
- Set within generous and well-proportioned gardens
- Outline planning permission already granted within the grounds
- Excellent potential for development while retaining the existing property
- Creates an opportunity for investment



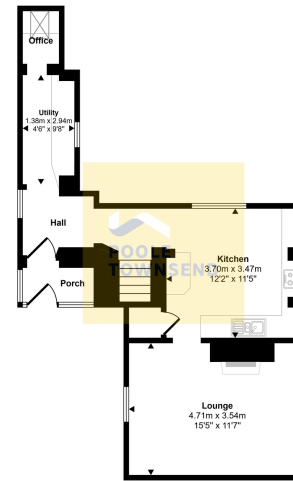

Ground Floor
Approx 48 sq m / 516 sq ft

This floorplan is only for illustrative purposes and is not to scale. Measurements of rooms, doors, windows, and any items are approximate and no responsibility is taken for any error, omission or mis-statement. Items of items such as bathroom suites are representations only and may not look like the real items. Made with Made Shippy 360.

Nestled on the prestigious Highfield Road, this charming two-bedroom detached cottage enjoys views across the bay and offers a unique blend of character and potential, set within generous gardens. The property presents an exciting opportunity for a range of buyers, with outline planning permission already granted for the erection of a separate two to three-bedroom dwelling within the grounds. This opens up excellent scope for development, multi-generational living or the creation of a standalone investment opportunity, all while retaining the appeal and charm of the existing cottage.

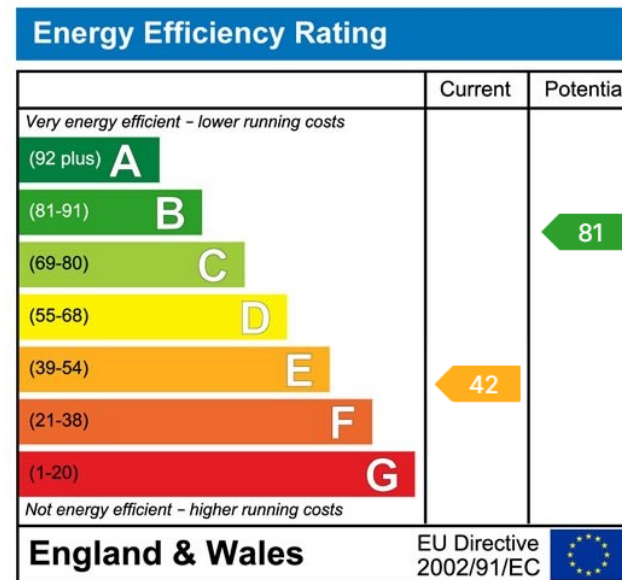

Visit us at
www.pooletownsend.co.uk
enquiries@pooletownsend.co.uk

We are open
 Monday – Friday 9.00 – 5.00
 Saturday 9.00 – 1.00

Barrow 01229 811811
 Ulverston 01229 588111
 Grange 015395 33316
 Kendal 01539 734455
 Milnthorpe 015395 62044