

Living
made
better

Torre Vista
Lewisham, SE13 7FT



1



1



1



B

£1,700 PCM

Torre Vista, Lewisham, SE13 7FT

Madison Brook

Property Summary

This well-presented one-bedroom apartment is situated on the third floor of Torre Vista within Renaissance Development. Offering approximately 462 sq ft of bright, modern living space, the property features an open-plan kitchen and reception room with integrated appliances and direct access to a private balcony overlooking the communal gardens. The apartment further comprises a generous double bedroom, a contemporary bathroom suite and useful hallway storage. Residents benefit from a 24-hour concierge service, communal roof terrace and landscaped surroundings.

Ideally located moments from Lewisham Station (DLR and National Rail), the property offers excellent connections.

Floorplan

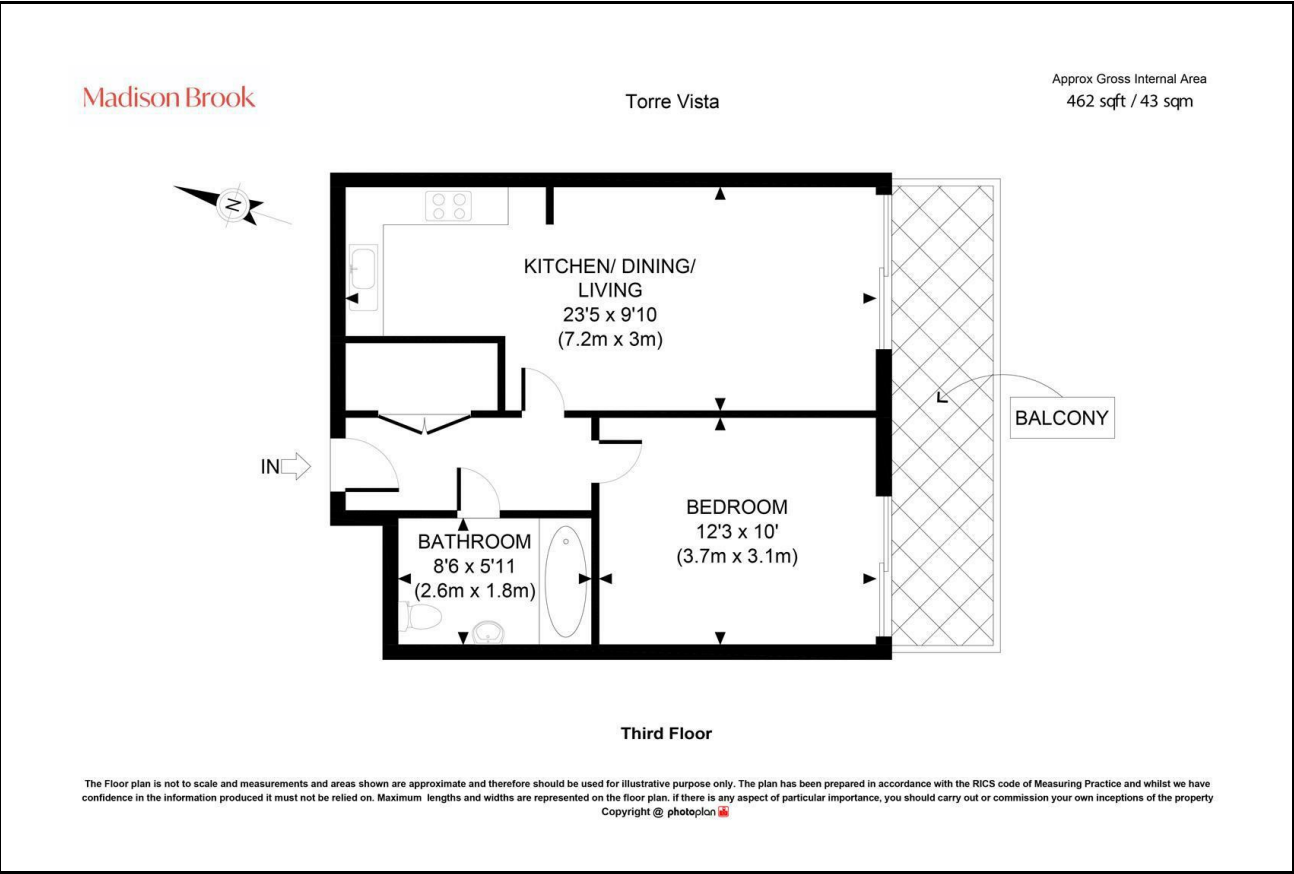

These particulars, whilst believed to be accurate are set out as a general outline only for guidance and do not constitute any part of an offer or contract. Intending purchasers should not rely on them as statements of representation of fact, but must satisfy themselves by inspection or otherwise as to their accuracy. No person in this firms employment has the authority to make or give any representation or warranty in respect of the property.

Area Map

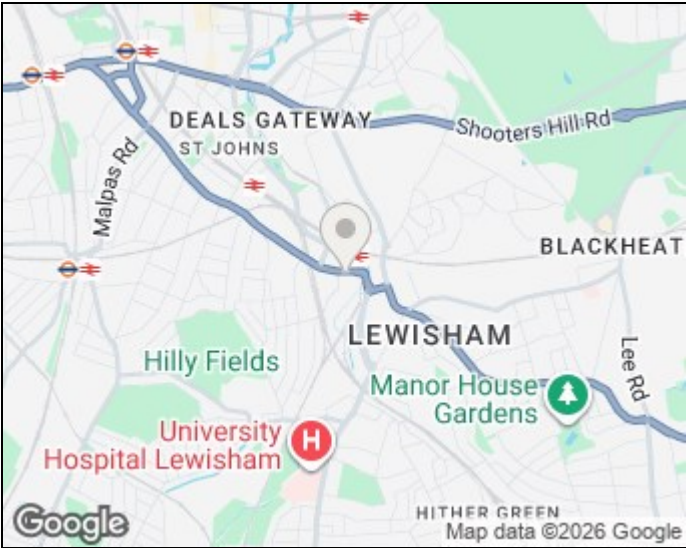

Energy Efficiency Graph

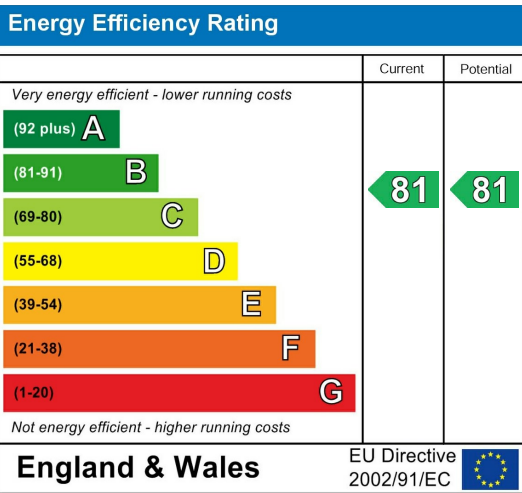

43 Loampit Vale, Lewisham, London, SE13 7FT
Tel: 020 3946 6200 Email: lewisham@madisonbrook.com
<https://madisonbrook.com/>