



Doverdale Close, Redditch B98 7SB

welcome to

Doverdale Close,Redditch

*** END-TERRACE PROPERTY *** BEAUTIFULLY PRESENTED THROUGHOUT *** NO CHAIN *** NEWLY RENOVATED *** THREE BEDROOMS ***
DOWNSTAIRS TOILET *** FAMILY BATHROOM *** SECURE REAR GARDEN ***



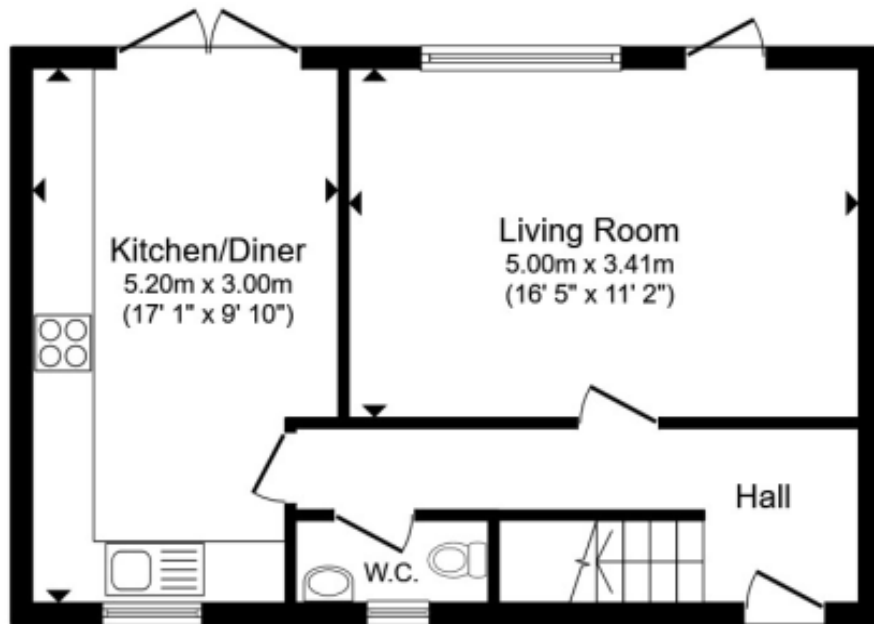

Ground Floor

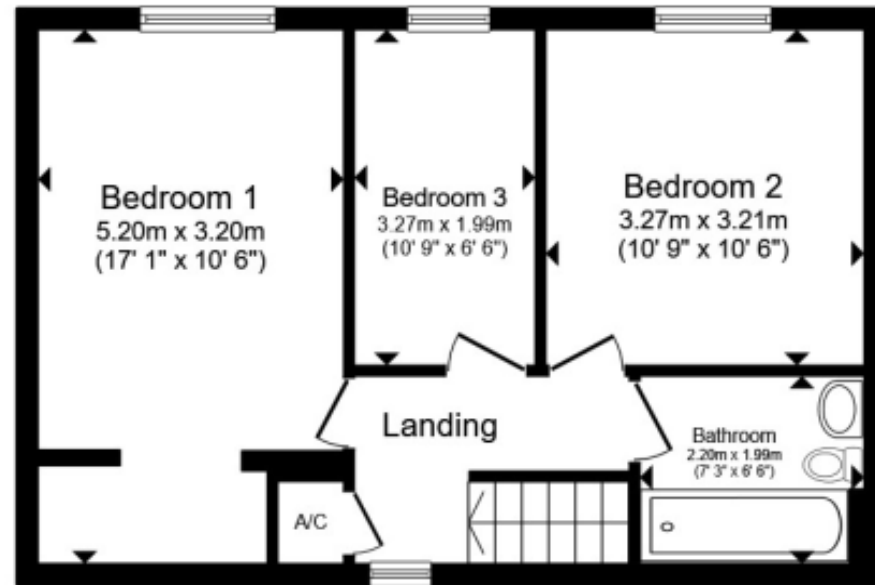

First Floor

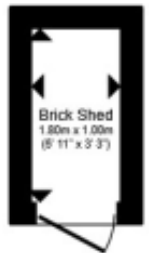

Outbuilding

Total floor area 85.7 m² (923 sq.ft.) approx

This floor plan is for illustrative purposes only. It is not drawn to scale. Any measurements, floor areas (including any total floor area), openings and orientation are approximate. No details are guaranteed, they cannot be relied upon for any purpose and they do not form part of any agreement. No liability is taken for any error, omission or misstatement. A party must rely upon its own inspection(s). Powered by www.propertybox.io

Entrance Hallway

With central heating radiator

Kitchen

10' 1" x 16' 9" (3.07m x 5.11m)

With a range of wall and base units, a sink/drain, plumbing for a washing machine or dishwasher, double glazed French Doors to the rear, double glazed windows to the front and a central heating radiator

Downstairs Toilet

With a w/c and a hand wash basin

Living Room

16' 11" x 10' 1" (5.16m x 3.07m)

With double glazed windows to the rear and a central heating radiator. Double glazed door to rear gives access to the rear garden.

Landing

Bedroom One

10' 2" x 13' 4" (3.10m x 4.06m)

With double glazed windows to the rear, a central heating radiator and an built-in wardrobe

Bedroom Two

10' 1" x 6' 6" (3.07m x 1.98m)

With double glazed windows to the rear and a central heating radiator.

Bedroom Three

10' x 10' 2" (3.05m x 3.10m)

With double glazed windows to the rear and a central heating radiator

Family Bathroom

With a w/c, hand wash basin, a bath with shower over, a heated towel rail and double-glazed windows to the front.

Rear Garden

With patio and lawn areas and a rear access gate



view this property online shipways.co.uk/Property/RDC110453



welcome to

Doverdale Close, Redditch

- Chain Free Property
- Newly refurbished throughout
- End-terrace
- Three bedrooms
- Downstairs toilet

Tenure: Freehold EPC Rating: D

Council Tax Band: A

offers over

£170,000



Please note the marker reflects the postcode not the actual property

view this property online shipways.co.uk/Property/RDC110453



Property Ref:
RDC110453 - 0003

1. MONEY LAUNDERING REGULATIONS Intending purchasers will be asked to produce identification documentation at a later stage and we would ask for your co-operation in order that there is no delay in agreeing the sale. 2. These particulars do not constitute part or all of an offer or contract. 3. The measurements indicated are supplied for guidance only and as such must be considered incorrect. Potential buyers are advised to recheck measurements before committing to any expense. 4. We have not tested any apparatus, equipment, fixtures or services and it is in the buyers interest to check the working condition of any appliances. 5. Where an EPC, or a Home Report (Scotland only) is held for this property, it is available for inspection at the branch by appointment. If you require a printed version of a Home Report, you will need to pay a reasonable production charge reflecting printing and other costs. 6. We are not able to offer an opinion either written or verbal on the content of these reports and this must be obtained from your legal representative. 7. Whilst we take care in preparing these reports, a buyer should ensure that his/her legal representative confirms as soon as possible all matters relating to title including the extent and boundaries of the property and other important matters before exchange of contracts.

Shipways is a trading name of Sequence (UK) Limited which is registered in England and Wales under company number 4268443, Registered Office is Cumbria House, 16-20 Hockliffe Street, Leighton Buzzard, Bedfordshire, LU7 1GN. VAT Registration Number is 500 2481 05.



01527 65155



Redditch@shipways.co.uk



3 Alcester Street, REDDITCH, Worcestershire,
B98 8AE



shipways.co.uk