



## Kilburn Lane, W10

£2,395 Per calendar month

A stylish one bedroom, open plan apartment benefiting from a private balcony. The contemporary design is one of quiet elegance where every detail has been addressed. Perfectly blending style with function, each apartment has adopted a considered layout, providing balanced space to live and work.

A clean lined contemporary building with a brick facade, respectful to the character of the quiet sounding Victorian streets, Old Dairy House blends harmoniously into this hip but welcoming corner of West London.

### Features

- Private Balcony
- Landscaped Courtyard
- Communal Roof Terrace
- High Specification
- Close to Transport Links
- One Bedroom

# Kilburn Lane, London, W10

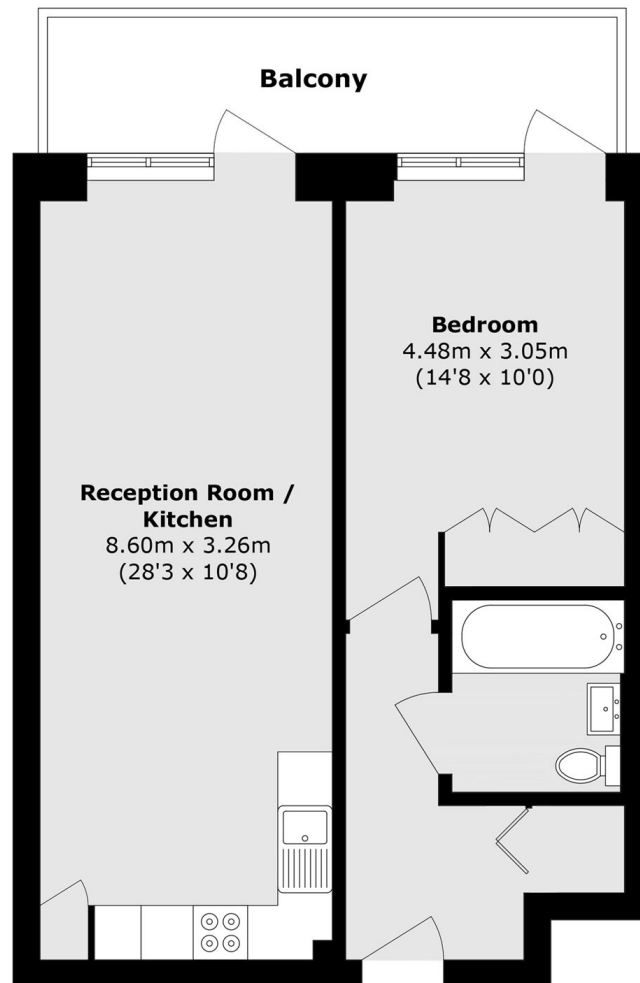

Total area (approx.): 54.5 sq. m (586.6 sq. ft)

Balcony area (approx.): 9.4 sq. m (101.1 sq. ft)