

Estate Agents



Auctioneers



## **Stourfield Road, Southbourne, Bournemouth, BH5 2AR Monthly Rental Of £1,600**

Refurbished Three Bedroom Semi Detached House | Hallway | Two Reception Rooms  
14' Modern Kitchen | Landing | Three Bedrooms | Modern Bathroom | Rear Garden  
Available Now

# Stourfield Road, Southbourne, Bournemouth, BH5 2AR

## Monthly Rental Of £1,600

AVAILABLE NOW! This three bedroom semi-detached house is ideally situated just a short walk from the popular shopping parade at Southbourne Grove with its array of coffee shops, bars and restaurants.

The property has recently been re-furbished and features include a newly installed three piece bathroom, 14' modern kitchen with built-in oven and hob, UPVC double glazing, gas central heating, two separate reception rooms and three good sized bedrooms.

Outside, there is a secluded rear garden with private patio area. Off street parking for small car to front

Available for long term lets only.

Council Tax Band: C

EPC: Band D

GROUND FLOOR  
459 sq.ft. (42.7 sq.m.) approx.

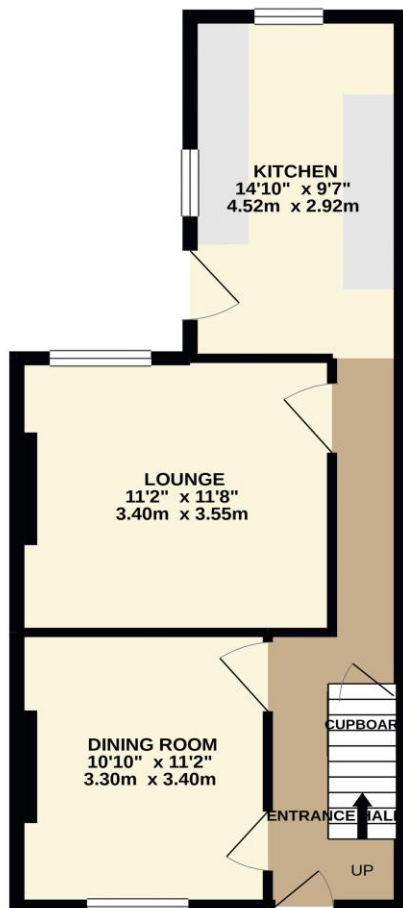

1ST FLOOR  
342 sq.ft. (31.8 sq.m.) approx.

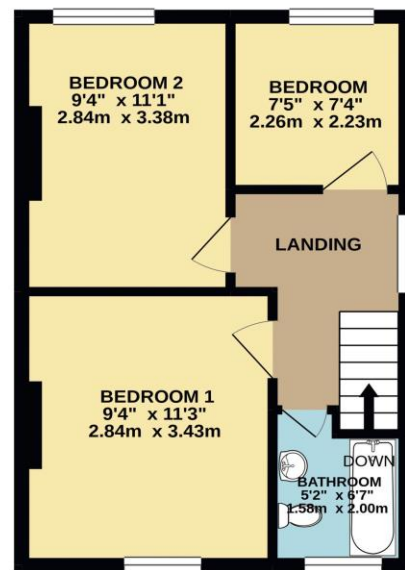

TOTAL FLOOR AREA: 801 sq.ft. (74.5 sq.m.) approx.

Whilst every attempt has been made to ensure the accuracy of the floorplan contained here, measurements of doors, windows, rooms and any other items are approximate and no responsibility is taken for any error, omission or mis-statement. This plan is for illustrative purposes only and should be used as such by any prospective purchaser. The services, systems and appliances shown have not been tested and no guarantee as to their operability or efficiency can be given.  
Made with Metropix ©2021

These particulars, whilst believed to be accurate are set out as a general outline only for guidance and do not constitute any part of an offer or contract. Intending purchasers should not rely on them as statements of representation of fact, but must satisfy themselves by inspection or otherwise as to their accuracy. We have not carried out a detailed survey nor tested the services, appliances and specific fittings. Room sizes should not be relied upon for carpets and furnishings. The measurements given are approximate. No person in this firm's employment has the authority to make or give any representation or warranty in respect of the property.