



Connells

Pomander Crescent
Walnut Tree Milton Keynes

Pomander Crescent Walnut Tree Milton Keynes MK7 7NL

for sale
£135,000



Property Description

Situated within a quiet and well-regarded residential area, Pomander Crescent offers a well-kept two-bedroom mid-terrace home available on a 50% shared ownership basis. It's a practical choice for first-time buyers, young professionals, or anyone looking for an affordable and comfortable home.

The property begins with a small entrance porch leading into the main living room. This space benefits from good natural light and provides a straightforward, functional area for everyday living.

To the rear, the fitted kitchen includes ample worktop space and units suitable for day-to-day cooking. A door leads straight out to the rear garden for convenient access.

Upstairs, there are two well-proportioned bedrooms. The main bedroom comfortably fits a double bed and additional furniture, while the second room works well as a child's bedroom, guest room, or home office.

Entrance Porch

Laminate floor, internal door opening into lounge.

Lounge

Well-presented living area featuring a blend of carpet and laminate flooring, a front-facing window dressed with curtains, and a fitted radiator

Kitchen

Wall and base units, space for washing machine and tumble dryer, sink & drainer, induction hob with electric hood over, double glazed window to rear, wall mounted radiator.

Landing

Carpeted, access to all rooms.

Bedroom One

Spacious and well-presented, offering carpet flooring, an integrated wardrobe, radiator, and two front-facing windows that bring in plenty of natural light.

Bedroom Two

Well-arranged space offering laminate flooring, built-in storage with the water heater, and a rear-facing window providing natural light.

Bathroom

Well-appointed with laminate flooring, a modern three-piece suite, extractor fan, and a window providing natural light and ventilation.

Outside Space

Front Garden

Shrub beds, mainly paved, lawn area.

Rear Garden

Raised decking area, mainly laid to lawn, paved to the end with a hardstanding for shed, enclosed fencing. outside cold water tap.



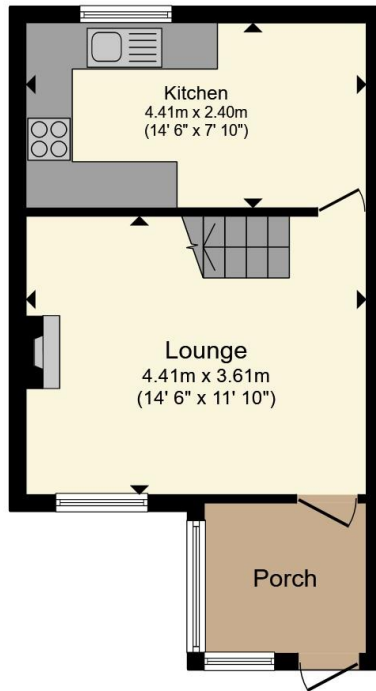

Ground Floor

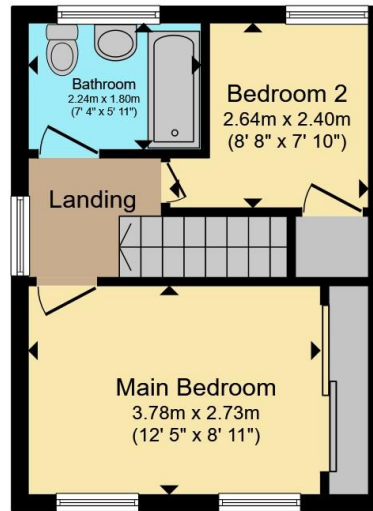

First Floor

Total floor area 58.1 m² (625 sq.ft.) approx

This floor plan is for illustrative purposes only. It is not drawn to scale. Any measurements, floor areas (including any total floor area), openings and orientation are approximate. No details are guaranteed, they cannot be relied upon for any purpose and they do not form part of any agreement. No liability is taken for any error, omission or misstatement. A party must rely upon its own inspection(s). Powered by www.propertybox.io

Connells



To view this property please contact Connells on

T 01908 691606
E walnuttree@connells.co.uk

26A Fyfield Barrow The Walnut Tree Local Centre Walnut Tree

EPC Rating: D

Council Tax Band: C

Service Charge: 255.00 Ground Rent: Ask Agent

Tenure: Leasehold

view this property online connells.co.uk/Property/WNT308079

This is a Leasehold property with details as follows; Term of Lease 189 years from 01 Jan 1990. Should you require further information please contact the branch. Please Note additional fees could be incurred for items such as Leasehold packs.



1. MONEY LAUNDERING REGULATIONS Intending purchasers will be asked to produce identification documentation at a later stage and we would ask for your co-operation in order that there will be no delay in agreeing the sale. 2. These particulars do not constitute part or all of an offer or contract. 3. The measurements indicated are supplied for guidance only and as such must be considered incorrect. Potential buyers are advised to recheck measurements before committing to any expense. 4. We have not tested any apparatus, equipment, fixtures, fittings or services and it is in the buyers interest to check the working condition of any appliances.

Connells Residential is registered in England and Wales under company number 1489613, Registered Office is Cumbria House, 16-20 Hockliffe Street, Leighton Buzzard, Bedfordshire, LU7 1GN. VAT Registration Number is 500 2481 05.

See all our properties at www.connells.co.uk | www.rightmove.co.uk | www.zoopla.co.uk

Property Ref: WNT308079 - 0002