



## Kingsland Walk

Guide Price £175,000 to £180,000

- Three Bedrooms
- Family Bathroom
- Utility Room
- Front and Rear Gardens
- Communal Car Park
- Close to Shops, Schools and Leisure Facilities
- Close Proximity to Cwmbran Town Centre and Excellent Transport Links



**Pinkmove**

01633 746088  
team@pinkmove.co.uk



## About the property

This beautifully presented three-bedroom mid-terrace home on Kingsland Walk offers modern, comfortable living in a highly convenient Cwmbran location.

The ground floor features a spacious open-plan kitchen and dining area to the front, complete with direct access to a practical utility room. To the rear, a bright and welcoming lounge opens onto an enclosed garden, thoughtfully designed with both a decking area and a lawn—perfect for relaxing, entertaining, or enjoying the outdoors. The property also benefits from an enclosed patio garden at the front, adding even more versatile outdoor space.

Upstairs, the home offers three well-proportioned and flexible bedrooms, along with a contemporary family bathroom, providing plenty of room to suit a range of lifestyles. Convenient parking is available nearby in the communal car park.

Kingsland Walk forms part of the well-connected St Dials community, with excellent access to a wide selection of local shops, amenities and services. Cwmbran Centre is just moments away, offering major retailers, supermarkets, leisure facilities and attractive green spaces. Families will appreciate the choice of schools in the local area, including Cwmbran High School, Croesyceiliog School and Llantarnam Community Primary.

Transport links are another strong feature, with Cwmbran's central bus station located within the main shopping district, along with the train station and straightforward access to the M4—ideal for commuters.





## Accommodation

### Kitchen/Diner

19' 5" x 11' ( 5.92m x 3.35m )

Max Measurements

### Lounge

11' 5" x 17' 2" ( 3.48m x 5.23m )

### Utility

4' 8" x 7' 9" ( 1.42m x 2.36m )

### Bedroom 1

16' 2" x 9' 3" ( 4.93m x 2.82m )

### Bedroom 2

9' 1" x 10' 10" ( 2.77m x 3.30m )

### Bedroom 3

8' 5" x 7' 8" ( 2.57m x 2.34m )

### Bathroom

6' 1" x 6' 2" ( 1.85m x 1.88m )

## Floorplan

### Ground Floor

Approx. 46.6 sq. metres (501.8 sq. feet)

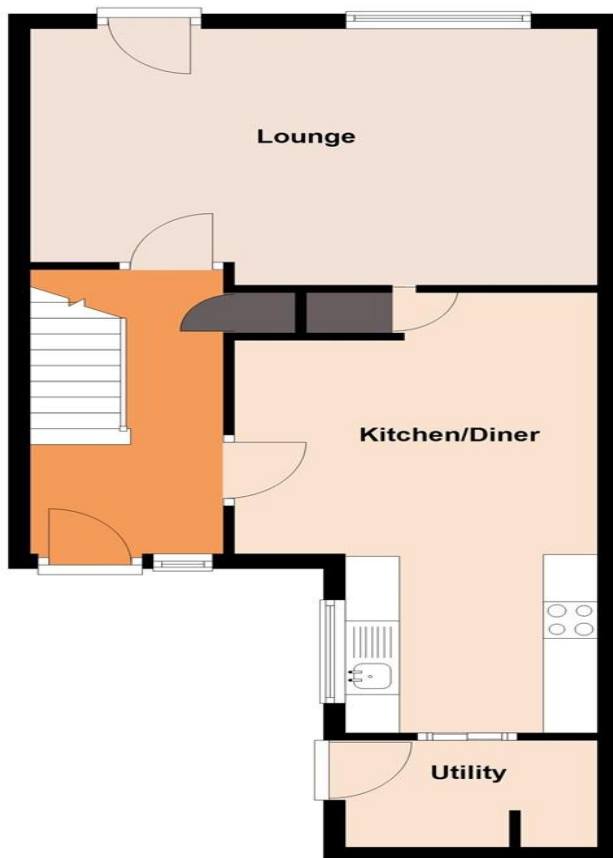

### First Floor

Approx. 40.1 sq. metres (431.7 sq. feet)



Total area: approx. 86.7 sq. metres (933.5 sq. feet)  
**8 Kingsland Walk**

## Important Information

Note while we endeavour to make our sales details accurate and reliable, if there is any point which is of particular interest to you, please contact the office and we will be pleased to confirm the position for you. We have not personally tested any apparatus, equipment, fixtures, fittings or services and cannot verify they are in working order or fit for their purposes. Nothing in these particulars is intended to indicate that carpets or curtains, furnishings or fittings, electrical goods (whether wired or not), Gas fires or light fittings or any other fixtures not expressly included form part of the property offered for sale. This computer generated Floorplan, if applicable, is intended as a general guide to the layout and design of the property. It is not to scale and should not be relied upon for dimensions. Tenure: We cannot confirm the tenure of the property as we have not had access to the legal documents. The buyer is advised to obtain verification from their solicitor or surveyor.

Peter Alan Limited is registered in England and Wales under company number 2073153, Registered Office is Cumbria House, 16-20 Hockliffe Street, Leighton Buzzard, Bedfordshire, LU7 1GN. VAT Registration Number is 500 2481 05. For activities relating to regulated mortgages and non-investment insurance contracts, Peter Alan Limited is an appointed representative of Connells Limited which is authorised and regulated by the Financial Conduct Authority. Connells Limited's Financial Services Register number is 302221. Most buy-to-let