



CHARLES BARTLETT
RESIDENTIAL



Flat 14 Stoneworks Place

Matlock Spa, Matlock, DE4 3UG

£1,500 Per month



Introducing a two-bedroom apartment in Stoneworks Place, Matlock Spa.

This modern property features an inviting open-plan living room and kitchen with integrated appliances, ideal for contemporary living. The master bedroom and second double bedroom provide comfortable spaces, complemented by a well-appointed bathroom with a shower.

Enjoy the convenience of allocated parking, enhancing the appeal of this brand-new property, seamlessly blending style and functionality.

Stoneworks Place also benefits from secure entry system and lockable bike storage.

We also have a further selection of additional brand new two-bedroom luxury apartments in Stoneworks Place, which you are welcome to view when you visit.



Area Map



Floor Plans

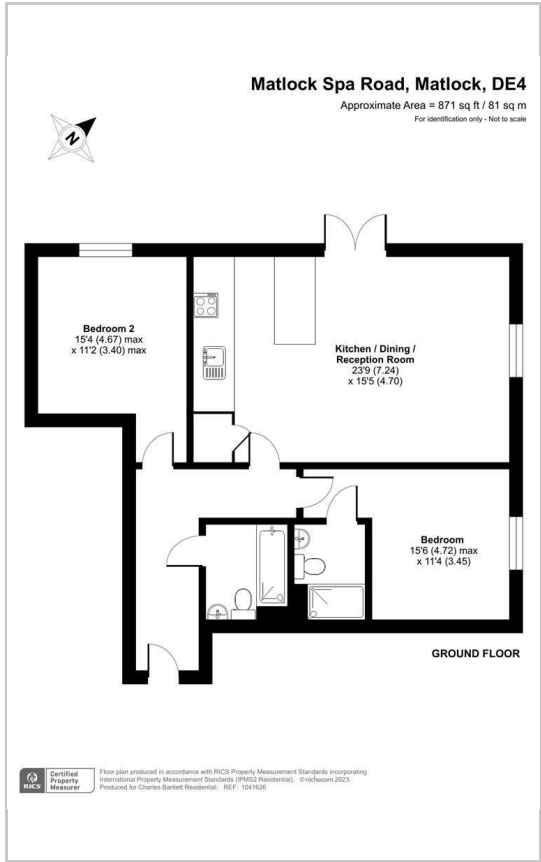

Energy Efficiency Graph

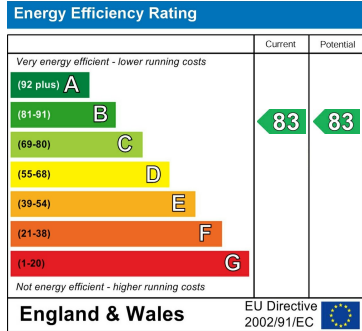

These particulars, whilst believed to be accurate are set out as a general outline only for guidance and do not constitute any part of an offer or contract. Intending purchasers should not rely on them as statements of representation of fact, but must satisfy themselves by inspection or otherwise as to their accuracy. No person in this firm's employment has the authority to make or give any representation or warranty in respect of the property.

The Newt, Denchworth Manor Hyde Road, Denchworth, Oxford, OX12 0DX
 Tel: 07939 496551 Email: charles@charlesbartlett.co.uk www.charlesbartlett.co.uk