



31 Strand Street | Liverpool | L1 8LP

£850 PCM

The
**GOOD
ESTATE**
AGENCY

31 Strand Street | Liverpool | L1 8LP £850 PCM

1 BED, FURNISHED WITH PARKING. An excellent, 8th floor apartment in the fashionable and highly sought after One Park West development. The property comprises: one double bedroom, stylish bathroom, hall, hall cupboard, spacious open plan living and dining room through to fully fitted kitchen. Further benefits include 24 hour concierge, communal rooftop gardens and allocated parking space. Designed by world renowned architect Cesar Pelli, famous for the Petronas Towers in Kuala Lumpur and Canary Wharf Tower in London's Docklands, One Park West is Liverpool's most desired address. Located in Liverpool ONE, in the heart of the city centre and clearly signposted along all major routes into the city. REPOSIT IS ALSO AVAILABLE TO REPLACE THE TRADITIONAL DEPOSIT - FEE APPLIES.

- ONE BEDROOM APARTMENT
- ALLOCATED PARKING
- 24 HOUR CONCIERGE
- FITTED KITCHEN
- EXCELLENT LOCATION NEXT TO LIVERPOOL ONE
- FURNISHED
- 8TH FLOOR
- INTERCOM
- OPEN PLAN LIVING ROOM
- COMMUNAL GARDENS

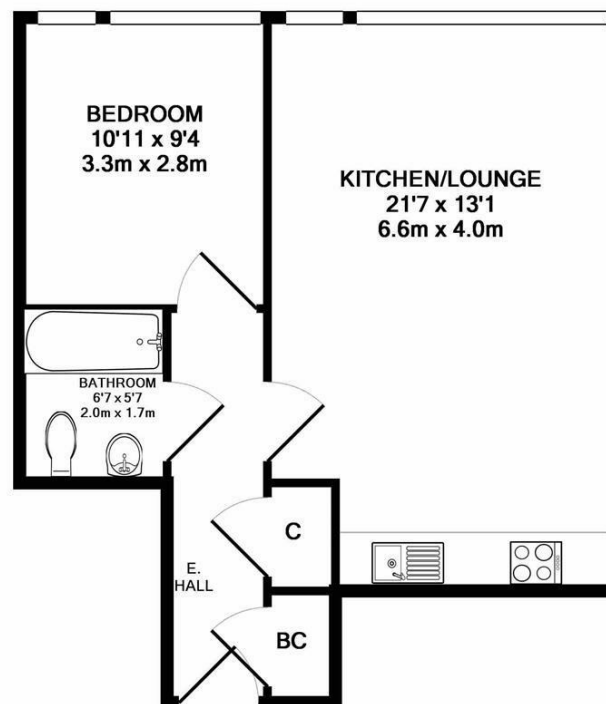

Energy Efficiency Rating		
	Current	Potential
Very energy efficient - lower running costs		
(92 plus) A		
(81-91) B	85	85
(69-80) C		
(55-68) D		
(39-54) E		
(21-38) F		
(1-20) G		
Not energy efficient - higher running costs		
England & Wales	EU Directive 2002/91/EC	

TOTAL APPROX. FLOOR AREA 488 SQ.FT. (45.4 SQ.M.)

Whilst every attempt has been made to ensure the accuracy of the floor plan contained here, measurements of doors, windows, rooms and any other items are approximate and no responsibility is taken for any error, omission, or mis-statement. This plan is for illustrative purposes only and should be used as such by any prospective purchaser. The services, systems and appliances shown have not been tested and no guarantee as to their operability or efficiency can be given

Made with Metropix ©2019

68 Quay Street
Manchester
M3 3EJ

0161 513 2034
hello@thegea.co.uk
www.thegea.co.uk