



**Askrigg Close**

Chester Le Street DH2 1TX

**£81,950**







This footer paragraph is an example only and should not be relied upon as complying with current legislation. These particulars, whilst believed to be accurate are set out as a general outline only for guidance and do not constitute any part of an offer or contract. Intending purchasers should not rely on them as statements of representation of fact, but must satisfy themselves by inspection or otherwise as to their accuracy. No person in this firms employment has the authority to make or give any representation or warranty in respect of the property.

# Askrigg Close

Chester Le Street DH2 1TX



x 1



x 1



x 1

Nestled in a tranquil cul de sac on Askrigg Close in Ouston, Chester Le Street, this charming one-bedroom terraced house presents an excellent opportunity for first-time buyers, those looking to downsize, or savvy property investors.

Upon entering, you are welcomed into a convenient entrance vestibule that leads to a lounge, featuring an open-plan staircase that adds a touch of modernity to the space. The white kitchen is well-equipped with a built-in hob, oven, and extractor, making it a delightful area for culinary pursuits.

Ascending to the first floor, you will find a generously sized double bedroom, perfect for relaxation and rest. The property also boasts a recently refitted shower room with a WC, ensuring comfort and convenience.

Additional benefits of this home include gas central heating powered by a combination boiler and UPVC double glazing throughout, providing warmth and energy efficiency. Outside, the property features gardens to both the front and rear, offering a pleasant outdoor space to enjoy. An allocated parking bay adds to the practicality of this lovely home.

With no onward chain, this property is ready for you to move in and make it your own. We encourage you to call us early on 0191 3729898 to arrange a viewing and discover the potential this delightful home has to offer.

Freehold  
Council tax band A  
EPC rating C

## ENTRANCE VESTIBULE

## LOUNGE

11'6" x 11'2" including stairs (3.51m x 3.40m including stairs)

## KITCHEN

11'6" x 6'11" (3.51m x 2.11m)

## FIRST FLOOR

## BEDROOM

11'2" x 9'4" (3.40m x 2.84m)

## SHOWER ROOM/WC

## OUTSIDE

[www.venturepropertiesuk.com](http://www.venturepropertiesuk.com)



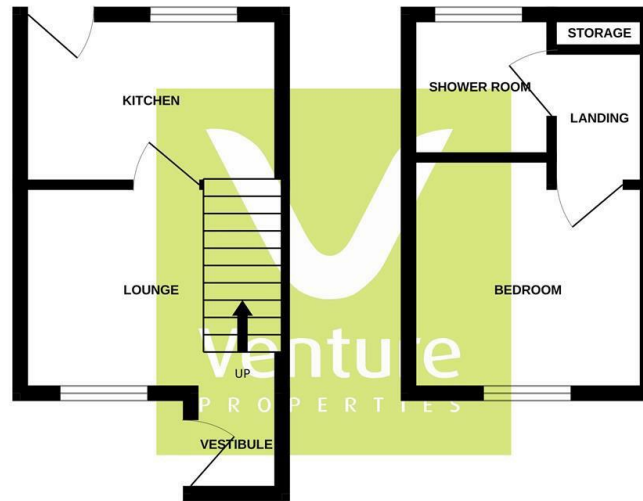

Whilst every attempt has been made to ensure the accuracy of the floorplan contained herein, measurements of plots, sections, rooms and any other items are approximate and no responsibility is taken for any error, omission or mis-statement. This plan is for illustrative purposes only and should be used as such by any prospective purchaser. The services, systems and appliances shown have not been tested and no guarantee as to their operability or efficiency can be given.  
Made with Metagen ©2025



## Property Information

**0191 372 9898**

Suite 6, 15 North Burns, Chester-le-Street, County Durham, DH3 3TF  
[sales.cls@venturepropertiesuk.com](mailto:sales.cls@venturepropertiesuk.com)