



10 Timberley Close, Holbury, SO45 2QE
£283,950



ANTHONY JAMES
PROPERTIES



10 Timberley Close

Holbury, Southampton, SO45 2QE

This well-presented end of terrace home offers comfortable and modern living, ideal for a wide variety of buyers. The property features a generous lounge and dining room, providing a welcoming space for relaxation or entertaining, complemented by a separate kitchen and a practical entrance porch. Two double bedrooms offer ample accommodation, served by a bathroom fitted with a white suite. The house benefits from further features including gas central heating, UPVC double glazing and a single garage. This property is ready to move into, would suit a wide variety of buyers, and provides a perfect opportunity for those seeking a well-maintained home in a popular location. Viewing is strongly recommended.

LOCATION

Timberley Close is a highly favoured development situated on the edge of Holbury where local amenities cater for most every day needs, including schools for children of all age groups. Two pubs, The Old Mill and The Forest Home, are within walking distance. Bus services run regularly to other Waterside areas, including Hythe Village, where a passenger ferry service operates to Town Quay in Southampton (please note the ferry service is currently under repair). The New Forest National Park is nearby (there are walks directly into the forest near to Wedgewood Close) and the coastline is just a short drive away, enabling many outside interests to be enjoyed. There are a number of Recreation Centres throughout the Waterside providing facilities for many indoor and outdoor activities including golf, football, rugby and tennis.

Council Tax band: B

Tenure: Freehold



1 Southward House
Dibden Purlieu SO45 4PT



T: 02380 844405
info@anthonyjamesproperties.co.uk



GROUND FLOOR

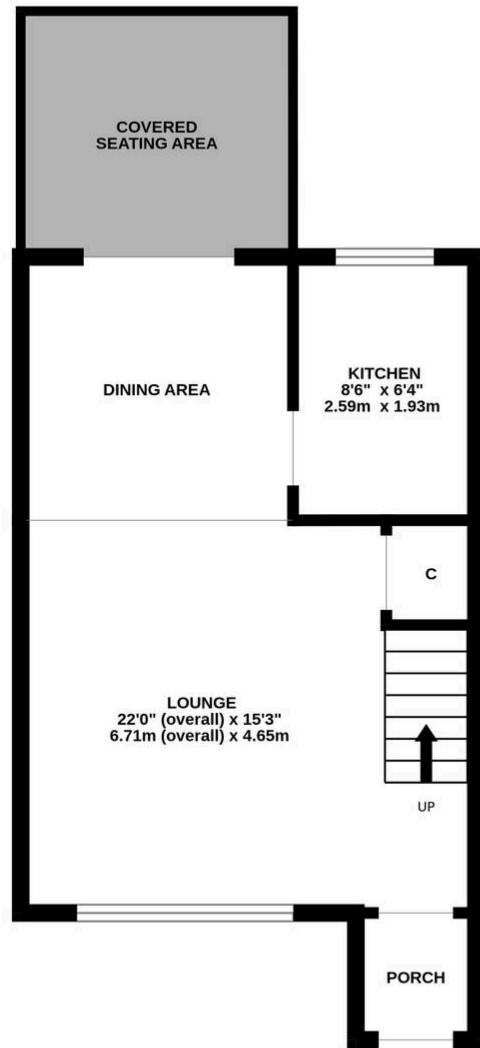

1ST FLOOR

