



JON KEYTE

exp

@ jon.keyte@expuk.com

jonkeyte.expuk.com

[07445 265 314](tel:07445265314)

Gillard Road, Brixham, Brixham, Devon, TQ5 9EP

Guide Price £60,000

🛏️ 3 🚗 2 🚗 1



- Please Quote Ref JK1243
- Detached Spacious Holiday Home
- Lease in place until 2046
- Excellent Position in Brixham with unspoilt Sea Views
- Communal Gardens and Access to South West Coast Path
- Allocated Parking for Two Cars
- Wonderful Open Plan Living Accommodation with Modern Fitted Kitchen
- Excellent On-site Facilities including Swimming Pool & Restaurant/Bar
- Super Investment Opportunity as a Holiday Let
- No Onward Chain !!



exp UK



exp UK



exp UK



exp UK

Please Quote Ref JK1243

Welcome to this charming property at Landscope Holiday Park, where relaxation and scenic beauty meet. Offering stunning views over St. Mary's Bay, this delightful holiday park home provides the perfect blend of modern comfort and natural surroundings. The spacious open-plan living accommodation creates an inviting atmosphere, ideal for both relaxation and entertaining with a wonderful fitted contemporary fitted kitchen. Step outside onto the private balcony to soak in the picturesque coastal vistas and fresh sea air. The property also features parking for two cars, ensuring convenience and ease. Whether you're seeking a peaceful retreat or a home with excellent holiday potential, this property offers everything you need to enjoy the beauty of the Bay and the serenity of Landscope. Don't miss out on the opportunity to make this your perfect getaway or y

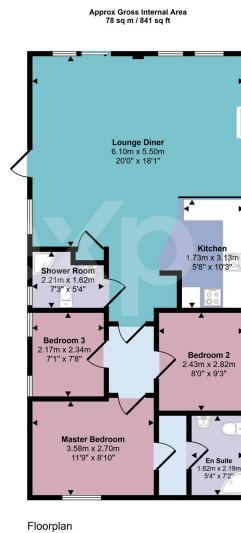

This floorplan is only for illustrative purposes and is not to scale. Measurements of rooms, doors, windows, and any items are approximate and no responsibility is taken for any error, omission or misstatement. Icons of items such as bathroom suites are representations only and may not look like the real items. Made with MakeSnap360.

