



Stafford Way, Market Harborough

Market Harborough

£2,200 pcm

Deposit: £2,538

Date First Available: 31/07/2026

An exceptionally well-presented four-bedroom detached family home, offering generous proportions, a high standard of finish throughout, and a recently landscaped south-east facing rear garden within the popular Wellington Place development.

- Conveniently located, the property is within close walking distance to local amenities including a supermarket and coffee shop, a primary school, and offers countryside walks along the canal with access to local businesses and a restaurant.

- Entrance through the solid timber front door leads into an inviting and spacious entrance hall with high-quality LVT flooring, stairs rising to the first floor, and access to a useful under-stair storage cupboard.

- Spacious and open-plan Kitchen/Dining Room featuring continued LVT flooring in the kitchen area and carpeted flooring in the dining area. French doors open out to the south-east facing rear garden, and the dining area provides ample space for an eight-seater dining table and chairs.

- The modern Kitchen comprises a host of eye and base level high-gloss fitted units, quartz work surfaces, an inset stainless steel one and a half bowl sink, an integrated electric oven, a four-ring hob, an integrated fridge/freezer, and an integrated dishwasher.

- Beautifully appointed Living Room, finished in excellent decorative order, with French doors opening out to the attractive rear garden.

- Ground floor Study, offering a bright space with a window to the front elevation, ideal for use as a home office or a playroom.

- Utility/Guest WC comprising continued LVT flooring, base level high-gloss fitted units, quartz work surfaces, an inset stainless steel one and a half bowl sink, an integrated washing machine, and a low level WC.

- First floor landing provides access to an airing cupboard with a pressurised hot water cylinder.

- Beautifully decorated Main Bedroom, generously sized with a window to the front elevation, a range of fitted wardrobes and an En Suite Shower Room





Ground Floor

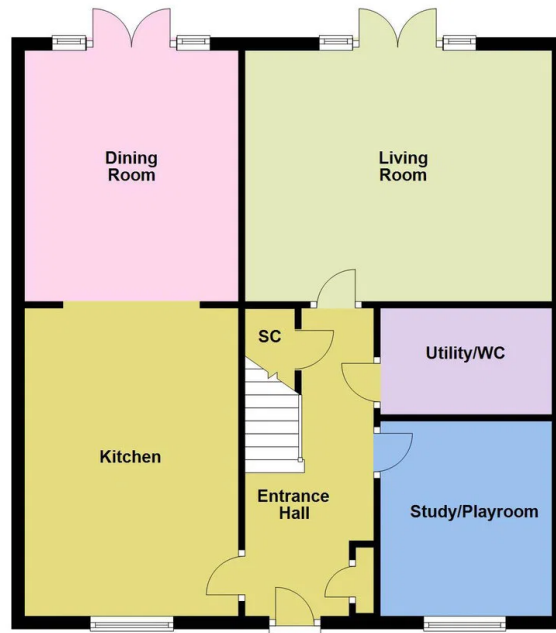

First Floor

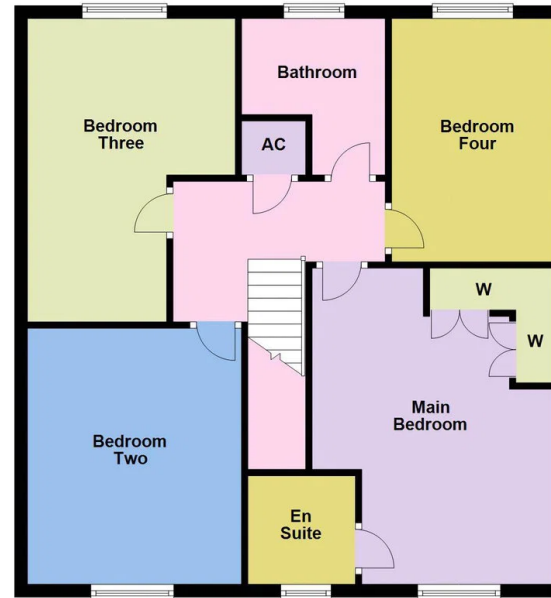

Henderson Connellan Market Harborough office 01858 410 400 | 63 High Street, Market Harborough, Leicestershire, LE16 7AF
marketharboroughsales@hendersonconnellan.co.uk | marketharboroughlettings@hendersonconnellan.co.uk



Disclaimer: These particulars do not form part of any offer or contract and should not be relied upon as statements or representations of fact. Any areas, measurements of distances are approximate. The text, photographs and plans are for guidance only and are not necessarily comprehensive.

