

Hendon Street, Leigh, WN7 1TS
Offers Over £200,000

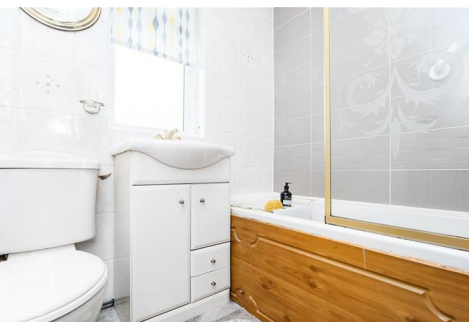

BALMER & CO in LEIGH are delighted to offer FOR SALE this spacious three bedroom semi detached property located on Hendon Street, a popular residential area on border of Leigh and Atherton. Although it requires some updating in places, it is a great size and is ideally offered with no onward chain so it would be perfect for those looking for a home where they can add their own stamp. The ground floor comprising in brief; entrance hallway, bay fronted living room, separate dining room with French doors leading to the rear garden and a fitted kitchen. To the first floor are two double bedrooms, a good sized single bedroom and a three piece bathroom suite. Externally, there are low maintenance gardens to the front and rear of the property with a driveway and detached garage. Early viewings highly recommended, all enquiries welcome.

Floor Plan

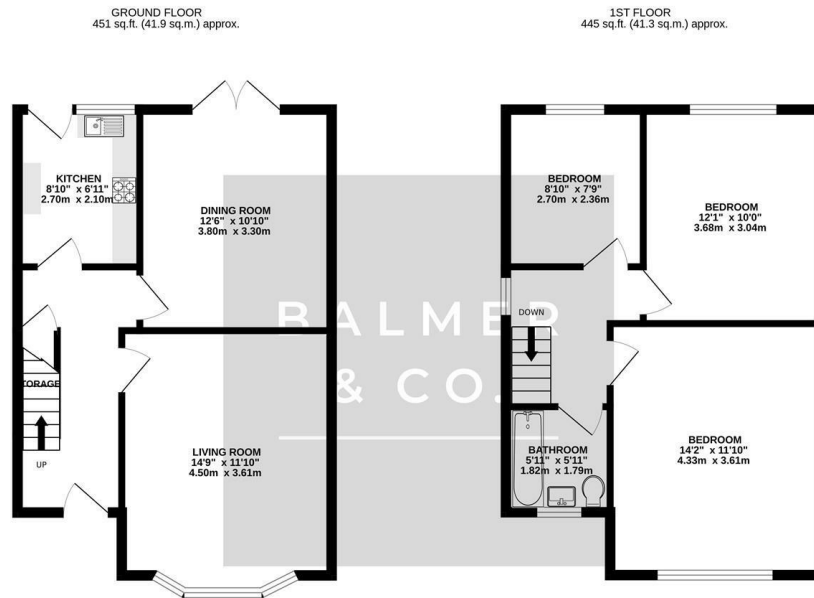

TOTAL FLOOR AREA - 896 sq.ft. (83.2 sq.m.) approx.
 Whilst every attempt has been made to ensure the accuracy of the floorplan contained here, measurements of doors, windows, rooms and any other items are approximate and no responsibility is taken for any error, omission or mis-statement. This plan is for illustrative purposes only and should be used as such for any prospective purchaser. The services, systems and appliances shown have not been tested and no guarantee as to their operability or efficiency can be given.
 Made with Metropix ©2025

Area Map

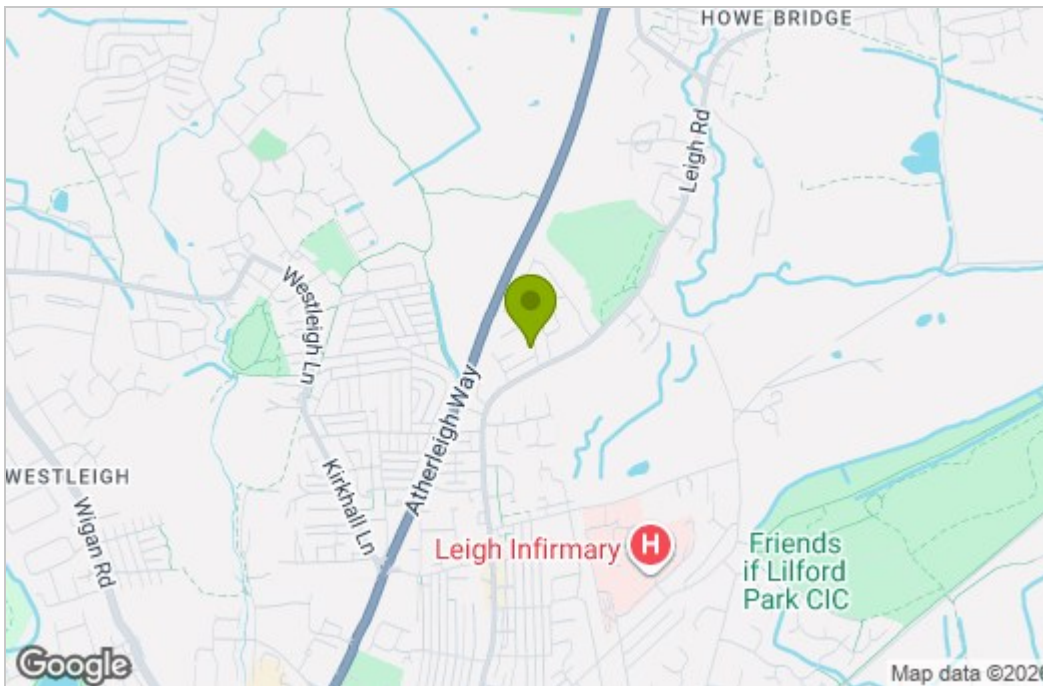

Energy Efficiency Graph

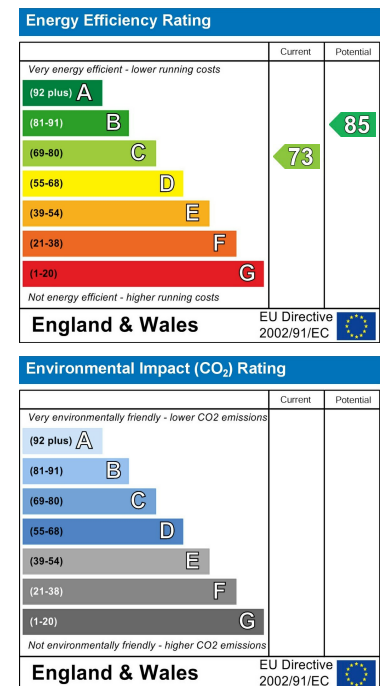

These particulars, whilst believed to be accurate are set out as a general outline only for guidance and do not constitute any part of an offer or contract. Intending purchasers should not rely on them as statements of representation of fact, but must satisfy themselves by inspection or otherwise as to their accuracy. No person in this firm's employment has the authority to make or give any representation or warranty in respect of the property.