



French Street, TW16

£625,000

This turn key, four bedroom family home is ideal for an upsizing family. This special house has retained lots of character whilst creating a wonderful layout for family life. There is the added bonus of a landscaped garden and off-street parking.

French Street is a sought after location in the centre of Lower Sunbury, the River Thames and Rivermead Island are at the end of the road, the local shops and Kempton Park station which provides a direct service into Waterloo are all close by.

Features

- Smartly Presented
- Mid-Terrace
- Four Bedrooms
- Two Bathrooms
- Off-Street Parking
- Private Rear Garden

French Street, Sunbury-On-Thames, TW16

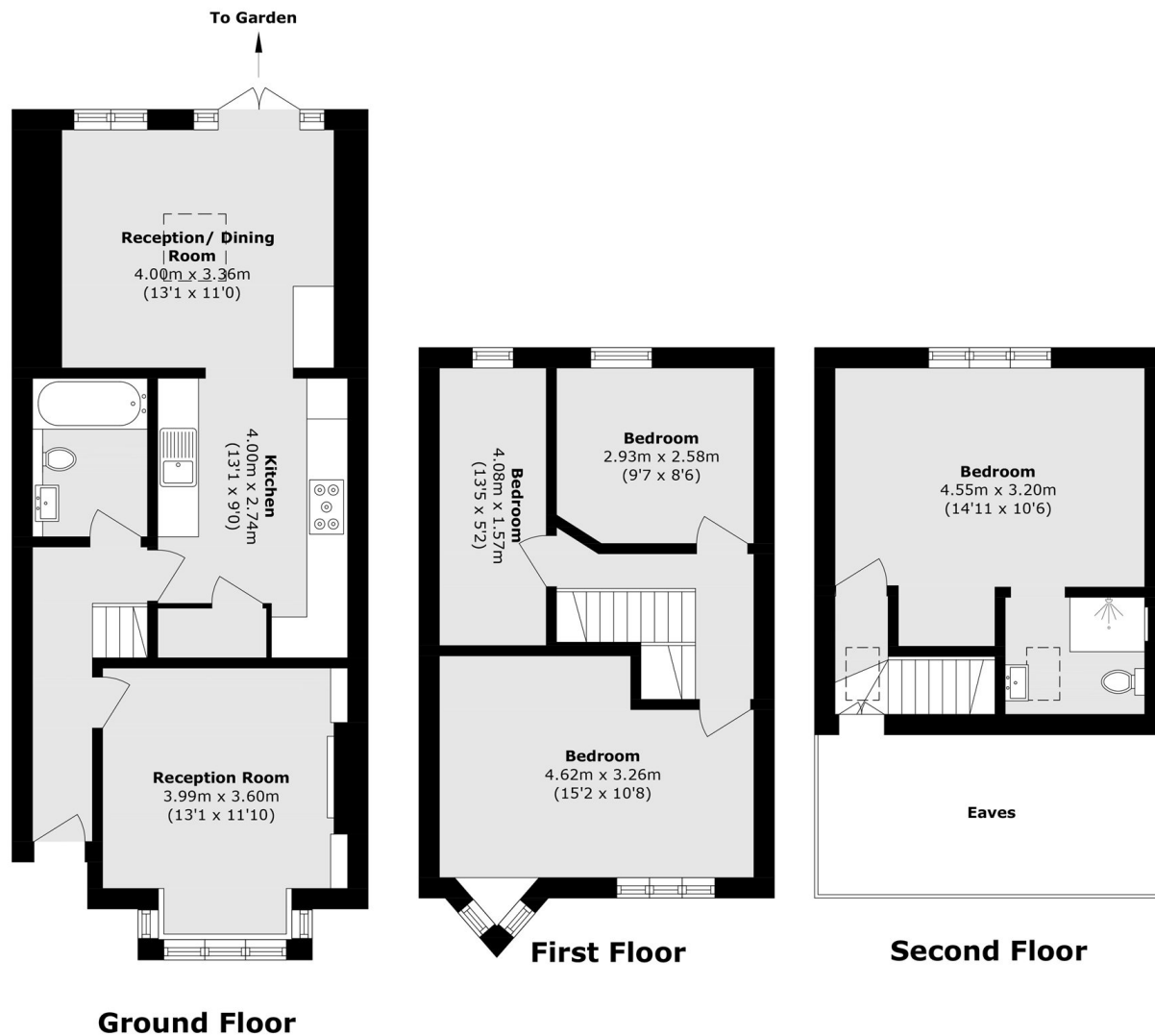

Total area (approx.): 110.2 sq. m (1186.2 sq. ft)
(Excluding Eaves)