



8, The Close, Barton on Sea, New Milton, BH25

Asking Price £675,000

Mitchells
1963 — TODAY



*8 The Close
Barton on Sea
New Milton
Hampshire
BH25 7EZ*

A modern and well presented four/five bedroom detached family house, situated in a sought after and peaceful location within easy reach of the beautiful Barton on Sea clifftop and beach. The property offers superb family accommodation, including a fantastic kitchen/dining room with a separate utility room, four good sized first floor bedrooms, with the master bedroom benefiting from an en-suite shower room, a ground floor fifth bedroom/home office, and a generously sized rear garden.

- Sitting Room
- Kitchen/Dining Room
- Utility Room & Ground Floor Cloakroom
- Ground Floor Bedroom Five/Family Room
- First Floor Landing
- Four First Floor Bedrooms
- En-Suite Shower Room
- Family Shower Room
- Garage & Off Road Parking
- Private Gardens



The Property

Entrance hall with a useful large storage cupboard and stairs leading to the first floor landing.

Lovely double aspect sitting room with a bay window overlooking the rear garden.

Superb large kitchen/dining room, with the kitchen area having an excellent range of recently installed units, including soft closing drawers and doors, and a stone effect worktop and breakfast bar. Integrated appliances include a double electric oven, a four burner gas hob, an extractor fan, and a dishwasher. There is ample space for a dining table, tiled flooring, and a view over the rear garden.

Useful separate utility room with a further range of modern wall and base units, a stone effect worktop, and an inset sink unit with a mixer tap. There is space and plumbing for a washing machine and tumble dryer, along with a wall mounted Glow Worm gas fired boiler concealed in a cupboard, and attractive tiling.

Additional ground floor reception room, ideal for a home office, family room, or an extra bedroom if required.

Ground floor cloakroom fitted with a modern white suite.

First floor landing with a trap to the roof space and a large storage cupboard.

Four good sized first floor bedrooms, two of which have built-in wardrobes. The master bedroom benefits from a double aspect and a fully tiled en-suite bathroom fitted with a modern white suite.

Fully tiled family shower room fitted with a modern white suite, comprising a large shower cubicle with a thermostatically controlled shower, a wash basin, a WC, and recessed ceiling spotlights.

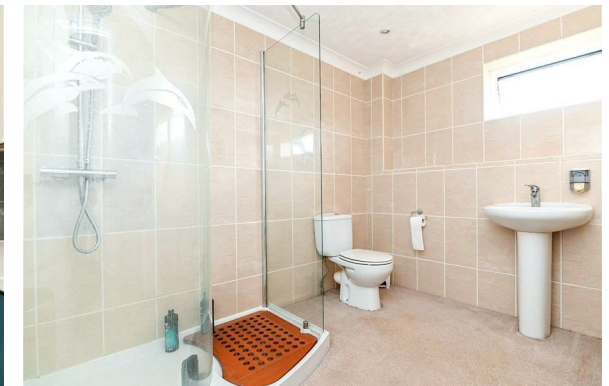



Gardens & Grounds

The property sits on a good sized corner plot with a double width block paved driveway to the front, providing ample off road parking and leading to the attached single garage, which has an electrically operated roller door, a pitched roof, power, and lighting.

To the rear of the property is a generously sized area of textured paved patio, with the remainder of the garden laid mainly to lawn. There is a timber garden shed and a high level brick wall providing privacy.

Services

Mains gas, electric, water and sewerage
Council Tax Band E
Energy Performance Rating

Ground Floor

Approx. 103.8 sq. metres (1117.5 sq. feet)

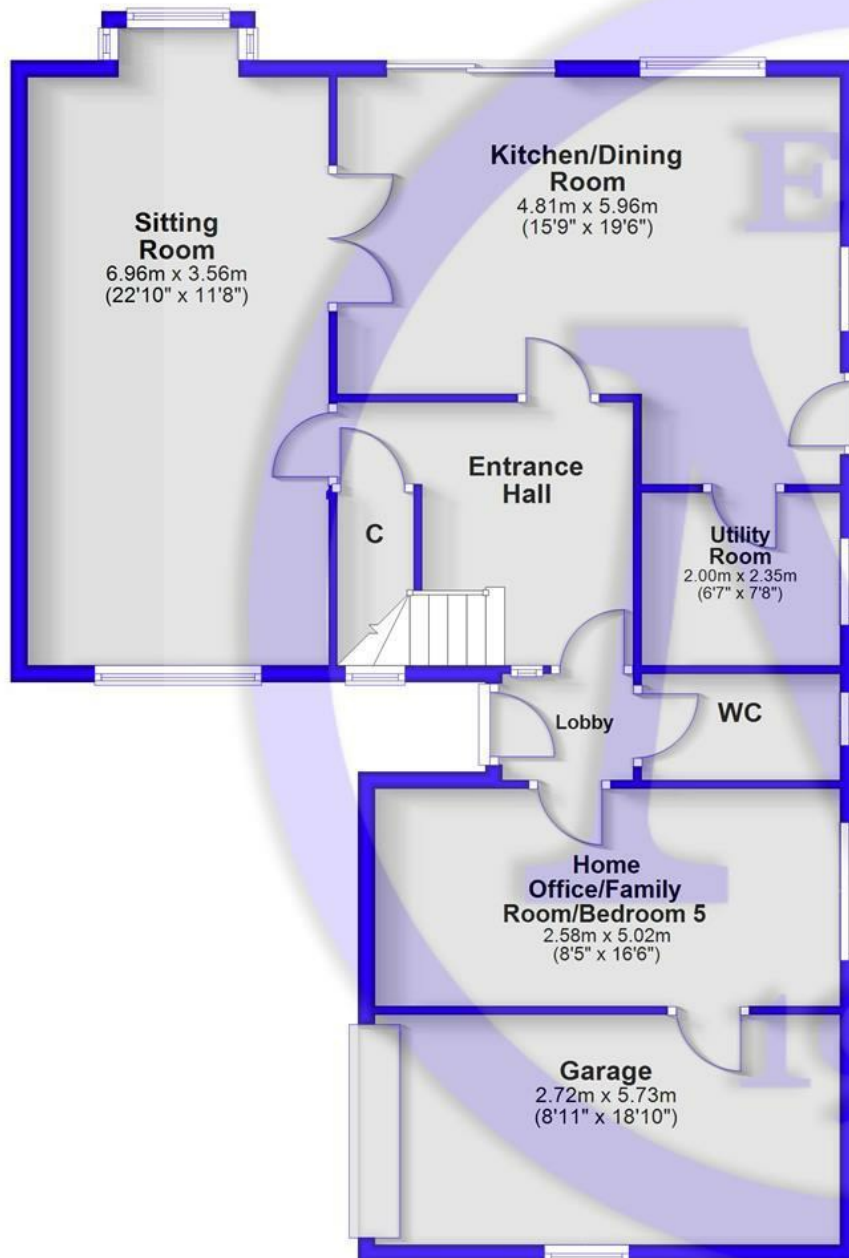

First Floor

Approx. 68.3 sq. metres (734.9 sq. feet)

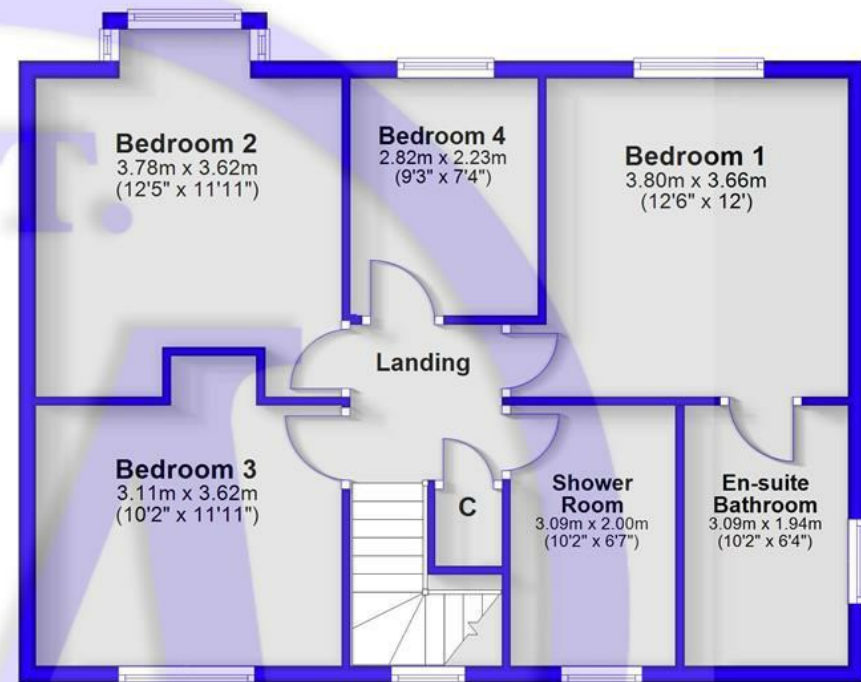

Total area: approx. 172.1 sq. metres (1852.4 sq. feet)

Situation





Mitchells.uk.com
info@mitchells.uk.com
01425 616411

Centenary Buildings
8-10 Old Milton Road
New Milton
Hampshire
BH25 6DT

Mitchells
1963 — TODAY

