

for sale

£160,000



The Pastures Lower Bullingham Hereford HR2 6EU

This one-bedroom house is ideal for first-time buyers or investors, featuring allocated parking and a private garden. Set in the popular Lower Bullingham area, it offers convenient living just 1.5 miles from the City Centre.

The Pastures Lower Bullingham Hereford HR2 6EU

Approach

The home offers allocated parking with the side gate giving access to the garden area, this is where the front door is positioned and the door leads to:

Lounge

12' 9" x 8' 11" (3.89m x 2.72m)

Double glazed door to front, window to front elevation, electric radiator, stairs leading to the first floor landing, opening leading to the kitchen and ceiling light point.

Kitchen

9' 4" x 7' 3" (2.84m x 2.21m)

Fitted kitchen with wooden wall and base units with roll top work surfaces over, one and a half bowl sink and drainer with splashbacks to walls, integrated electric oven and hob with cooker hood over, space for fridge freezer, plumbing for washing machine, under stairs storage, ceiling light point and double glazed window to front elevation.

First Floor Landing

Loft access, ceiling light point and doors to the following.

Bedroom One

12' 9" x 7' 11" (3.89m x 2.41m)

Double glazed window to front elevation and ceiling light point.

Bathroom

Modern white suite briefly comprising: bath with mixer taps and shower head over, wash hand basin vanity unit with WC, panels to walls, extractor fan, ceiling light point and airing cupboard housing the water tank and double glazed obscure window to front elevation.

Garden

The good size garden is mainly laid to lawn with fencing to the borders and a side gate giving access back to the front where the allocated parking is.





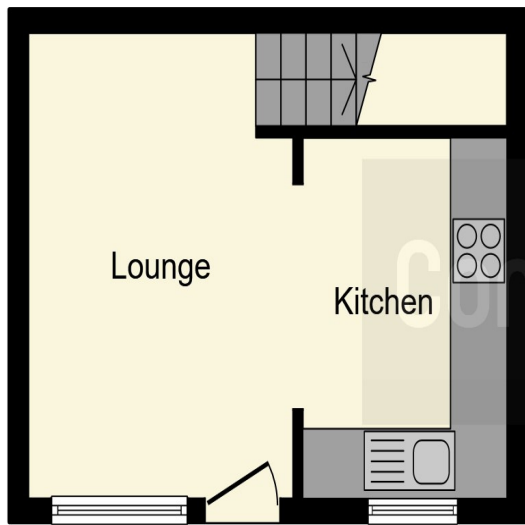

Ground Floor

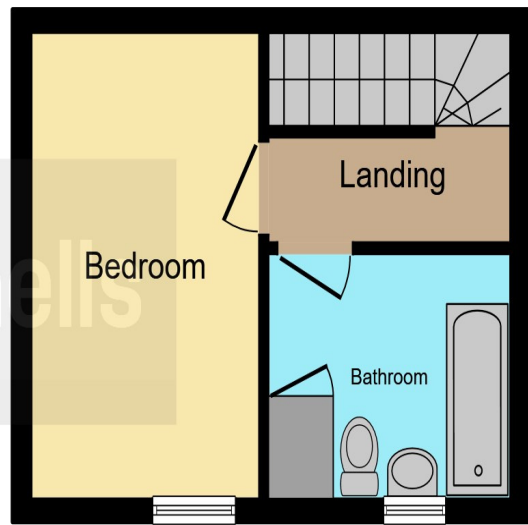

First Floor

This floor plan is for illustrative purposes only. It is not drawn to scale. Any measurements, floor areas (including any total floor area), openings and orientation are approximate. No details are guaranteed, they cannot be relied upon for any purpose and they do not form part of any agreement. No liability is taken for any error, omission or misstatement. A party must rely upon its own inspection(s). Powered by www.focalagent.com

To view this property please contact Connells on

T 01432 267 511
E hereford@connells.co.uk

23 King Street
 HEREFORD HR4 9BX

Property Ref: HER315747 - 0008

Tenure:Freehold EPC Rating: D

Council Tax Band: A

view this property online connells.co.uk/Property/HER315747



1. MONEY LAUNDERING REGULATIONS Intending purchasers will be asked to produce identification documentation at a later stage and we would ask for your co-operation in order that there will be no delay in agreeing the sale. 2. These particulars do not constitute part or all of an offer or contract. 3. The measurements indicated are supplied for guidance only and as such must be considered incorrect. Potential buyers are advised to recheck measurements before committing to any expense. 4. We have not tested any apparatus, equipment, fixtures, fittings or services and it is in the buyers interest to check the working condition of any appliances.

Connells Residential is registered in England and Wales under company number 1489613, Registered Office is Cumbria House, 16-20 Hockliffe Street, Leighton Buzzard, Bedfordshire, LU7 1GN. VAT Registration Number is 500 2481 05.

see all our properties at www.connells.co.uk | www.rightmove.co.uk | www.zoopla.co.uk