



2 Bedrooms

House

Located in London

£3,000 Per month



Hello@savipropertyconsulting.com

www.savipropertyconsulting.com

Hatherley Grove
Approx. Gross Internal Area 584 Sq Ft - 54.26 Sq M

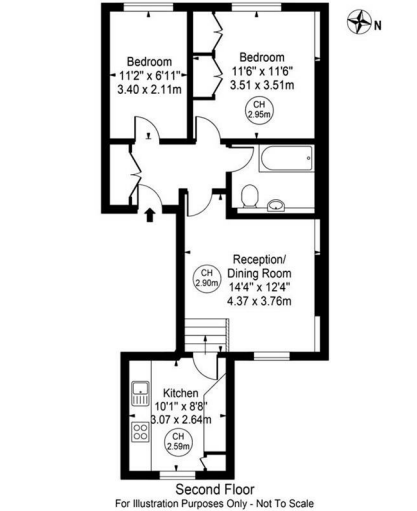

A beautifully modernised two-bedroom flat situated on the second floor of a well-maintained period building at Hatherley Grove, Westbourne Grove.

This bright and well-proportioned property offers a spacious reception room, a contemporary fitted kitchen with integrated appliances, two generous bedrooms, and a stylish modern shower room. The flat benefits from excellent natural light and a practical layout, making it ideal for professionals or sharers.

Ideally located just moments from the vibrant amenities of Westbourne Grove, with its array of boutique shops, cafés, and restaurants. The green open spaces of Hyde Park are within easy walking distance, perfect for leisure and outdoor activities. The property is also close to Whiteleys and the fashionable district of Notting Hill, offering excellent shopping, dining, and transport links.

An exceptional opportunity to rent a stylish home in one of W2's most desirable locations and tastefully furnished.

Energy Efficiency Rating: C

Agents Note: Whilst every care has been taken to prepare these particulars, they are for guidance purposes only. All measurements are approximate and are for general guidance purposes only and whilst every care has been taken to ensure their accuracy, they should not be relied upon and potential buyers/tenants are advised to recheck the measurements.



24 Notting Hill Gate

London

W11 3LB

Hello@savipropertyconsulting.com

www.savipropertyconsulting.com