



Heol Gabriel, £480,000

- Detached
- Five Bedrooms
- Garage
- Garden
- Driveway
- Spacious Throughout
- Great Location
- EPC Rating: D



 5  2  3



About the property

Spacious Five-Bedroom Detached Bungalow in a prime location in Whitchurch. Situated on Heol Gabriel in the heart of Whitchurch, this substantial five-bedroom detached bungalow offers generous and flexible living accommodation, presenting an excellent opportunity for those seeking a home with scope to modernise and add value.

The property provides well-proportioned space throughout, including two reception rooms ideal for both relaxing and entertaining, along with two bathrooms to comfortably serve family living. An extended garage further enhances the practicality of the home, offering additional storage or potential workshop space.

While the property would benefit from some updating, it boasts tremendous potential to be transformed into a stunning family home tailored to individual tastes.

Ideally positioned, the property enjoys convenient access to a wide range of local amenities, reputable schools, and excellent transport links, making it perfectly suited for families and commuters alike.

Ground Floor



First Floor

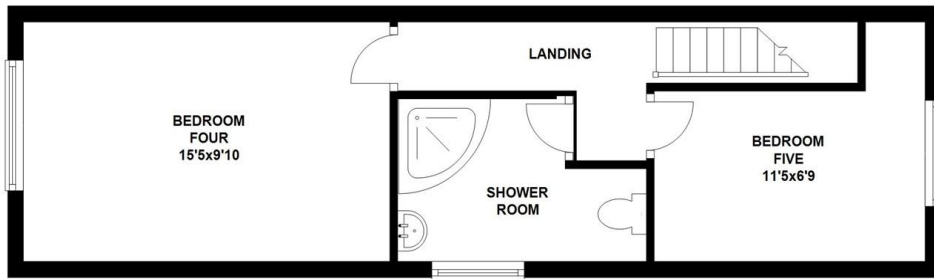

Accommodation

02920 612328

whitchurch@peteralan.co.uk

Floorplan



Important Information

Note while we endeavour to make our sales details accurate and reliable, if there is any point which is of particular interest to you, please contact the office and we will be pleased to confirm the position for you. We have not personally tested any apparatus, equipment, fixtures, fittings or services and cannot verify they are in working order or fit for their purposes. Nothing in these particulars is intended to indicate that carpets or curtains, furnishings or fittings, electrical goods (whether wired or not). Gas fires or light fittings or any other fixtures not expressly included form part of the property offered for sale. This computer generated Floorplan, if applicable, is intended as a general guide to the layout and design of the property. It is not to scale and should not be relied upon for dimensions. Tenure: We cannot confirm the tenure of the property as we have not had access to the legal documents. The buyer is advised to obtain verification from their solicitor or surveyor.

Peter Alan Limited is registered in England and Wales under company number 2073153, Registered Office is Cumbria House, 16-20 Hockliffe Street, Leighton Buzzard, Bedfordshire, LU7 1GN. VAT Registration Number is 500 2481 05. For activities relating to regulated mortgages and non-investment insurance contracts, Peter Alan Limited is an appointed representative of Connells Limited which is authorised and regulated by the Financial Conduct Authority. Connells Limited's Financial Services Register number is 302221. Most buy-to-let

